

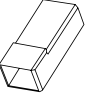

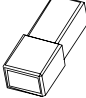









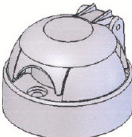
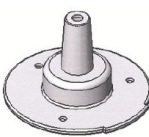

Kia Optima 2012-

7-pol

Nr: 35177

| | | | | | | | | | |
|--|--|---|--|--|--|---|--|---|---|
| 2x  Art.no. 3716 | 1x  Art.no. 3717 | 1x  Art.no. 3515 | 1x  Art.no. 3516 | 1x  M6 Art.no. 1072 | 1x  M6 Art.no. 1059 | 1x  M6 Art.no. 1092 | 50cm  Art.no. 3584 | 6x L=140  Art.no. 6079 | 6x L=186  Art.no. 6081 |
| 1x  Art.no.10000 | 1x  Art.no.4093 | 3x  M5 x 35 Art.no. 1031 | 3x  Art.no. 1091 | 3x  M5 Art.no. 1071 | 1x  Art.no. 3500-0050 | 5cm  Art.no. 3530 | 5cm  Art.no. 3531 | 1x  Art.no. 9700-0006 | |

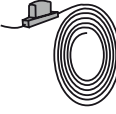
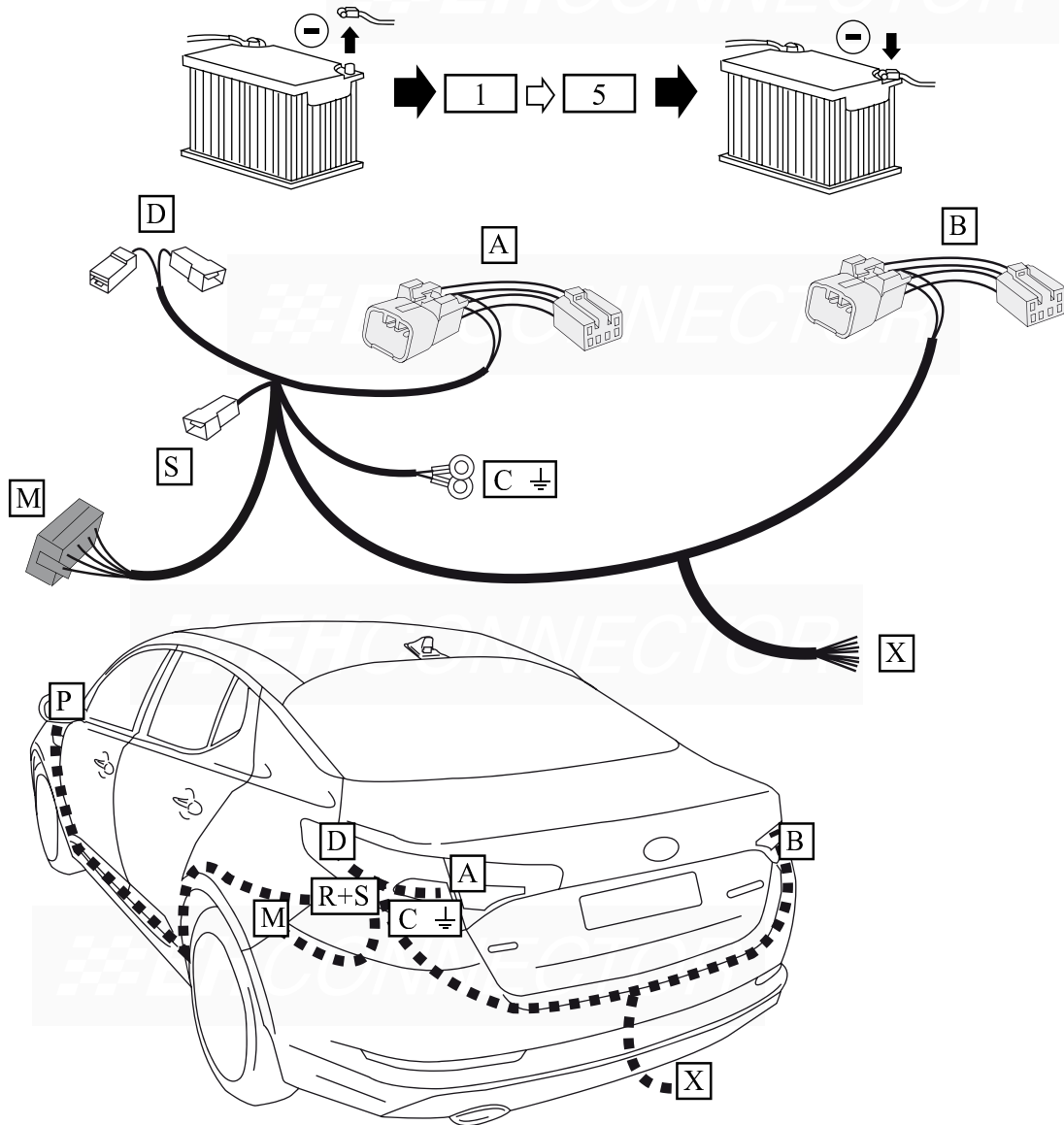

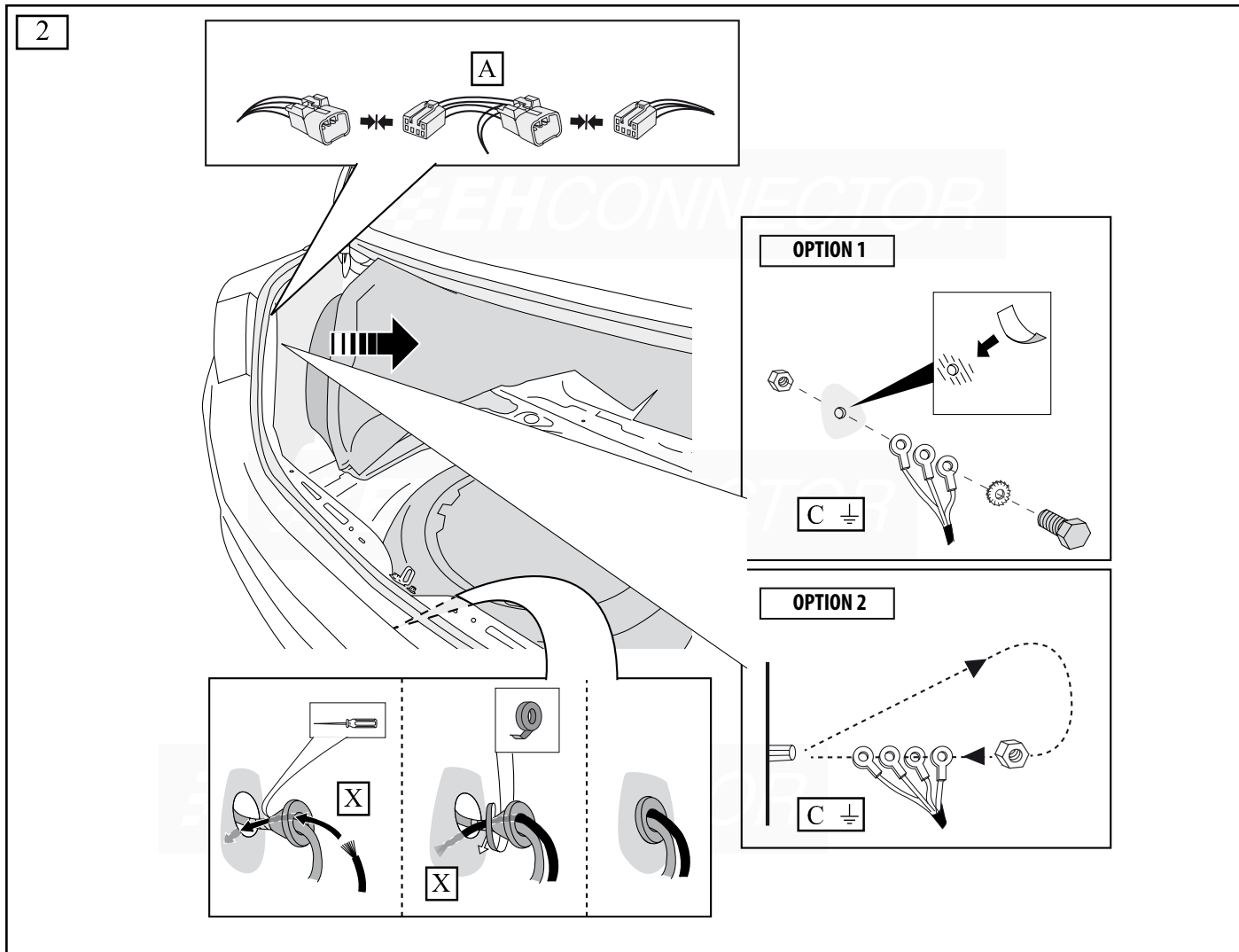
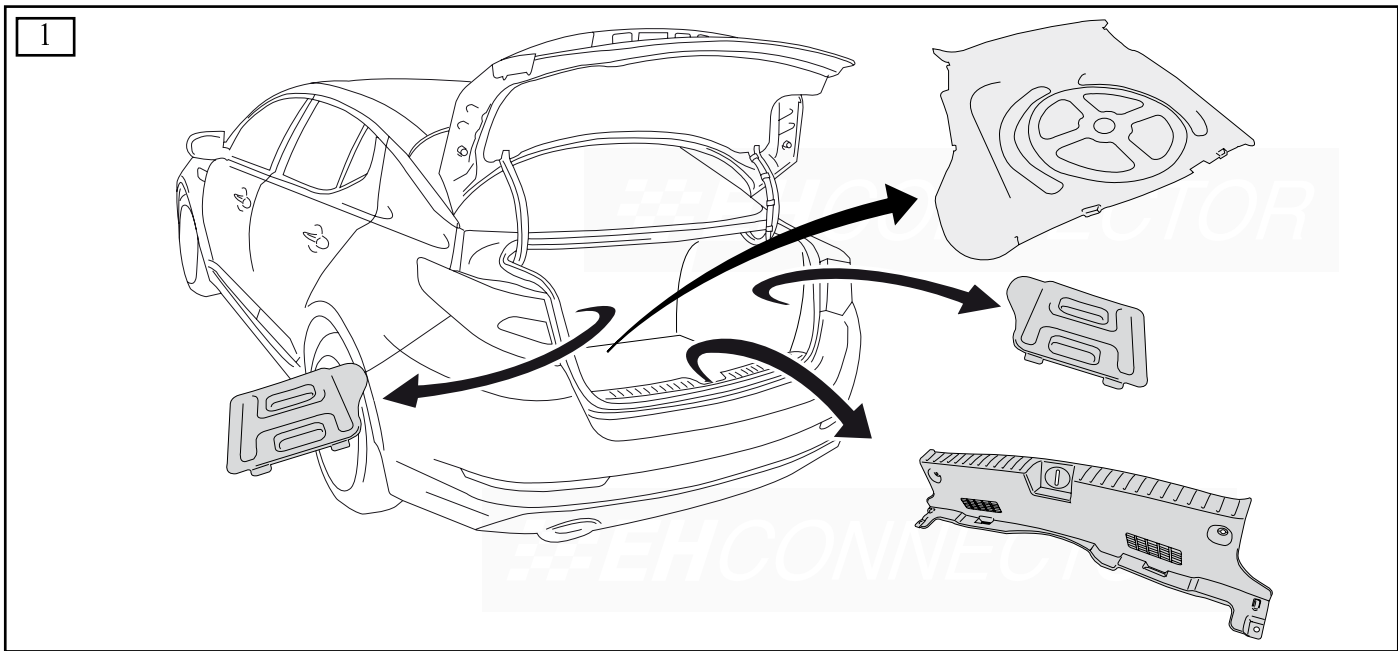

3

**OPTION 1
FACELIFT MODELS 2016-**

 red/yellow
 rød/gul
 rød/gul
 punainen/ keltainen
 czerwony/żółty

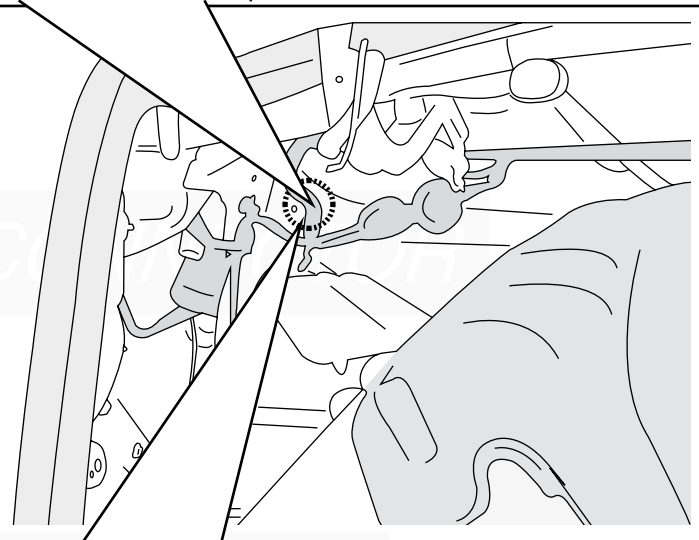
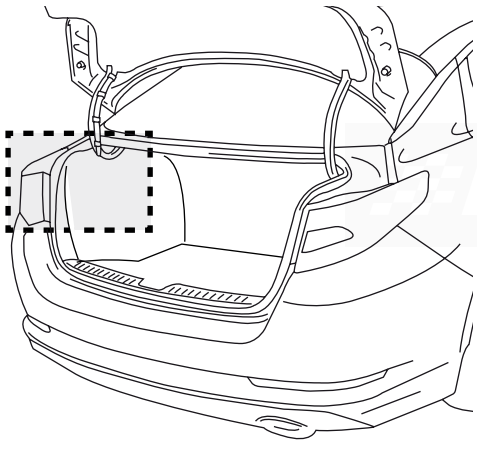
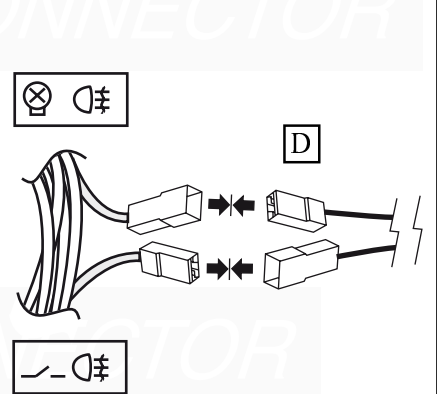
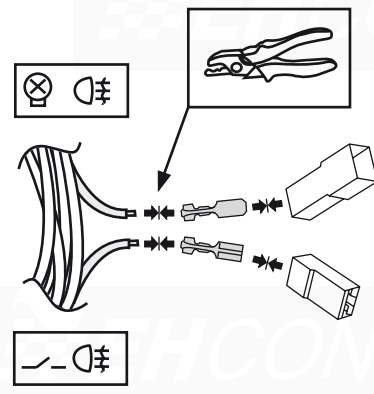
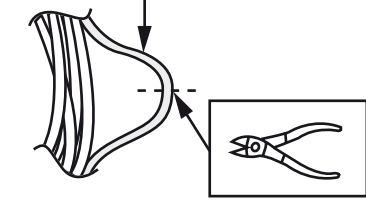

**OPTION 2
BEFORE FACELIFT MODELS 2016-**

 yellow
 gul
 keltainen
 żółty

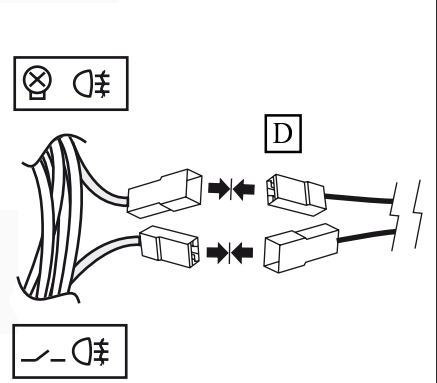
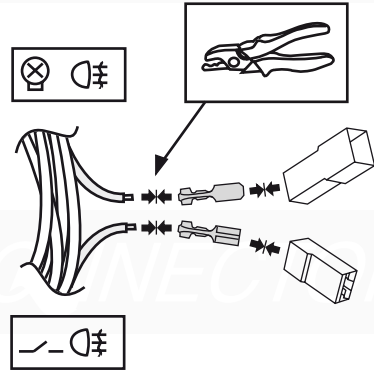
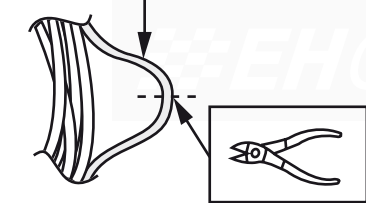

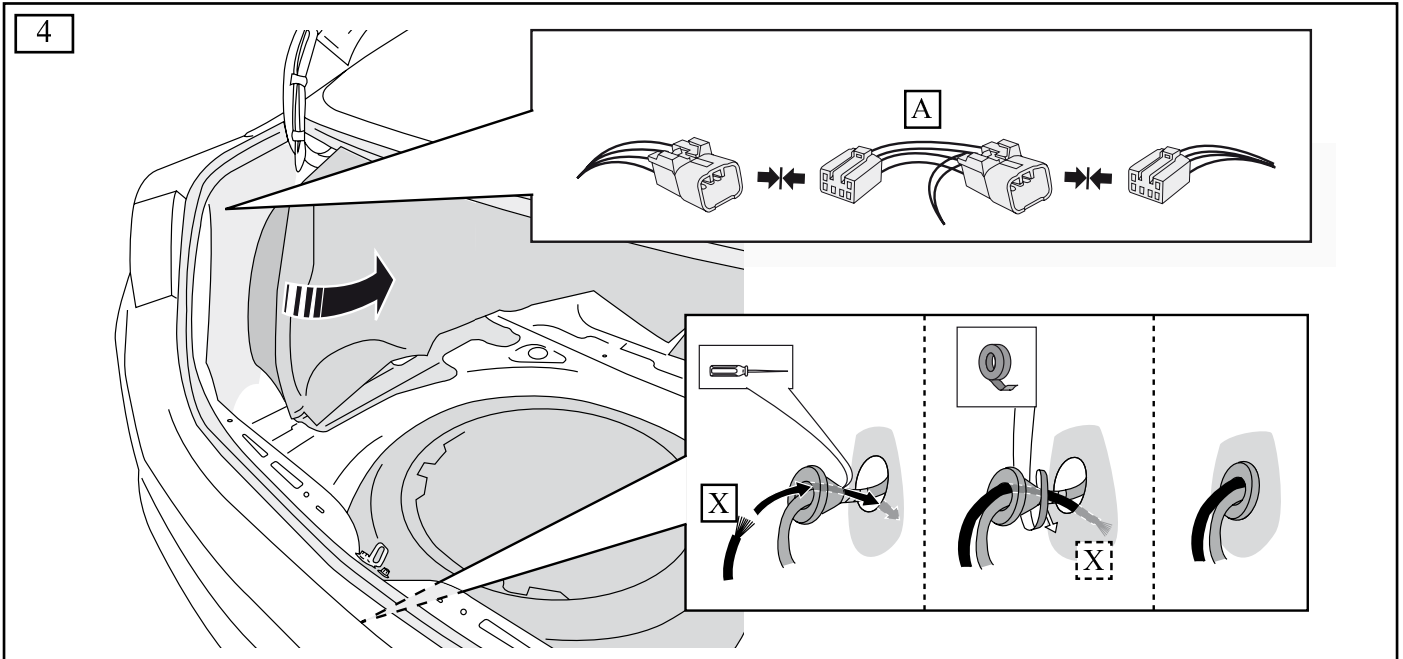
5

| P-MAX | | GB | S | N | DK | FIN | POL | |
|-------|---|-------|--------|-------|-------|------|-----------|-----------|
| 21W | ↶ | 1/L | yellow | gul | gul | gul | keltainen | żółty |
| 2x21W | ⊕ | 2/54g | blue | blå | blå | blå | sininen | niebieski |
| | ⊖ | 3/31 | white | vit | hvit | hvid | valkoinen | biały |
| 21W | ↷ | 4/R | green | grön | grønn | grøn | vihreä | zielony |
| 21W | ⊕ | 5/58R | brown | brun | brun | brun | ruskea | brązowy |
| 2x21W | ⊘ | 6/54 | red | röd | rød | rød | punainen | czerwony |
| 21W | ⊖ | 7/58L | black | svart | sort | sort | musta | czarny |
| | ⊕ | 8/58b | grey | grå | grå | grå | harmaa | szary |

INFO

For OE-installed
PDC

