

Kit 1588

HONDA Accord Crosstour, 5-dr Hatchback, *10-

*North America

480R
754

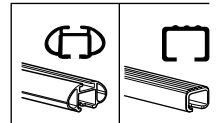
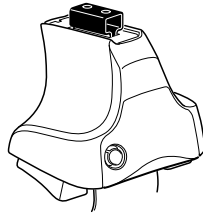

480

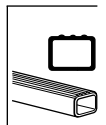
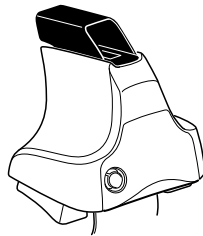

xx kg
xx lbs

7 kg
15,4 lbs

Max.
50 kg

Max.
110 lbs

!

80 km/h
50 Mph

130 km/h
80 Mph

40 km/h
25 Mph

km/h
Mph

THULE

Kit XXXX

instructions

THULE

!

x1

x4

x4

x4

480R/754

x1

x4

x4

x4

480

x2

x2

23 mm

x2

x2

17 mm

x2

23 mm

x2

x2

x2

x4

x4

x2

x4

x2

544

x2

679

x2

06

x4

RR

FR

FL

RL

x1

Kit

1

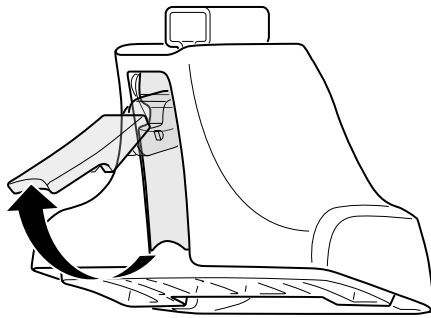
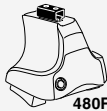

2

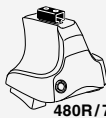

+

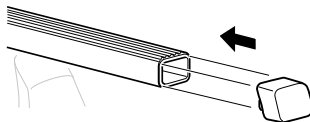
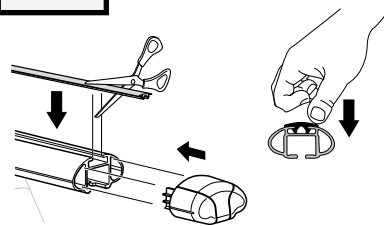
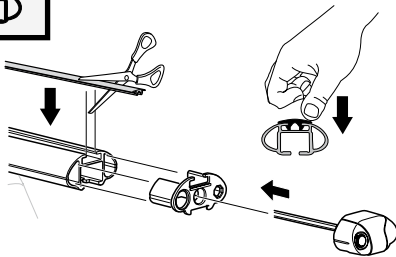
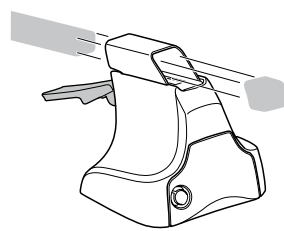
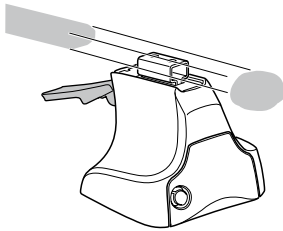

3

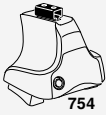

754

1

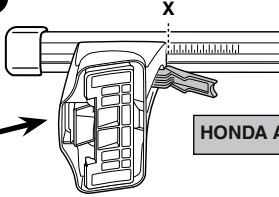
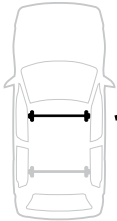

2

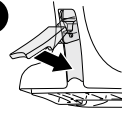

HONDA Accord Crosstour, 5-dr Hatchback, *10-

X

38,5

1

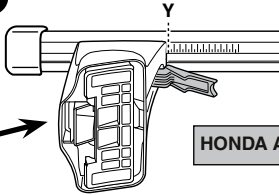
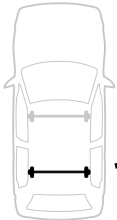

2

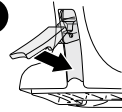

HONDA Accord Crosstour, 5-dr Hatchback, *10-

Y

35,5

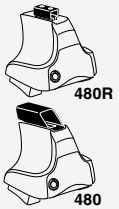

480R

480

1

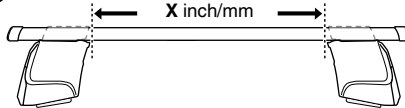

2

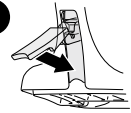

X inch

X mm

HONDA Accord Crosstour, 5-dr Hatchback, *10-

40 ³/₄"

1036 mm

1

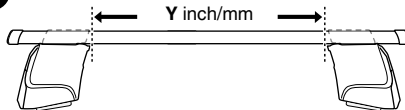

2

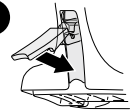

Y inch

Y mm

HONDA Accord Crosstour, 5-dr Hatchback, *10-

39 ⁵/₈"

1006 mm

4



480R/754



480

HONDA Accord Crosstour, 5-dr Hatchback, *10-

06



679

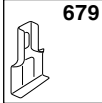

06



679

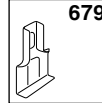

06



544

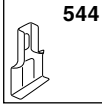

06



544

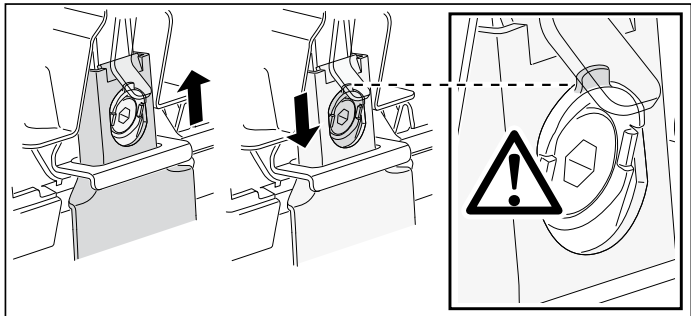
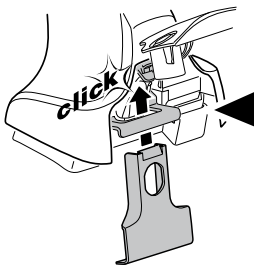
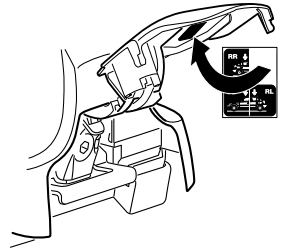
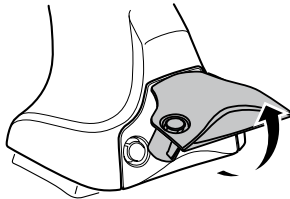
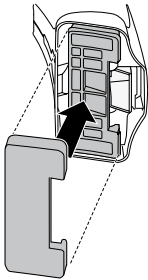
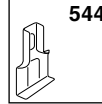

5



	X mm	Y mm	X inch	Y inch
HONDA Accord Crosstour, 5-dr Hatchback, *10-	280 mm	660 mm	11"	26"

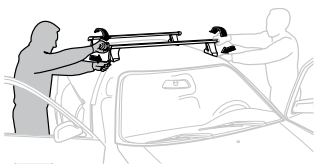
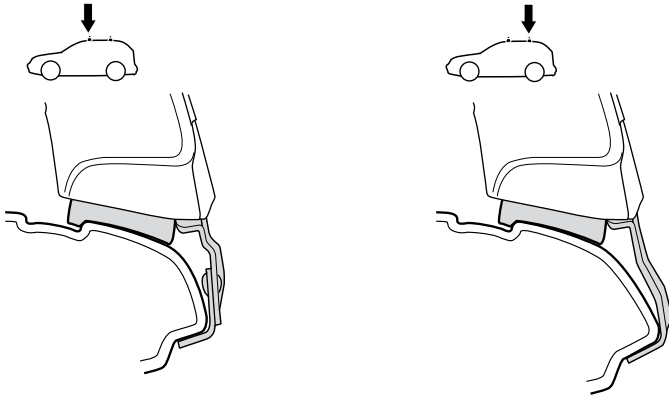
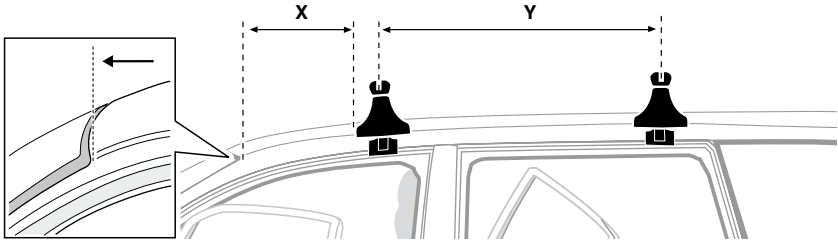

- | | | | |
|--------------|---|------------|---|
| GB/US | Tighten alternately | CZ | Pokřetla bagázníka dokřečaj dokřečaj napřezemennie. |
| D | Die Schrauben abwechselnd anziehen | SK | Dotahujte striedavo |
| F | Serrer alternativement chaque côté | SLO | Privijajte izmenično. |
| NL | Afwisselend aan de linker- en de rechterkant aandraaien | HR | Naizmjenično zategnite |
| I | Alternare il serraggio delle viti | HU | Egymástól függetlenül szorítandó |
| E | Apretar alternativamente | GR | Σφιγγετε εναλλάξ |
| PT | Aperte alternadamente | TR | Dönüşümlü sıkın |
| S | Dra åt växelvis | 中文 | 交替拧紧 |
| FIN | Kierrä vuorotellen | 한국어 | 번갈아 가며 조이십시오. |
| EST | Pinguldage vaheldumisi | 日本語 | 交互に締め付けてください。 |
| LAT | Pievēlciēt pamišus | ไทย | ขันในแบบสลับ |
| LIT | Užsukinėkite pakaitomis | | |
| PL | Śruby dokręcaj naprzemiennie | | |
| RU | Затягивайте попеременно | | |

6

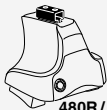

480R/754



480

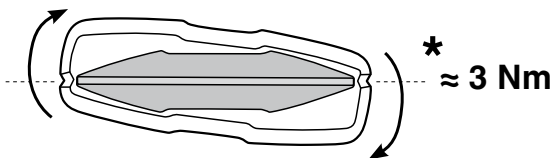
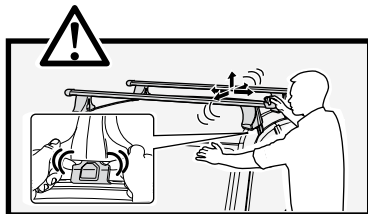
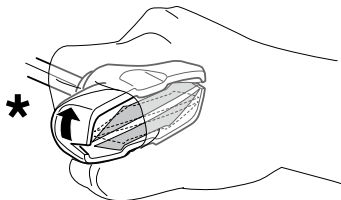
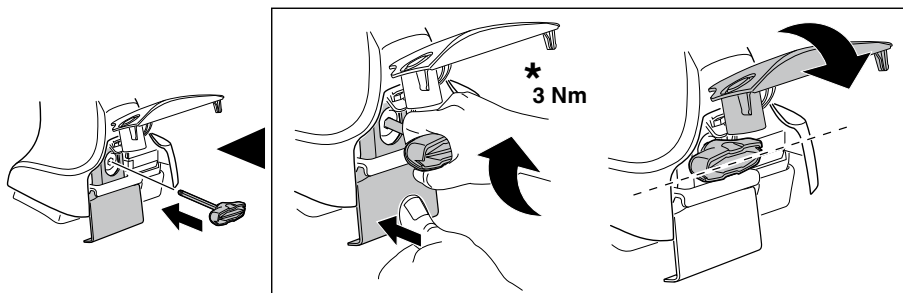

7

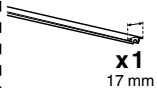

x1
17 mm

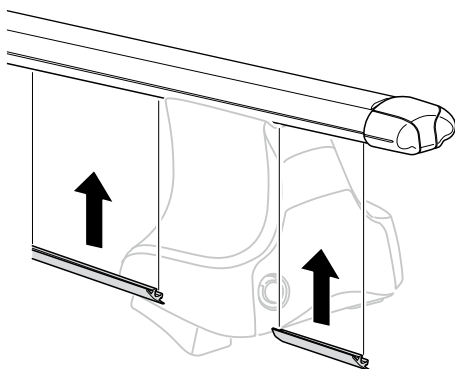

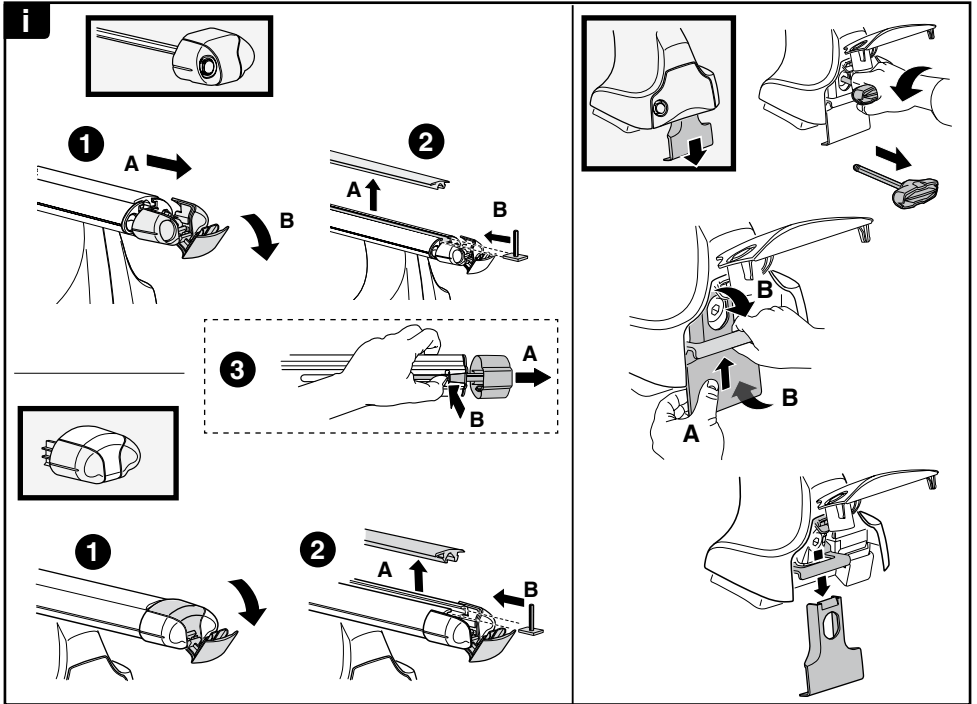
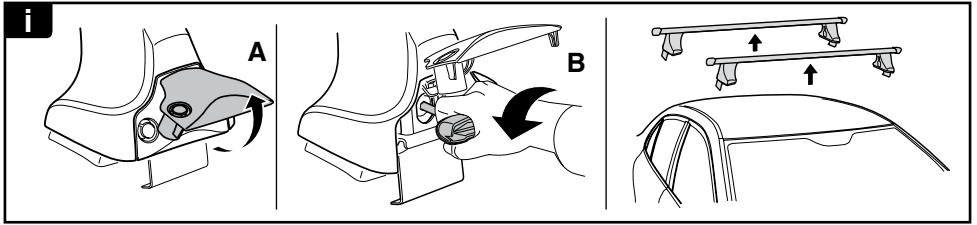

THULE
SWEDEN

**ONE
KEY
SYSTEM**

544 (x4)

596 (x6)

588 (x8)

NA **510** (x10)

EUR **452** (x12)

ASIA

WW ▶ Thule Sweden AB, Box 69, 330 33 Hillerstorp, SWEDEN
 NA ▶ Thule Inc., 42 Silvermine Road, Seymour, Connecticut 06483, USA

info@thule.com
 customer.service@thule.com

www.thule.com