

Kit 1234

PROTON Waja, 4-dr Sedan, 01-
PROTON Impian, 4-dr Sedan, 01-

480R
754

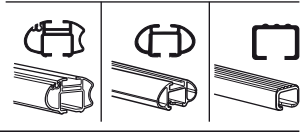
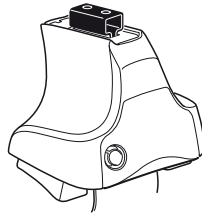

480

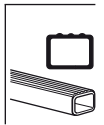
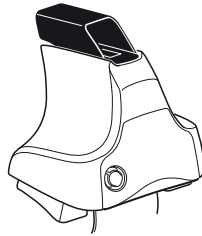

750

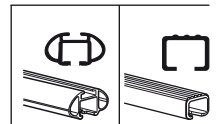
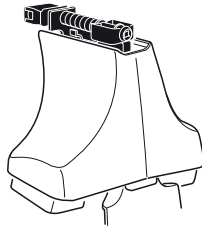

x2 x2 x2 x4	x2	x2 x2 x4 x4	x2 x2	x2	x2

73 x 4

04 x 4

x 1

Kit



3

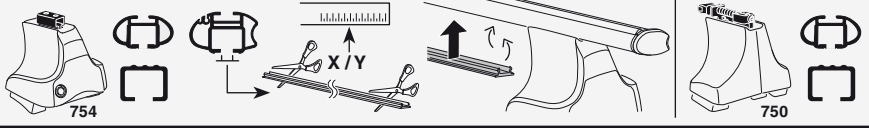

1

2

	X
PROTON Waja, 4-dr Sedan, 01-	28,5
PROTON Impian, 4-dr Sedan, 01-	28,5

1

2

	Y
PROTON Waja, 4-dr Sedan, 01-	30
PROTON Impian, 4-dr Sedan, 01-	30

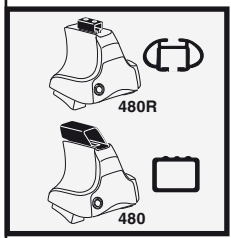

1

2

	X inch	X mm
PROTON Waja, 4-dr Sedan, 01-	36 ⁷ / ₈ "	936 mm
PROTON Impian, 4-dr Sedan, 01-	36 ⁷ / ₈ "	936 mm

1

2

	Y inch	Y mm
PROTON Waja, 4-dr Sedan, 01-	37 ¹ / ₂ "	951 mm
PROTON Impian, 4-dr Sedan, 01-	37 ¹ / ₂ "	951 mm

4

PROTON Waja, 4-dr Sedan, 01-
PROTON Impian, 4-dr Sedan, 01-

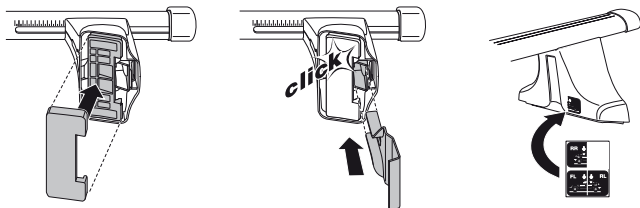
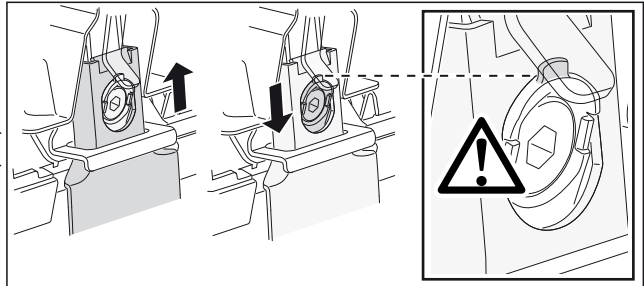
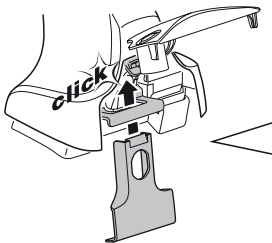
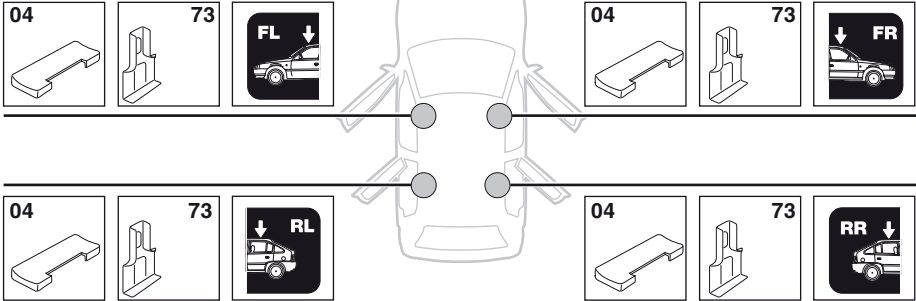

5



	X mm	Y mm	X inch	Y inch
PROTON Waja , 4-dr Sedan, 01-	310 mm	700 mm	12 1/4"	27 1/2"
PROTON Impian , 4-dr Sedan, 01-	310 mm	700 mm	12 1/4"	27 1/2"

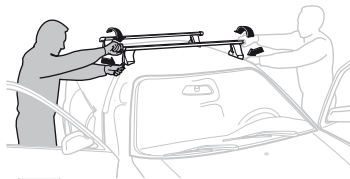
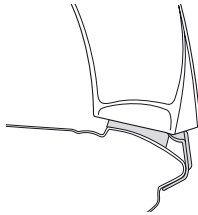
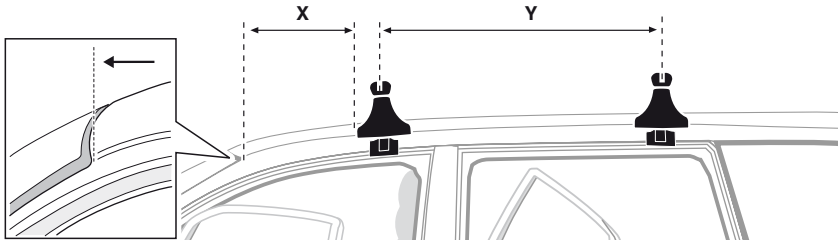

GB/US Tighten alternately

D Die Schrauben abwechselnd anziehen

F Serrer alternativement chaque côté

NL Afwisselend aan de linker- en de rechterkant aandraaien

I Alternare il serraggio delle viti

E Apretar alternativamente

PT Aperte alternadamente

S Dra åt växelvis

FIN Kierrä vuorotellen

EST Pinguldage vaheldumisi

LAT Pielvelciet pamišus

LIT Užsukinėkite pakaitomis

PL Śruby dokręcaj naprzemiennie

RU Затягивайте попеременно

CZ Pokręťta bagażníka dokręcaj dokręcaj naprzemiennie.

SK Doťahujte striedavo

SLO Privijajte izmenično.

HR Naizmjenično zategnite

HU Egymástól függetlenül szorítandó

GR Σφίγγετε εναλλάξ

TR Dönüşümlü sıkın

中文 交替拧紧

한국어 번갈아 가며 조이십시오.

日本語 交互に締め付けてください。

ไทย ชั้้นโน้แบบสลับ

6



480R/754



480

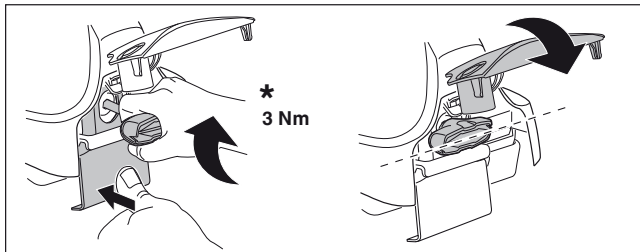
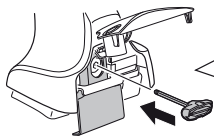

*
3 Nm

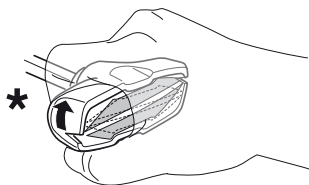

*

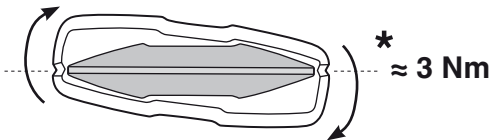

*
≈ 3 Nm

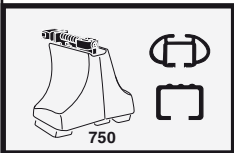
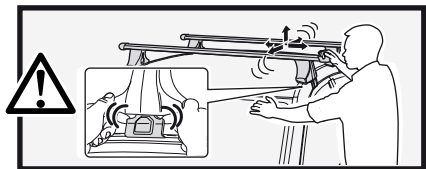

750

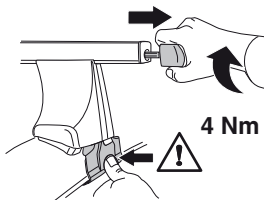

4 Nm

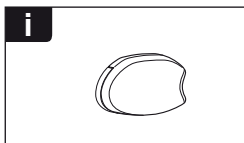
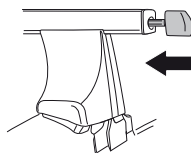

i

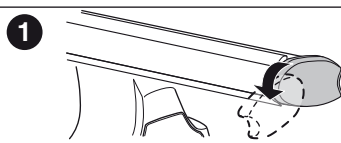

1

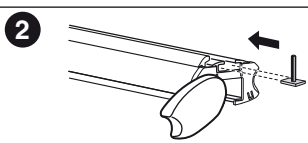

2

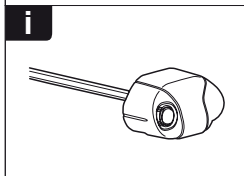

i

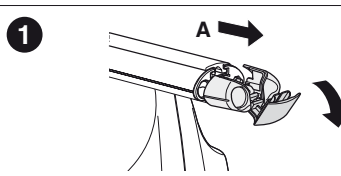

1

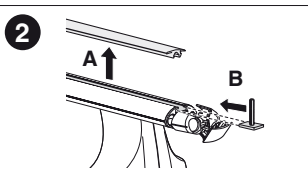

2

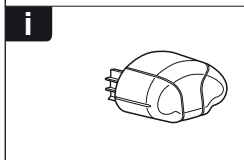

i

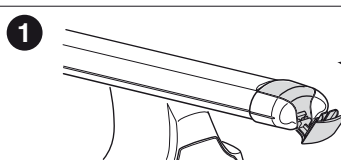

1

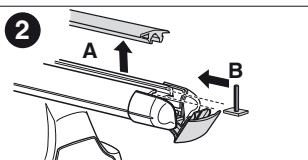

2

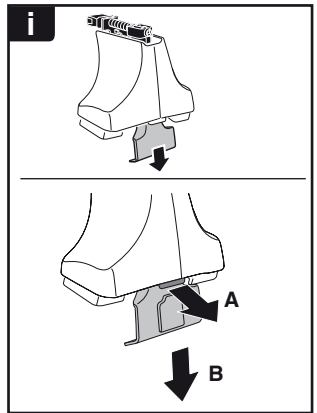

THULE
SWEDEN
**ONE
KEY
SYSTEM**



- 544 (x4)
- 596 (x6)
- 588 (x8)
- NA 510 (x10)
- EUR 452 (x12)
- ASIA



WW ▶ Thule Sweden AB, Box 69, 330 33 Hillerstorp, SWEDEN
NA ▶ Thule Inc., 42 Silvermine Road, Seymour, Connecticut 06483, USA

info@thule.com
customer.service@thule.com

www.thule.com