

Kit 1006

MAZDA 323, 3-dr Hatchback, 90-94

MAZDA 323, 4-dr Sedan, 90-94

480R
754

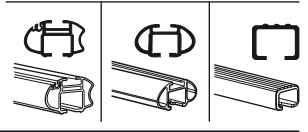
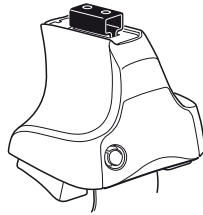

480

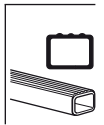
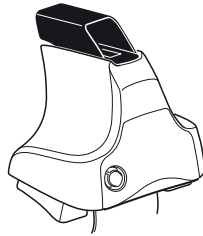

750

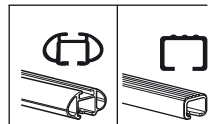
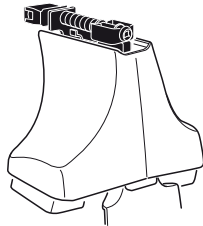



3



754

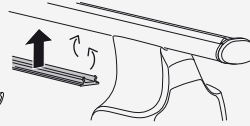
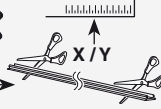

750



1

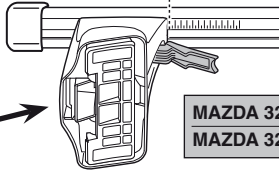
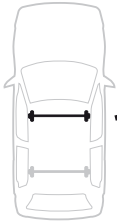

2

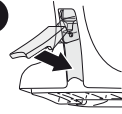

MAZDA 323, 3-dr Hatchback, 90-94

MAZDA 323, 4-dr Sedan, 90-94

X

28

30

1

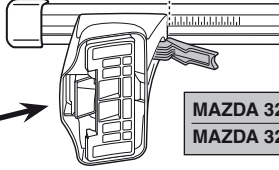

2

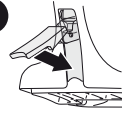

MAZDA 323, 3-dr Hatchback, 90-94

MAZDA 323, 4-dr Sedan, 90-94

Y

24

28,5



480R



480

1

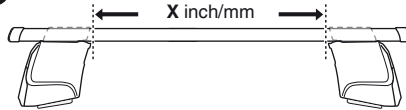

2

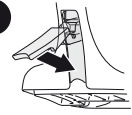

X inch

X mm

MAZDA 323, 3-dr Hatchback, 90-94

MAZDA 323, 4-dr Sedan, 90-94

36 5/8"

931 mm

37 1/2"

951 mm

1

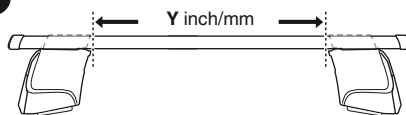

2

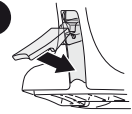

Y inch

Y mm

MAZDA 323, 3-dr Hatchback, 90-94

MAZDA 323, 4-dr Sedan, 90-94

35 1/8"

891 mm

36 7/8"

936 mm

4

MAZDA 323, 3-dr Hatchback, 90-94

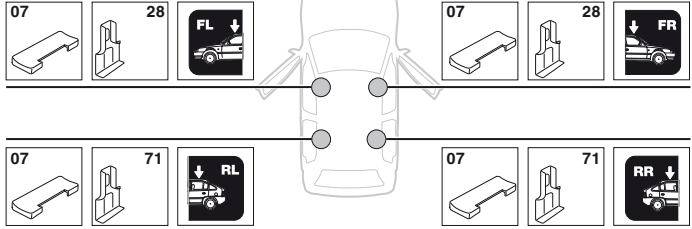

MAZDA 323, 4-dr Sedan, 90-94

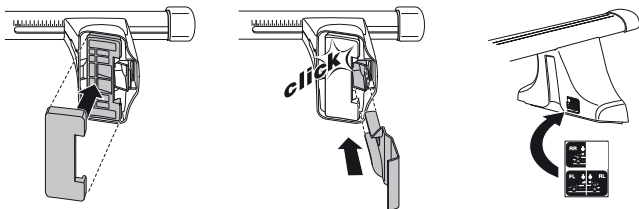
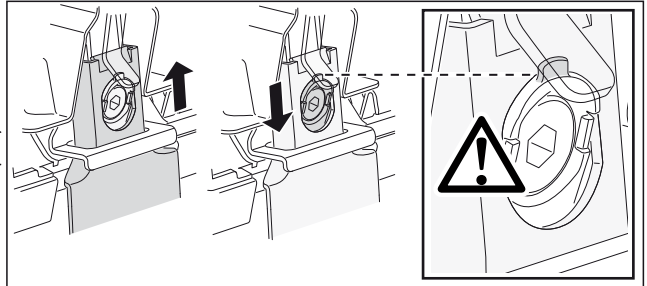
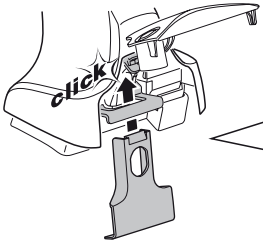
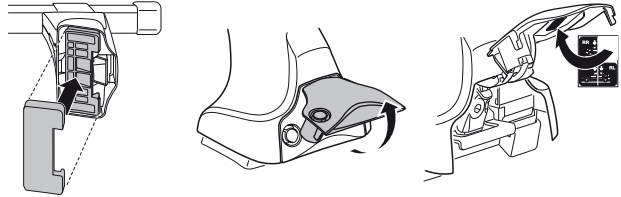
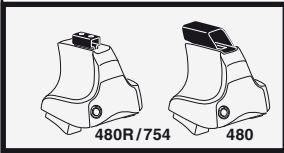
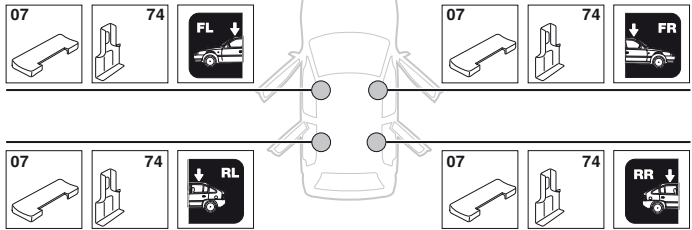

5



	X mm	Y mm	X inch	Y inch
MAZDA 323, 3-dr Hatchback, 90-94	250 mm	700 mm	9 7/8"	27 1/2"
MAZDA 323, 4-dr Sedan, 90-94	190 mm	700 mm	7 1/2"	27 1/2"

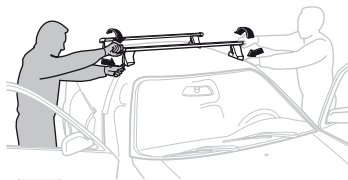
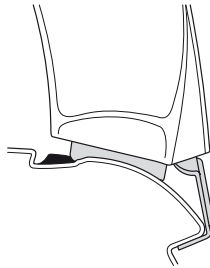
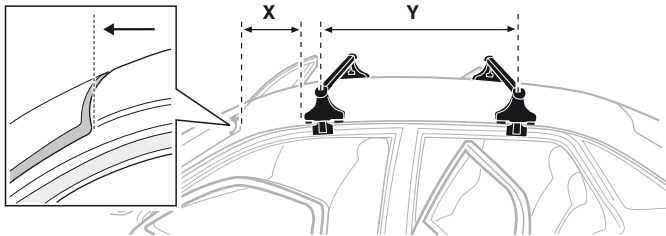

GB/US Tighten alternately

D Die Schrauben abwechselnd anziehen

F Serrer alternativement chaque côté

NL Afwisselend aan de linker- en de rechterkant aandraaien

I Alternare il serraggio delle viti

E Apretar alternativamente

PT Aperte alternadamente

S Dra åt växelvís

FIN Kierrä vuorotellen

EST Pinguldage vaheldumisi

LAT Pielvelciet pamīšus

LIT Užsukinėkite pakaitomis

PL Śruby dokręcaj naprzemiennie

RU Затягивайте попеременно

CZ Pokręťta bagażníka dokręcaj dokręcaj naprzemiennie.

SK Doťahujte striedavo

SLO Privijajte izmenično.

HR Naizmjenično zategnite

HU Egymástól függetlenül szorítandó

GR Σφίγγετε εναλλάξ

TR Dönüşümlü sıkın

中文 交替拧紧

한국어 번갈아 가며 조이십시오.

日本語 交互に締め付けてください。

ไทย ชั้้นโน้บแบบสลับ

6



480R/754



480

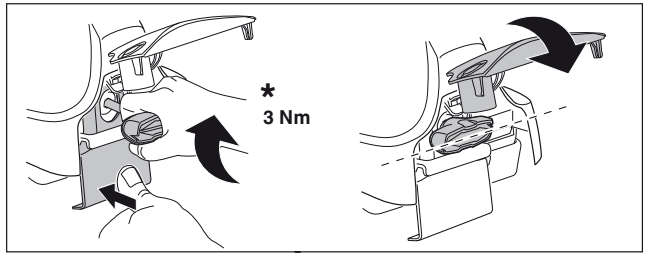
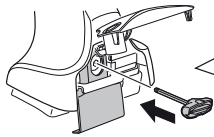

*
3 Nm



*

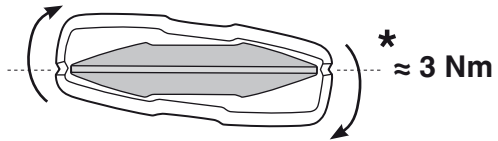

*
≈ 3 Nm

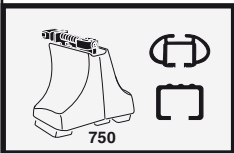
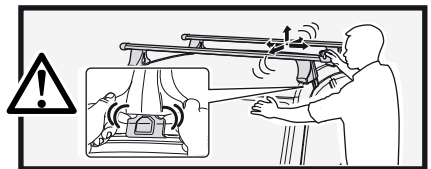

750

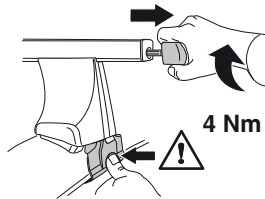

4 Nm

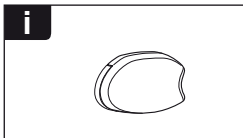
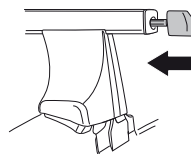

i

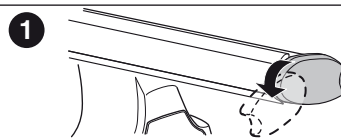

1

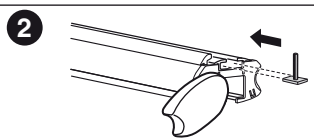

2

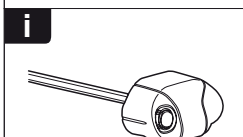

i

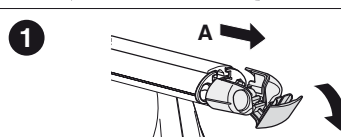

1

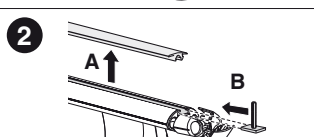

2

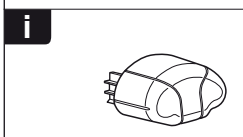

i

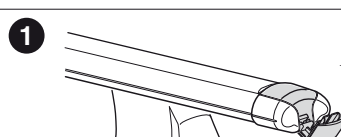

1

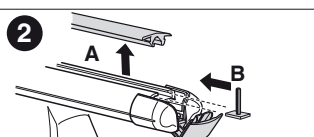

2

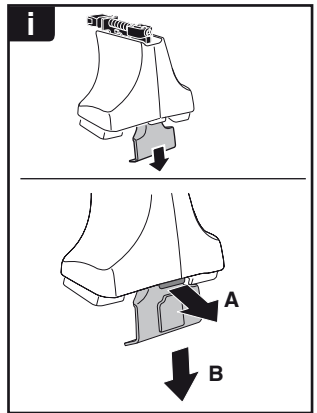
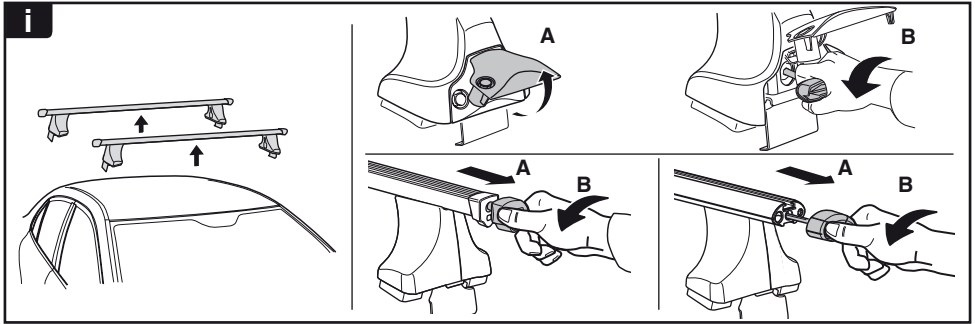

THULE
SWEDEN
**ONE
KEY
SYSTEM**



- 544 (x4)
- 596 (x6)
- 588 (x8)
- NA 510 (x10)
- EUR 452 (x12)
- ASIA



WW ▶ Thule Sweden AB, Box 69, 330 33 Hillerstorp, SWEDEN
NA ▶ Thule Inc., 42 Silvermine Road, Seymour, Connecticut 06483, USA

info@thule.com
customer.service@thule.com

www.thule.com