

Fitting instructions

Make: Citroën

C3 Picasso; 2009->

Type: 5212

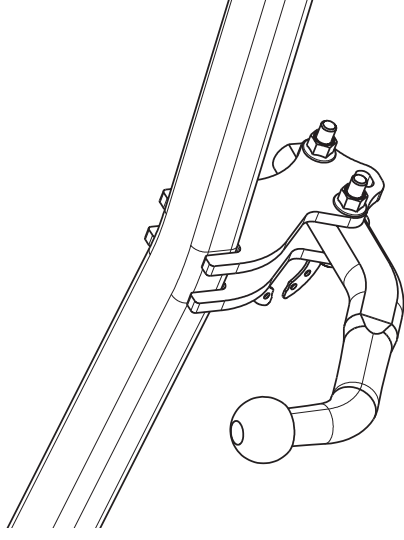
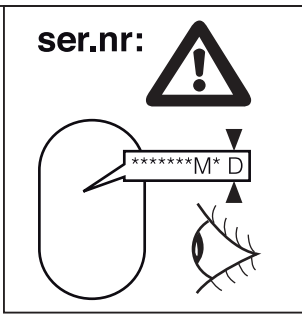
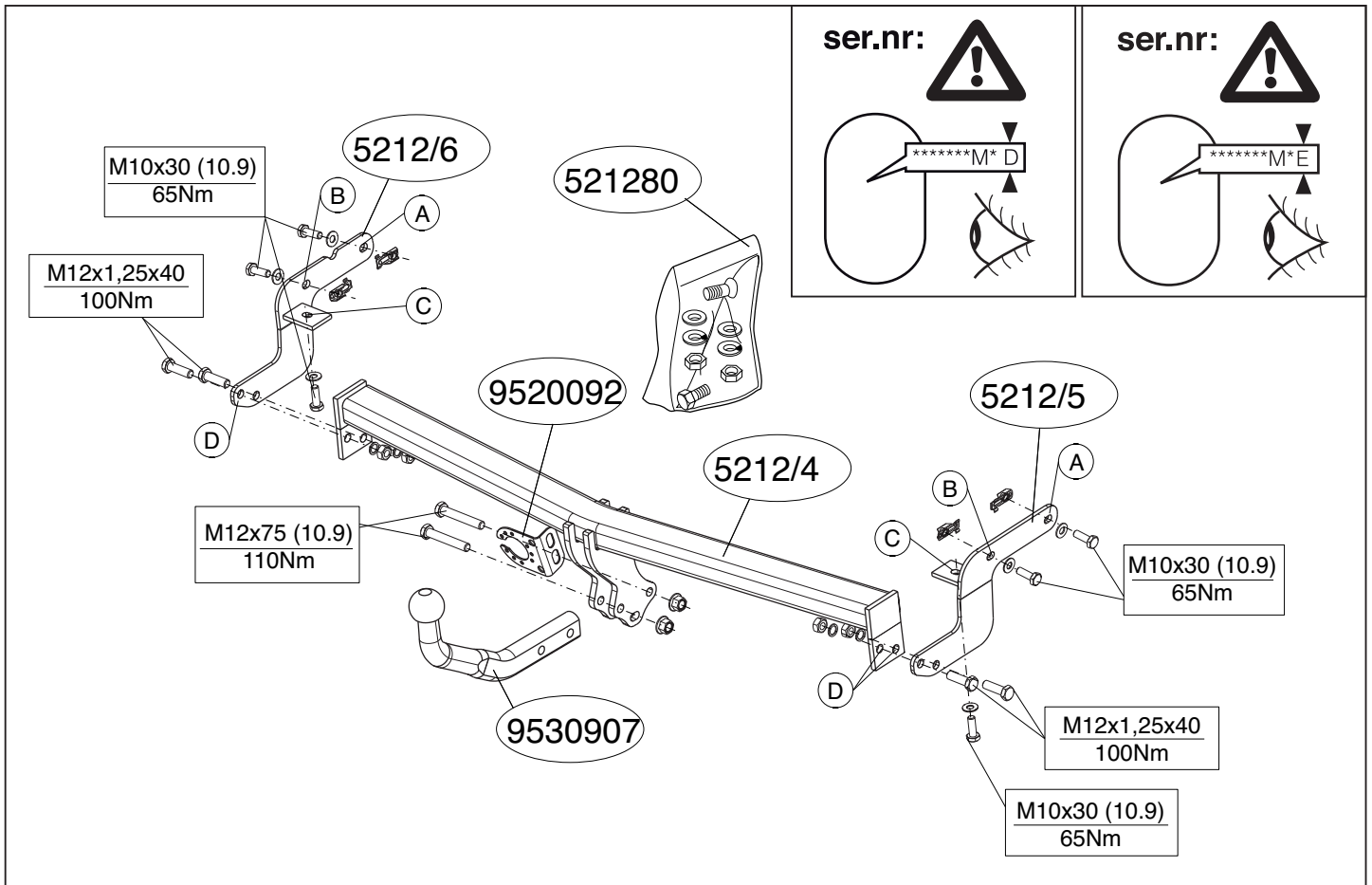



© 521270/25-08-2009/1

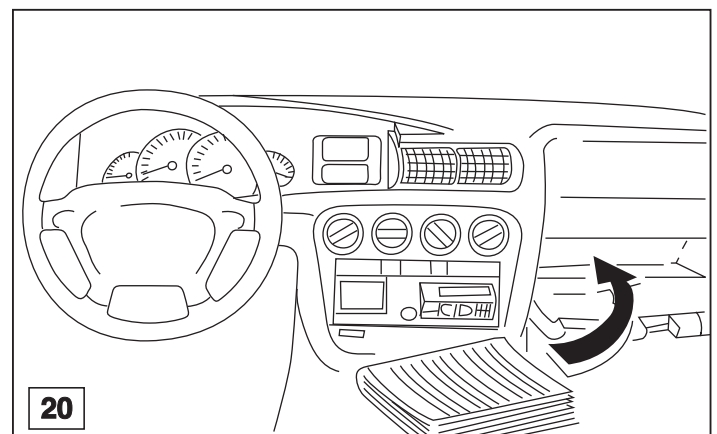
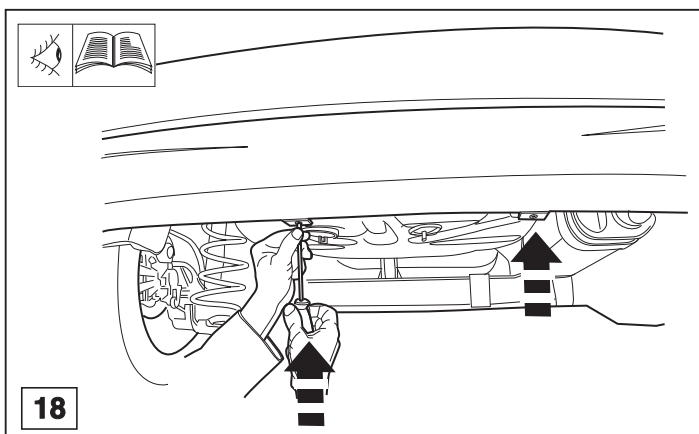
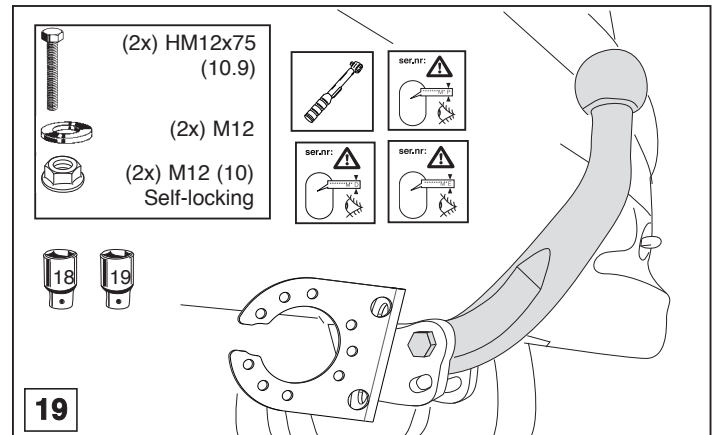
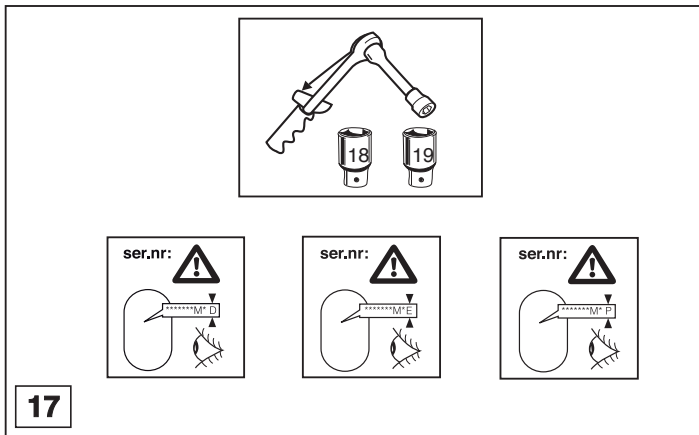

© 521270/25-08-2009/10

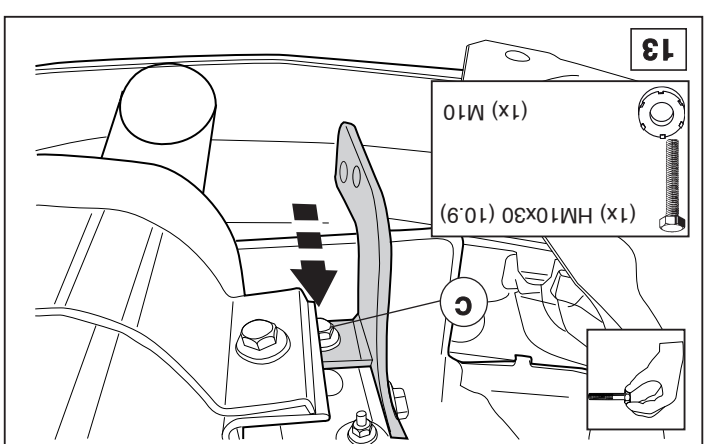
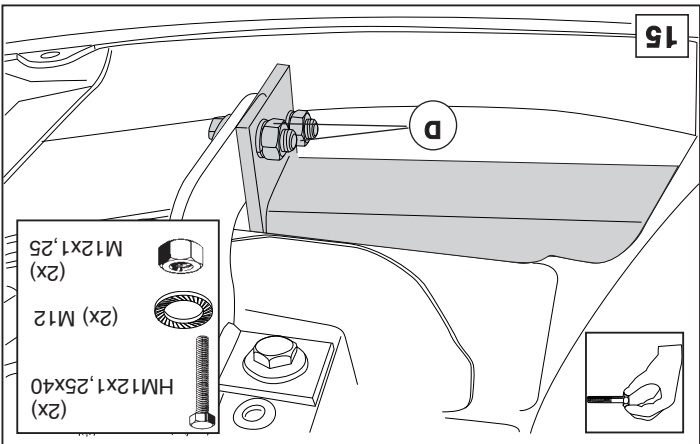
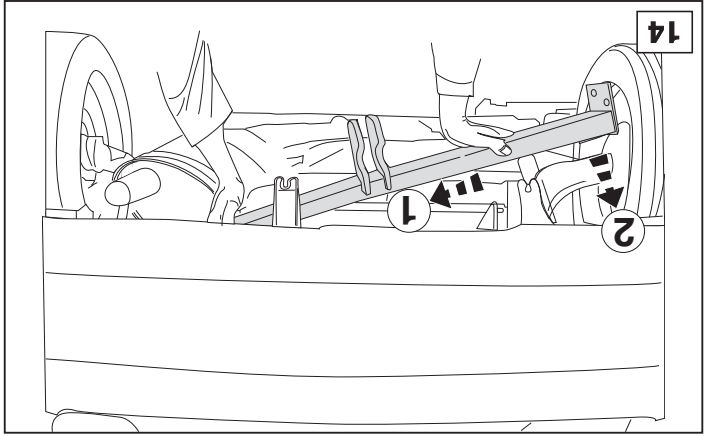
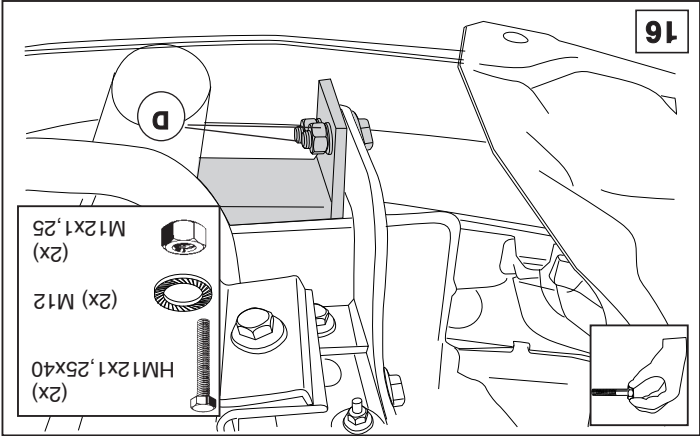
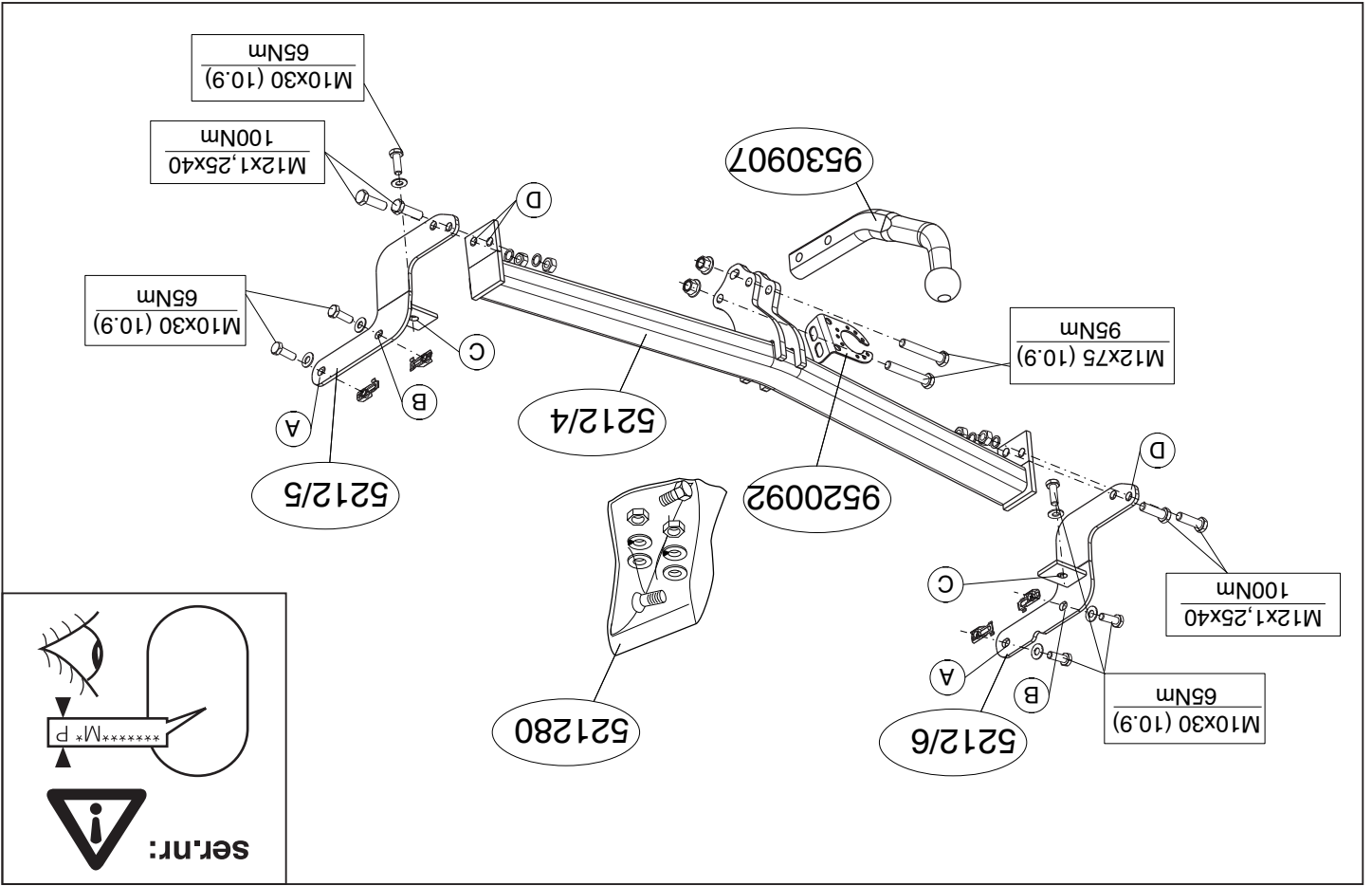

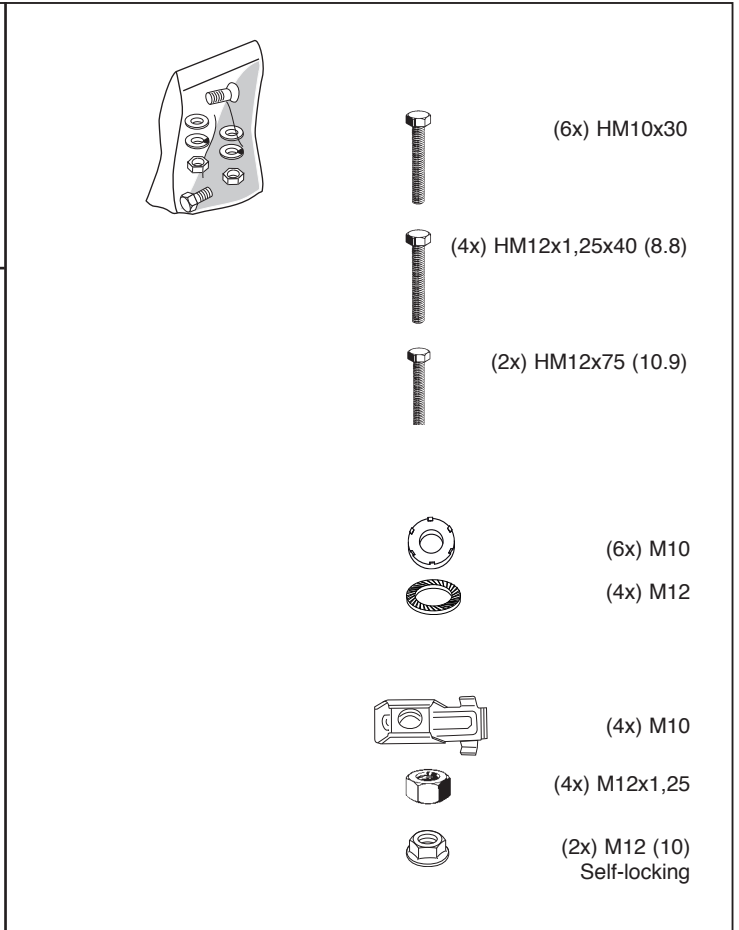
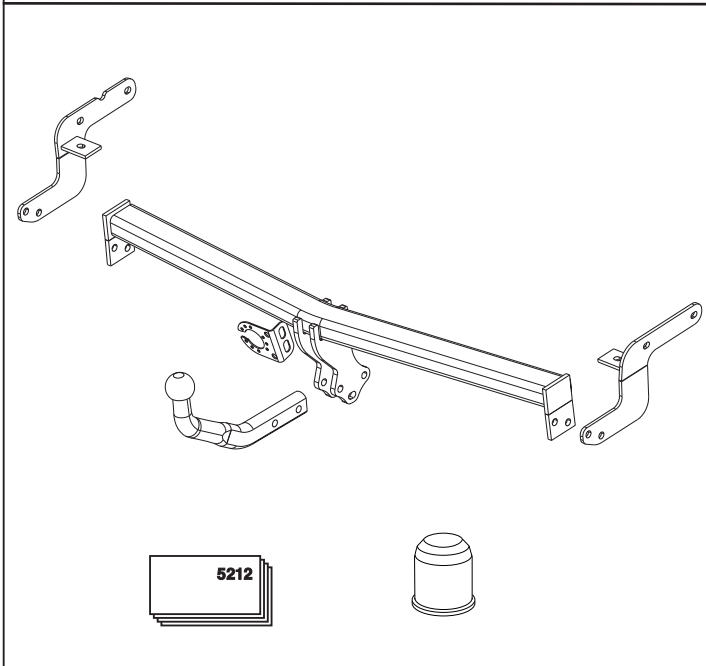
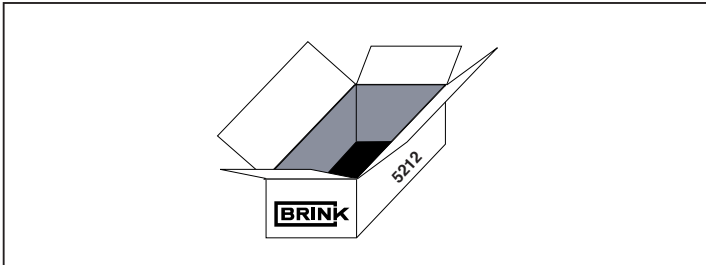

© 521270/25-08-2009/3

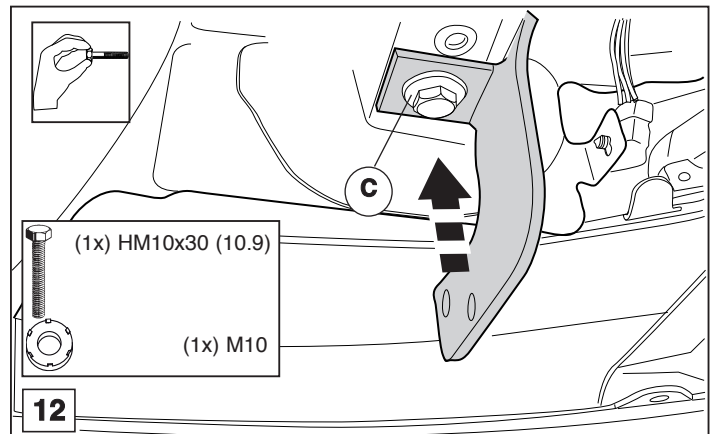
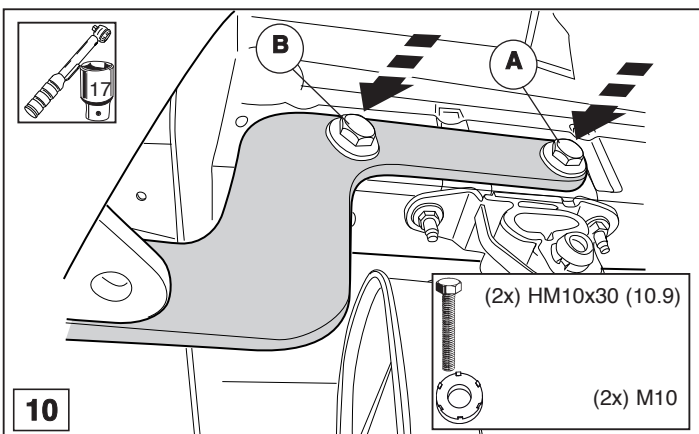
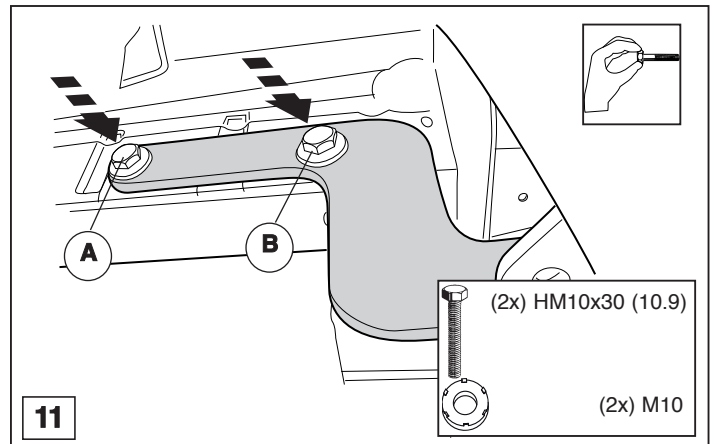
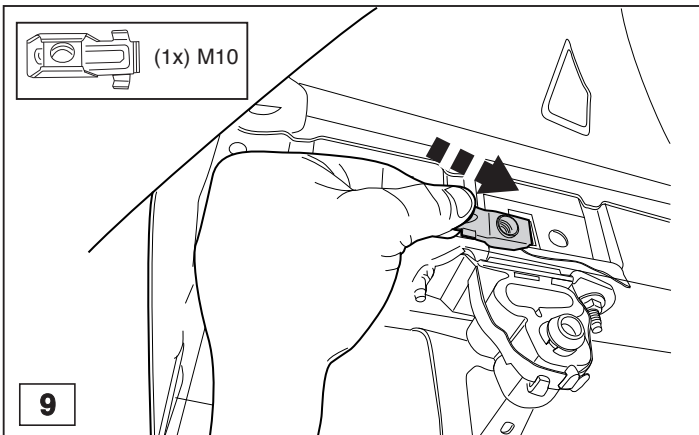

© 521270/25-08-2009/8

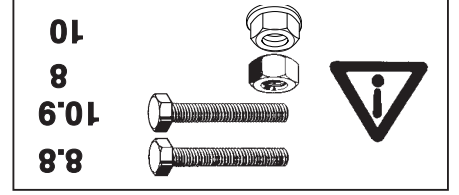
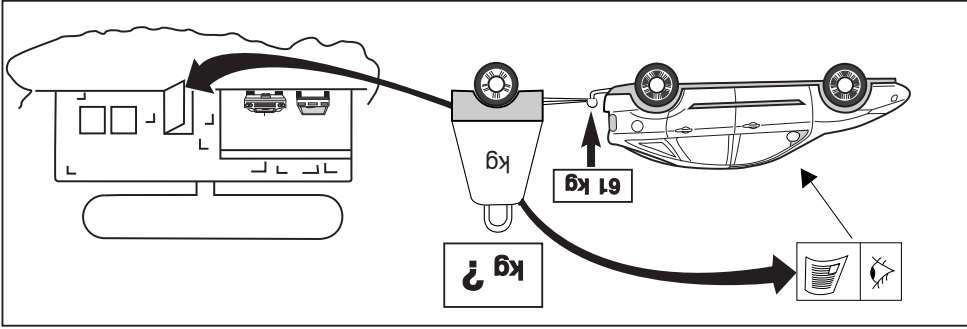
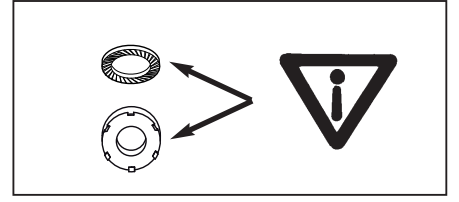
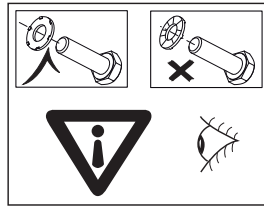
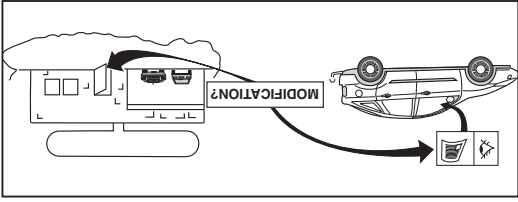

D-Value : 7,3 KN

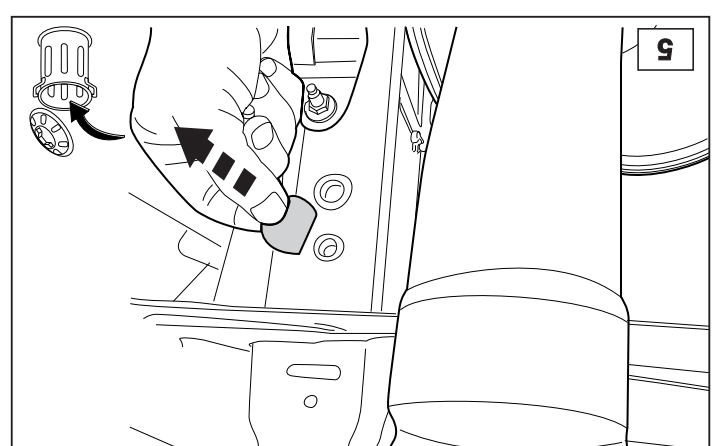
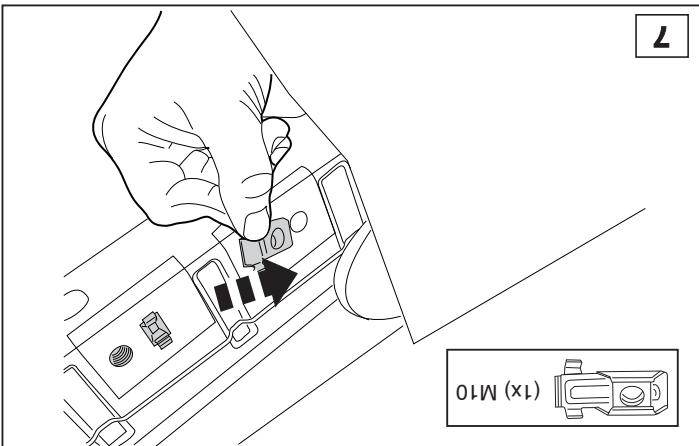
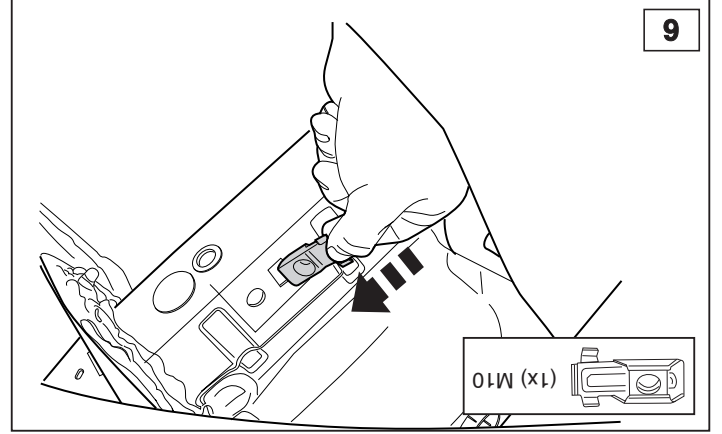
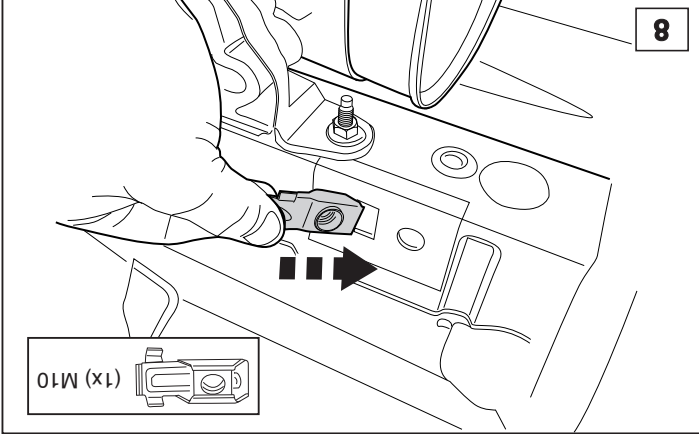
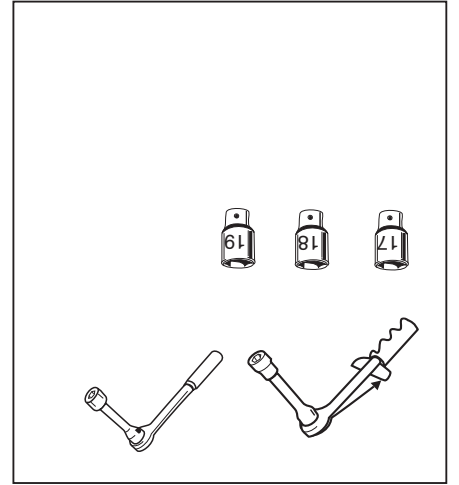
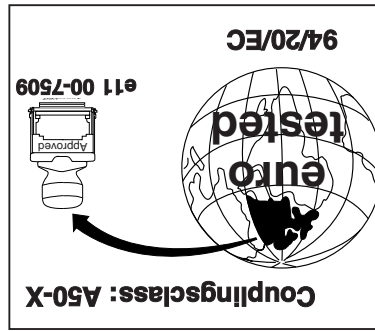



HINWEISE:

* Die für das Fahrzeug zugelassene Anhängelast ist den Fahrzeug Unterlagen zu entnehmen. Bei Änderungen des Fahrzeuggewichtes muß die höchstzulässige Anhängelast gegebenenfalls aus dem D-Wert nachgerechnet werden.

Auskunft hierüber kann Ihr Fachhändler oder der TÜV geben.

* Elektrische Anlage gemäß StVZO anbringen.

NOTE:

ALL MEASUREMENTS ARE IN MM

*** Should this installation process entail the cutting of the bumper – conformation MUST be obtained by the installation engineer of the customer’s acceptance prior to completion. Brink International do not accept responsibility for any matters arising as a result of this miscommunication.**

© 521270/25-08-2009/5

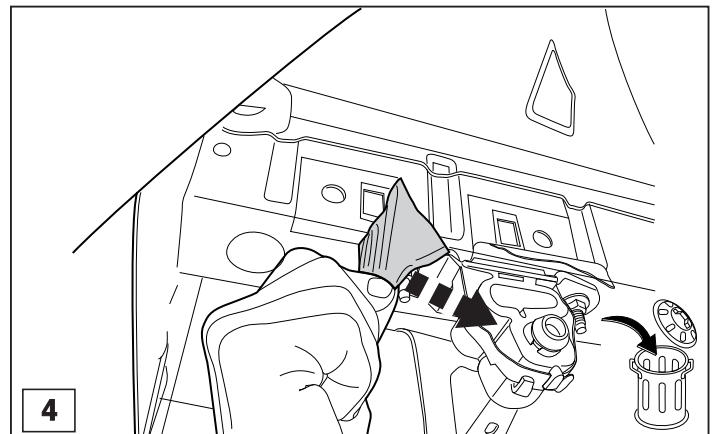
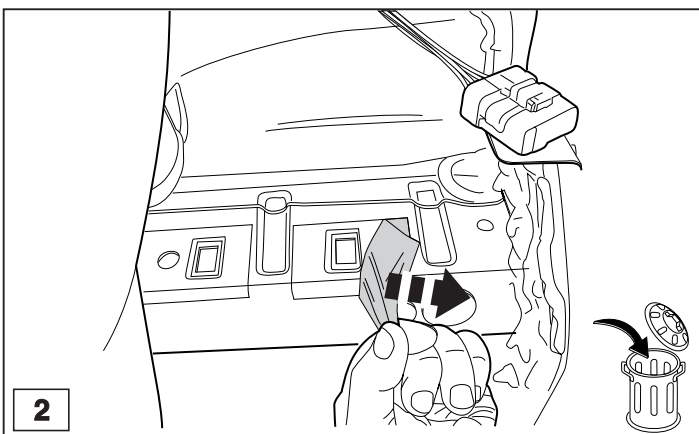
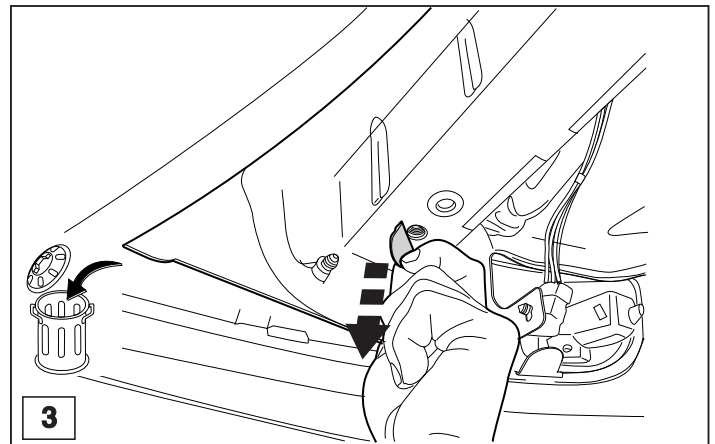
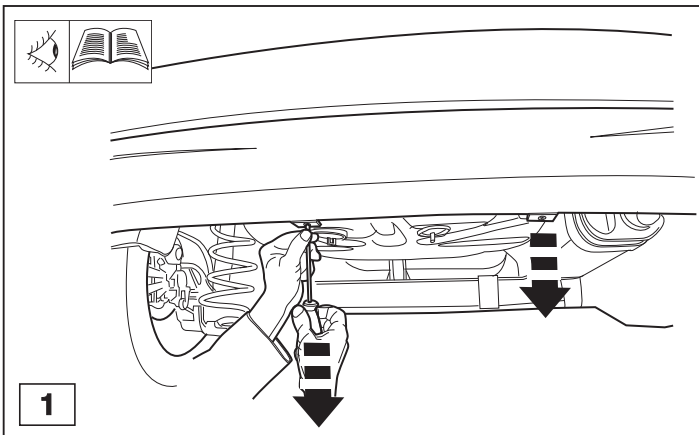

© 521270/25-08-2009/6