

# Kit 1075

HONDA Civic Shuttle, 5-dr MPV, 95-02

HONDA Odyssey, 5-dr MPV, 95-99

480R  
754

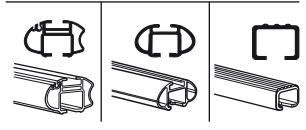
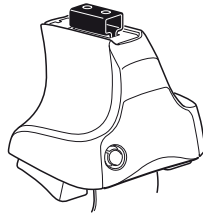

480

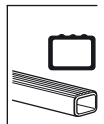
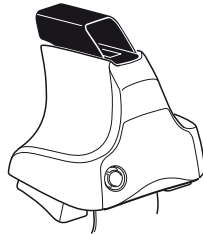

750

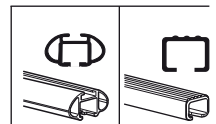
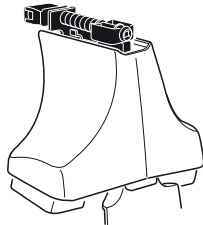

**Kit**

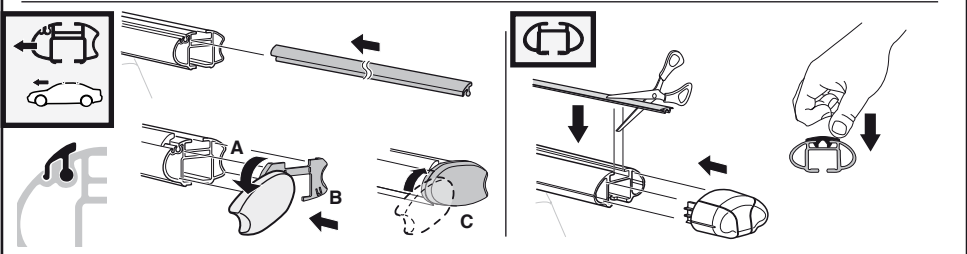
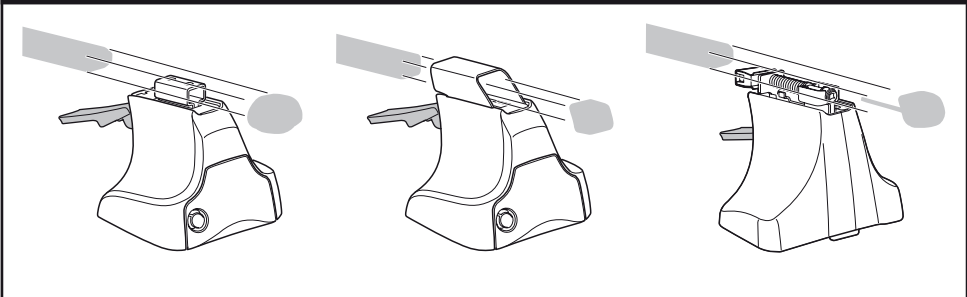

**3**

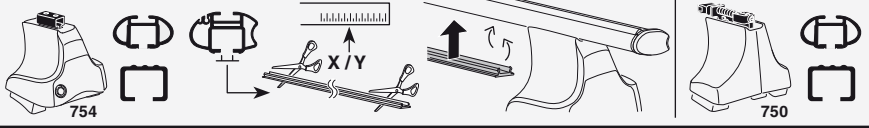

**1**

**2**

	X
<b>HONDA Civic Shuttle, 5-dr MPV, 95-02</b>	37
<b>HONDA Odyssey, 5-dr MPV, 95-99</b>	37

**1**

**2**

	Y
<b>HONDA Civic Shuttle, 5-dr MPV, 95-02</b>	34
<b>HONDA Odyssey, 5-dr MPV, 95-99</b>	34

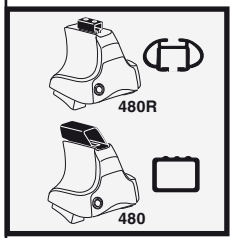

**1**

**2**

	X inch	X mm
<b>HONDA Civic Shuttle, 5-dr MPV, 95-02</b>	40 1/4"	1021 mm
<b>HONDA Odyssey, 5-dr MPV, 95-99</b>	40 1/4"	1021 mm

**1**

**2**

	Y inch	Y mm
<b>HONDA Civic Shuttle, 5-dr MPV, 95-02</b>	39"	991 mm
<b>HONDA Odyssey, 5-dr MPV, 95-99</b>	39"	991 mm

# 4

HONDA Civic Shuttle, 5-dr MPV, 95-02

HONDA Odyssey, 5-dr MPV, 95-99

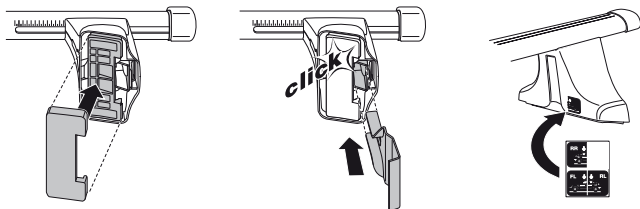
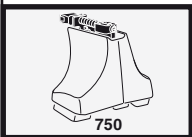
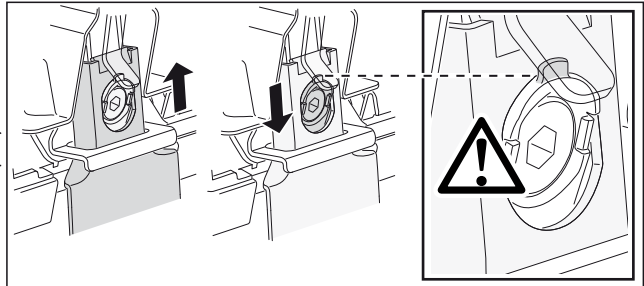
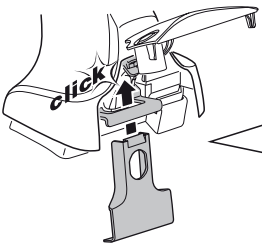
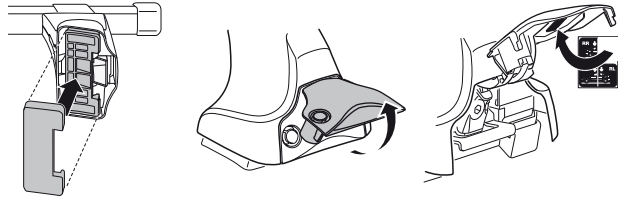
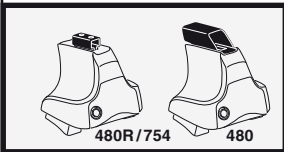
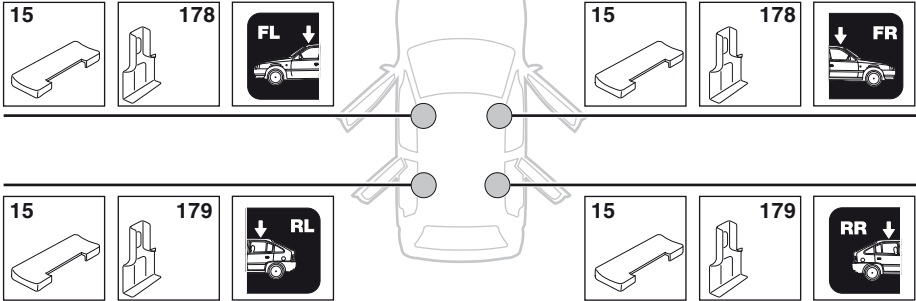

5

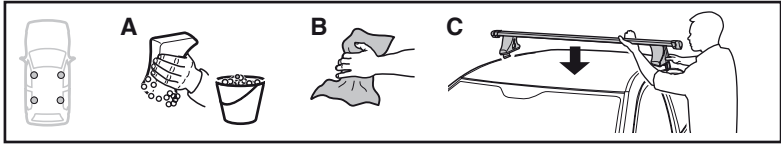

	X mm	Y mm	X inch	Y inch
HONDA Civic Shuttle, 5-dr MPV, 95-02	570 mm	700 mm	22 1/2"	27 1/2"
HONDA Odyssey, 5-dr MPV, 95-99	570 mm	700 mm	22 1/2"	27 1/2"

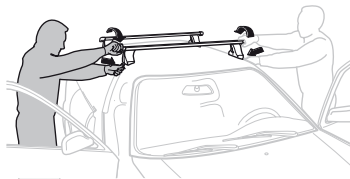
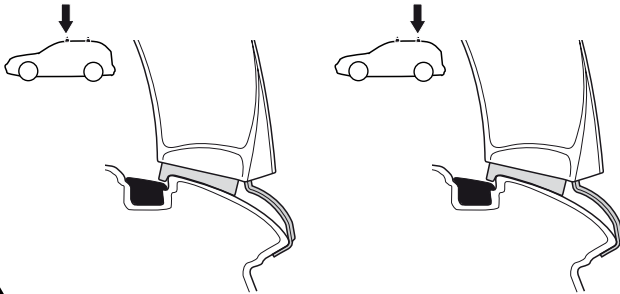
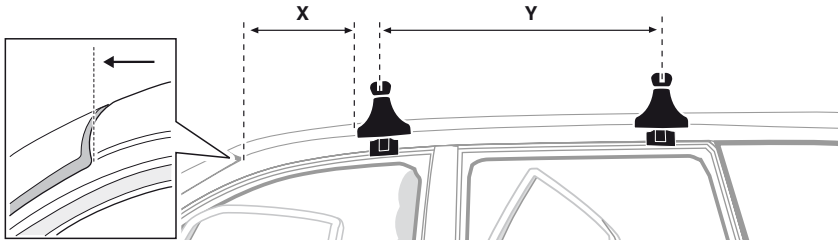

**GB/US** Tighten alternately

**D** Die Schrauben abwechselnd anziehen

**F** Serrer alternativement chaque côté

**NL** Afwisselend aan de linker- en de rechterkant aandraaien

**I** Alternare il serraggio delle viti

**E** Apretar alternativamente

**PT** Aperte alternadamente

**S** Dra åt växelvis

**FIN** Kierrä vuorotellen

**EST** Pinguldage vaheldumisi

**LAT** Pielvelciet pamīšus

**LIT** Užsukinėkite pakaitomis

**PL** Śruby dokręcaj naprzemiennie

**RU** Затягивайте попеременно

**CZ** Pokręťta bagažníka dokręcaj dokręcaj naprzemiennie.

**SK** Doťahujte striedavo

**SLO** Privijajte izmenično.

**HR** Naizmjenično zategnite

**HU** Egymástól függetlenül szorítandó

**GR** Σφίγγετε εναλλάξ

**TR** Dönüşümlü sıkın

**中文** 交替拧紧

**한국어** 번갈아 가며 조이십시오.

**日本語** 交互に締め付けてください。

**ไทย** ชั้ไนแบบสลับ

6



480R/754



480

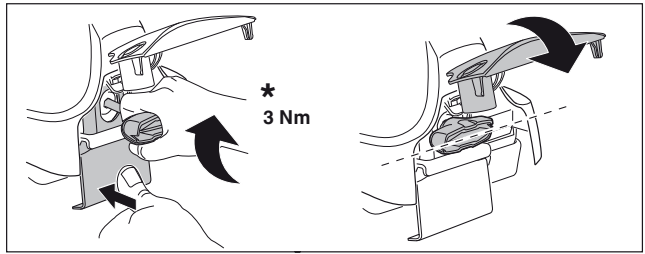
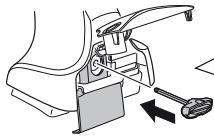

\*  
3 Nm

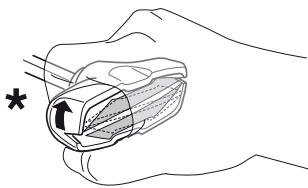

\*

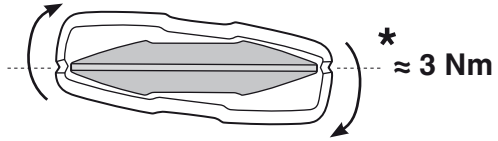

\*  
≈ 3 Nm

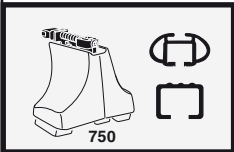
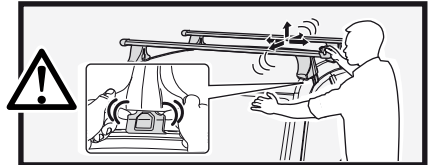

750

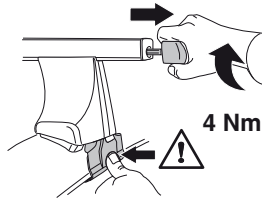

4 Nm

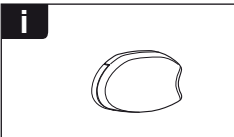
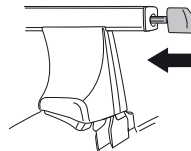

i

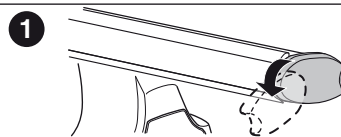

1

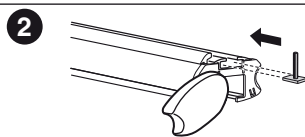

2

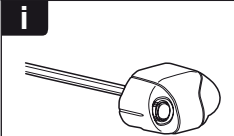

i

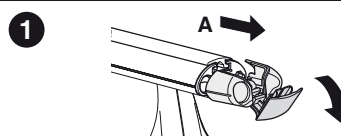

1

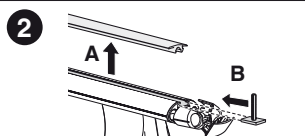

2

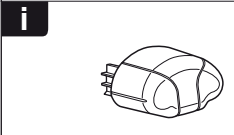

i

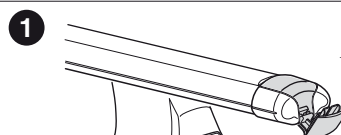

1

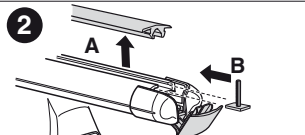

2

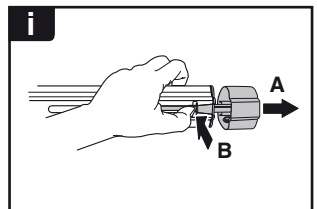
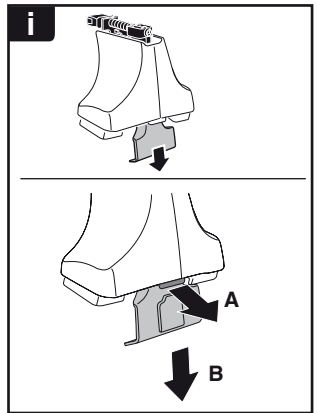
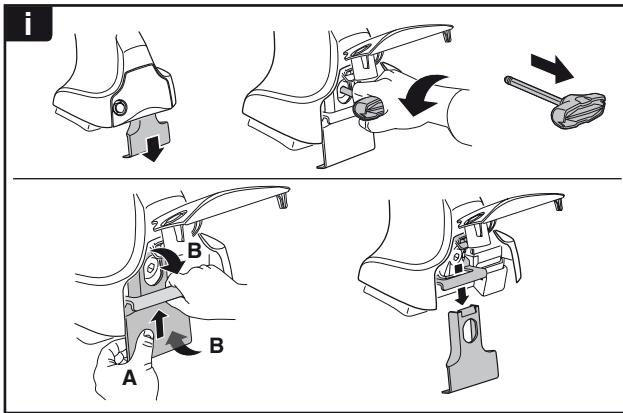
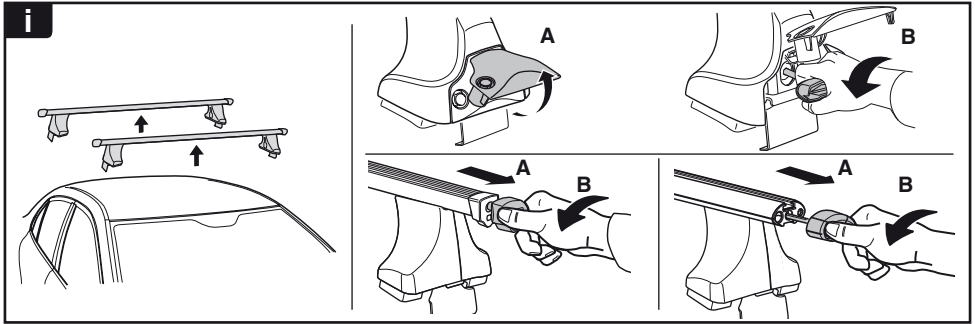

**THULE**  
SWEDEN  
**ONE  
KEY  
SYSTEM**

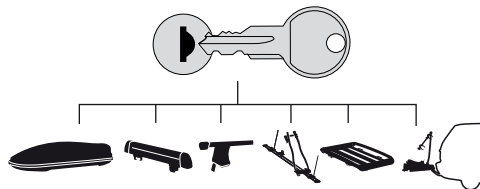

- 544 (x4)
- 596 (x6)
- 588 (x8)
- NA 510 (x10)
- EUR 452 (x12)
- ASIA

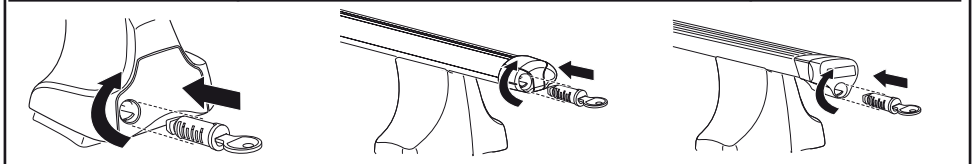

WW ▶ Thule Sweden AB, Box 69, 330 33 Hillerstorp, SWEDEN  
NA ▶ Thule Inc., 42 Silvermine Road, Seymour, Connecticut 06483, USA

info@thule.com  
customer.service@thule.com

www.thule.com