

# Kit 1192

**CHRYSLER Neon**, 4-dr Sedan, 00-04

**DODGE Neon**, 4-dr Sedan, 00-04 / \*00-05

**PLYMOUTH Neon**, 4-dr Sedan, 00-04 / \*00-01

\*North America

480R  
754

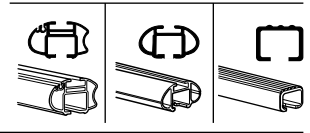
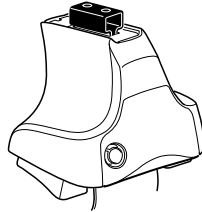

480

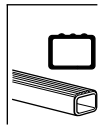
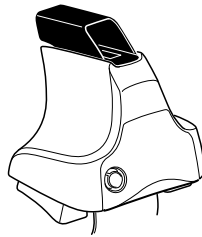

750

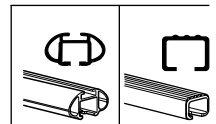
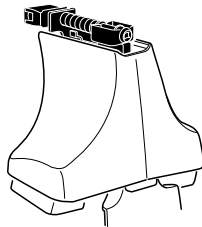

**Max. 75kg**  
**Max. 165 lbs**

x1
 x4
 x4
 x4
 x4

480R/754

---

x1
 x4
 x4
 x4

480

---

x1
 x4
 x4

750

x2 x2 x2 x4	x2	x2 x2 x4 x4	x2 x2	x2
----------------------	----	----------------------	----------	----

x4
 x2

x4
 x1

x1

x1

**Kit**



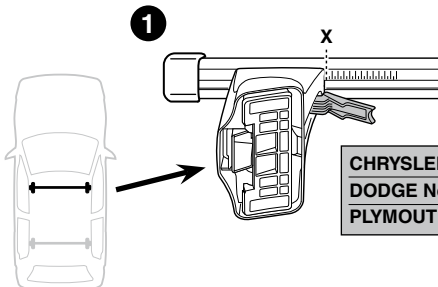
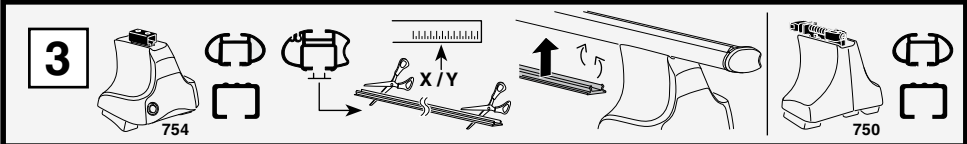

	X
<b>CHRYSLER Neon, 4-dr Sedan, 00-04</b>	20
<b>DODGE Neon, 4-dr Sedan, 00-04 / *00-05</b>	20
<b>PLYMOUTH Neon, 4-dr Sedan, 00-04 / *00-01</b>	20

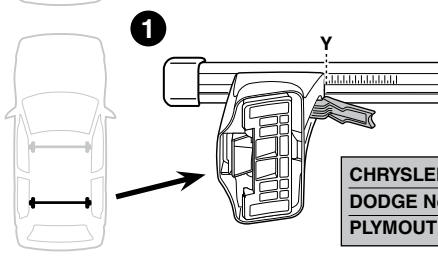
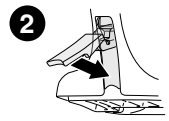

	Y
<b>CHRYSLER Neon, 4-dr Sedan, 00-04</b>	16
<b>DODGE Neon, 4-dr Sedan, 00-04 / *00-05</b>	16
<b>PLYMOUTH Neon, 4-dr Sedan, 00-04 / *00-01</b>	16

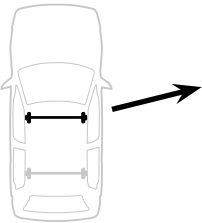
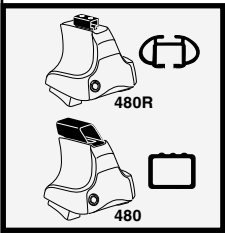
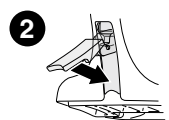

	X inch	X mm
<b>CHRYSLER Neon, 4-dr Sedan, 00-04</b>	33 1/2"	851 mm
<b>DODGE Neon, 4-dr Sedan, 00-04 / *00-05</b>	33 1/2"	851 mm
<b>PLYMOUTH Neon, 4-dr Sedan, 00-04 / *00-01</b>	33 1/2"	851 mm

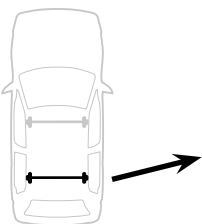
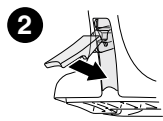

	Y inch	Y mm
<b>CHRYSLER Neon, 4-dr Sedan, 00-04</b>	31 7/8"	811 mm
<b>DODGE Neon, 4-dr Sedan, 00-04 / *00-05</b>	31 7/8"	811 mm
<b>PLYMOUTH Neon, 4-dr Sedan, 00-04 / *00-01</b>	31 7/8"	811 mm

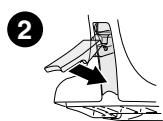

# 4

**CHRYSLER Neon**, 4-dr Sedan, 00-04  
**DODGE Neon**, 4-dr Sedan, 00-04 / \*00-05  
**PLYMOUTH Neon**, 4-dr Sedan, 00-04 / \*00-01

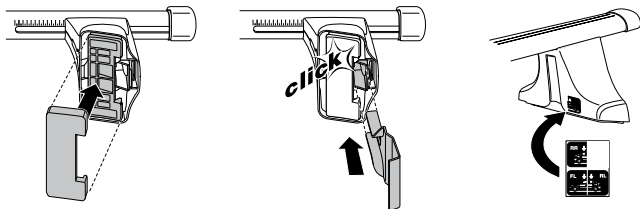
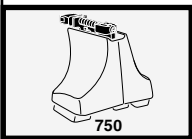
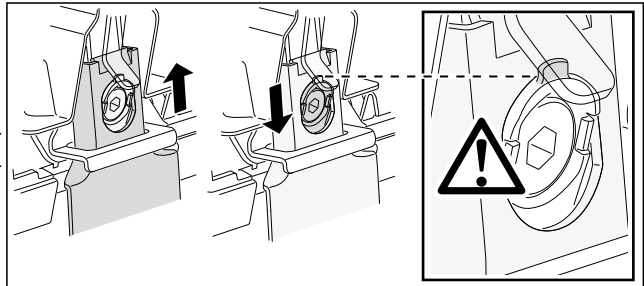
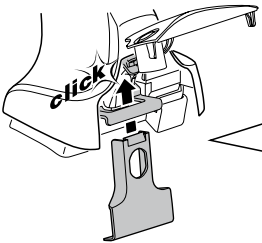
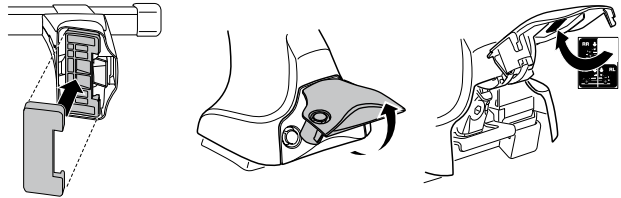
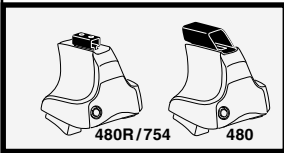
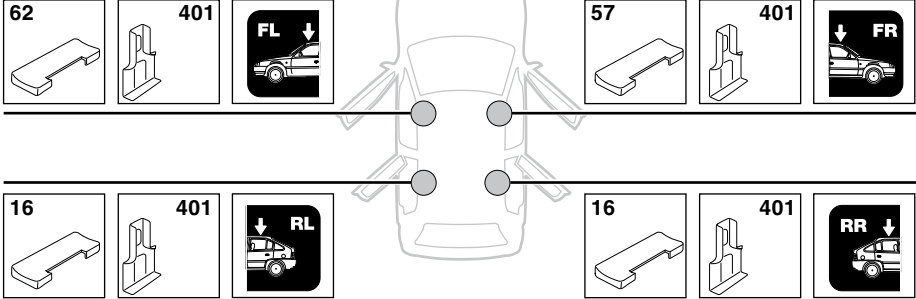

5



	X mm	Y mm	X inch	Y inch
<b>CHRYSLER Neon</b> , 4-dr Sedan, 00-04	210 mm	650 mm	8 1/4"	25 5/8"
<b>DODGE Neon</b> , 4-dr Sedan, 00-04 / *00-05	210 mm	650 mm	8 1/4"	25 5/8"
<b>PLYMOUTH Neon</b> , 4-dr Sedan, 00-04 / *00-01	210 mm	650 mm	8 1/4"	25 5/8"

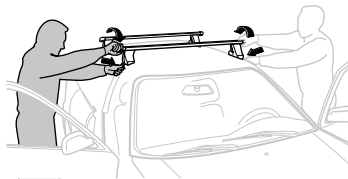
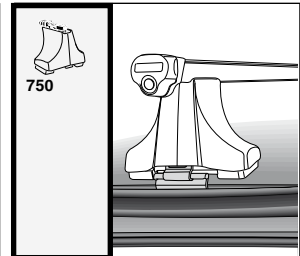
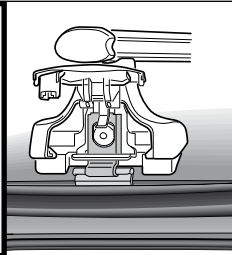
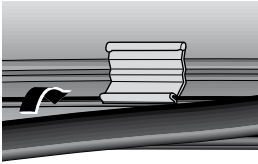
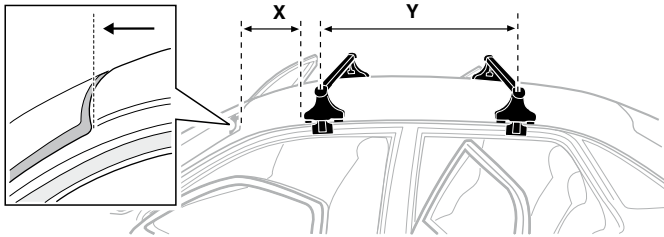

**GB/US** Tighten alternately

**D** Die Schrauben abwechselnd anziehen

**F** Serrer alternativement chaque côté

**NL** Afwisselend aan de linker- en de rechterkant aandraaien

**I** Alternare il serraggio delle viti

**E** Serrare alternativamente

**PT** Aperte alternadamente

**S** Dra åt växelvis

**FIN** Kierrä vuorotellen

**EST** Pinguldage vaheldumisi

**LAT** Pielvelciēt pamāšus

**LIT** Užsukinėkite pakaitomis

**PL** Śruby dokręcaj naprzemiennie

**RU** Затягивайте попеременно

**CZ** Pokręťta bagožníka dokręcaj dokręcaj naprzemiennie.

**SK** Doťahujte striedavo

**SLO** Privijajte izmenično.

**HR** Naizmjenično zategnite

**HU** Egymástól főlgettenül szorítandó

**GR** Σφιγγετε εναλλάξ

**TR** Dönüşümlü sıkın

**中文** 交替拧紧

**한국어** 번갈아 가며 조이십시오.

**日本語** 交互に締め付けてください。

**ไทย** ชั้โน้แบบสลับ

6

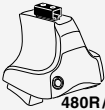

480R/754



480

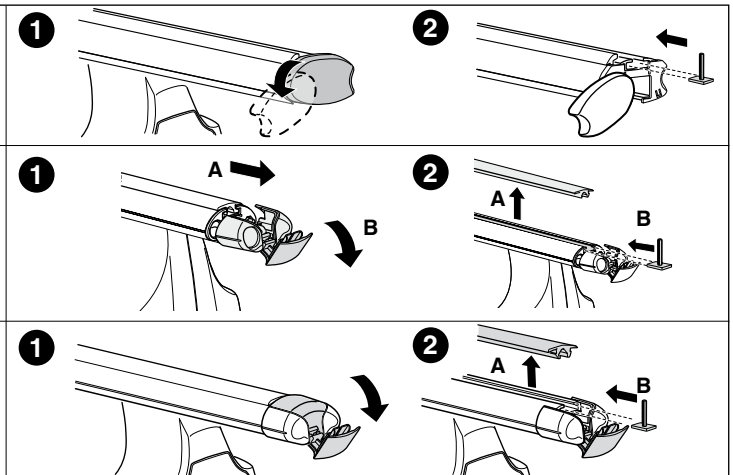
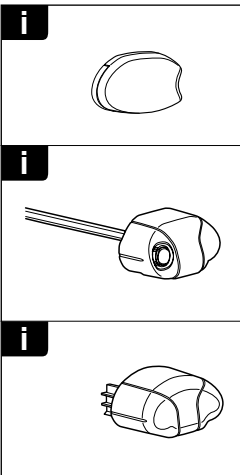
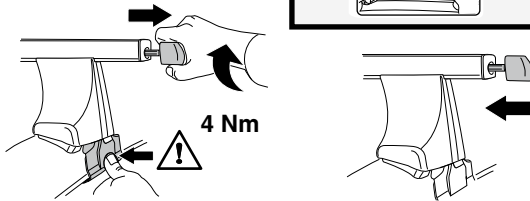
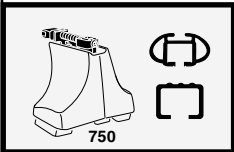
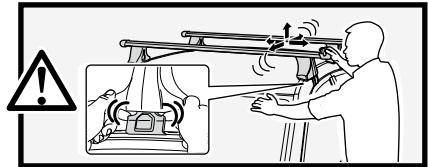
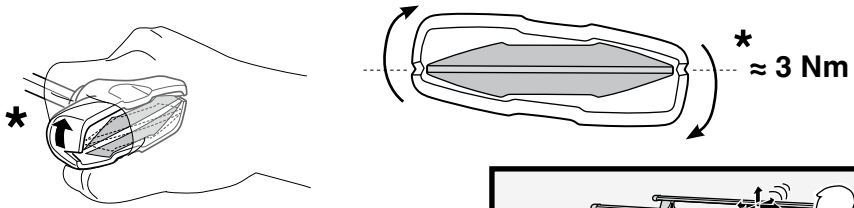
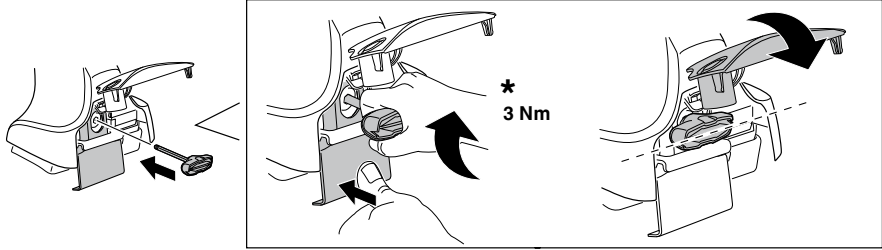

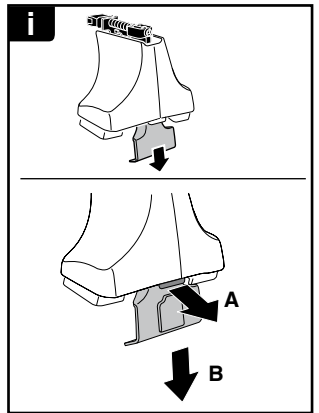
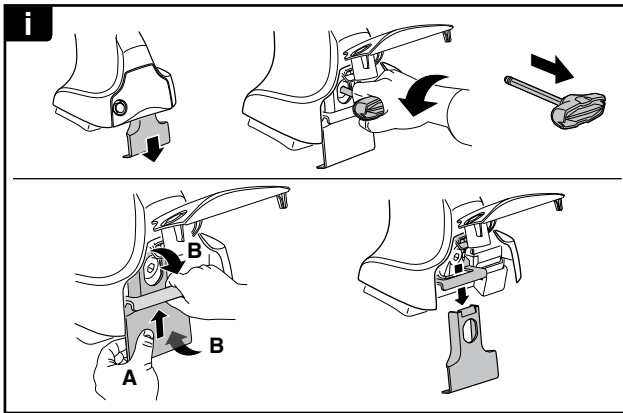
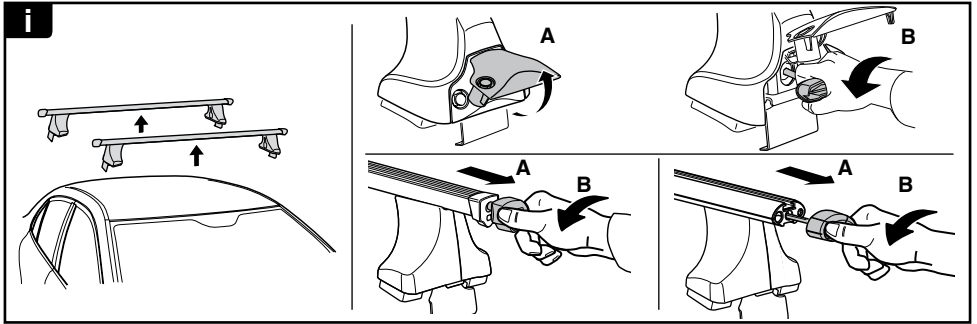

**THULE**  
SWEDEN  
**ONE  
KEY  
SYSTEM**



- 544** (x4)
  - 596** (x6)
  - 588** (x8)
  - 510** (x10)
  - 452** (x12)
- NA  
EUR  
ASIA



WW ▶ Thule Sweden AB, Box 69, 330 33 Hillerstorp, SWEDEN  
NA ▶ Thule Inc., 42 Silvermine Road, Seymour, Connecticut 06483, USA

info@thule.com  
customer.service@thule.com

www.thule.com