

# Kit 1120

TOYOTA Nadia, 5-dr Estate, 98-03

TOYOTA Nadia SU, 5-dr Estate, 00-03

480R  
754

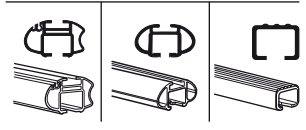
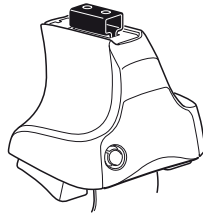

480

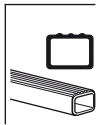
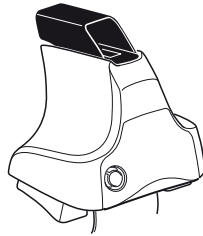

750

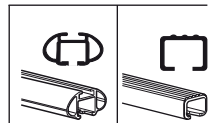
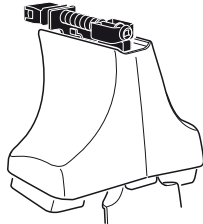

**Kit**



**3**

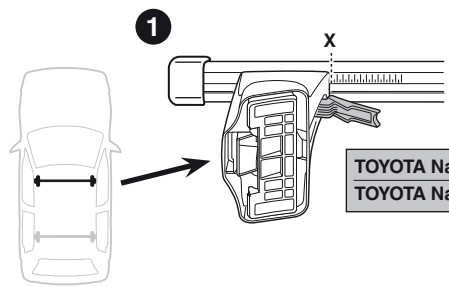
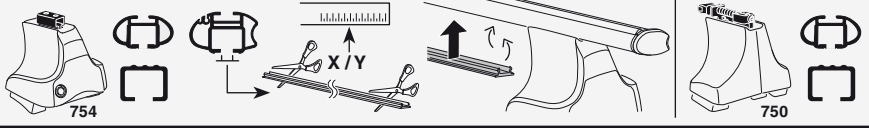

	X
TOYOTA Nadia, 5-dr Estate, 98-03	32,5
TOYOTA Nadia SU, 5-dr Estate, 00-03	32,5

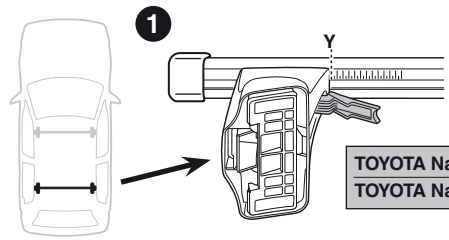
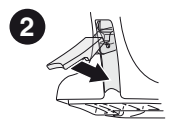

	Y
TOYOTA Nadia, 5-dr Estate, 98-03	33,5
TOYOTA Nadia SU, 5-dr Estate, 00-03	33,5

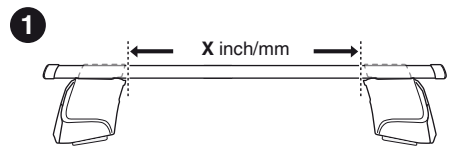
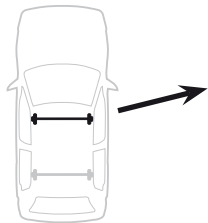
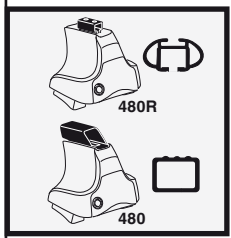
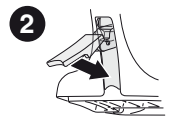

	X inch	X mm
TOYOTA Nadia, 5-dr Estate, 98-03	38 <sup>3</sup> / <sub>8</sub> "	976 mm
TOYOTA Nadia SU, 5-dr Estate, 00-03	38 <sup>3</sup> / <sub>8</sub> "	976 mm

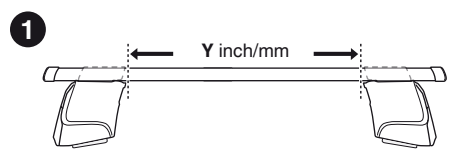
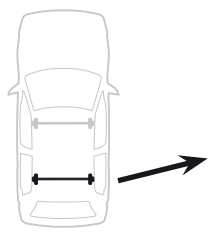
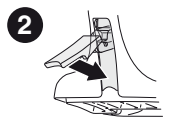

	Y inch	Y mm
TOYOTA Nadia, 5-dr Estate, 98-03	38 <sup>7</sup> / <sub>8</sub> "	986 mm
TOYOTA Nadia SU, 5-dr Estate, 00-03	38 <sup>7</sup> / <sub>8</sub> "	986 mm

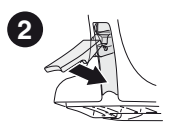

# 4

TOYOTA Nadia, 5-dr Estate, 98-03  
 TOYOTA Nadia SU, 5-dr Estate, 00-03

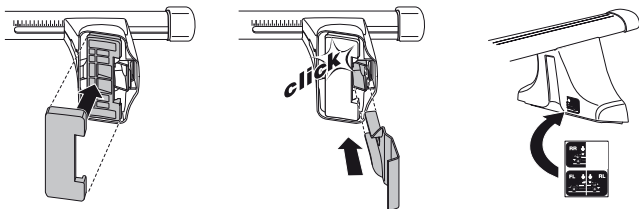
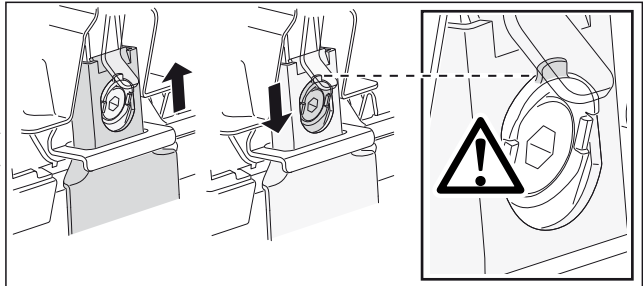
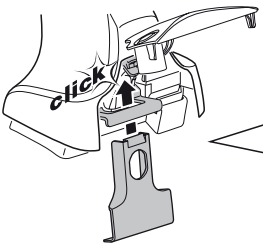
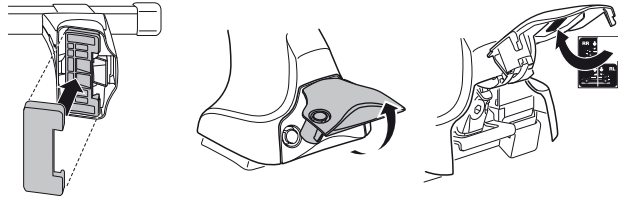
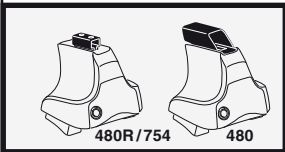
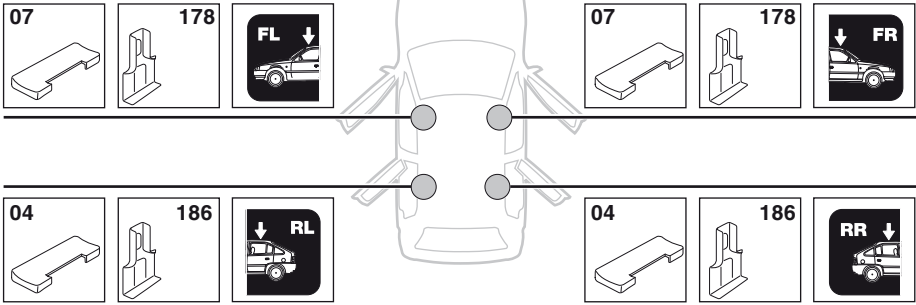

**5**



	X mm	Y mm	X inch	Y inch
<b>TOYOTA Nadia</b> , 5-dr Estate, 98-03	400 mm	700 mm	15 <sup>3</sup> / <sub>4</sub> "	27 <sup>1</sup> / <sub>2</sub> "
<b>TOYOTA Nadia SU</b> , 5-dr Estate, 00-03	400 mm	700 mm	15 <sup>3</sup> / <sub>4</sub> "	27 <sup>1</sup> / <sub>2</sub> "

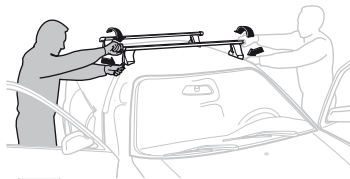
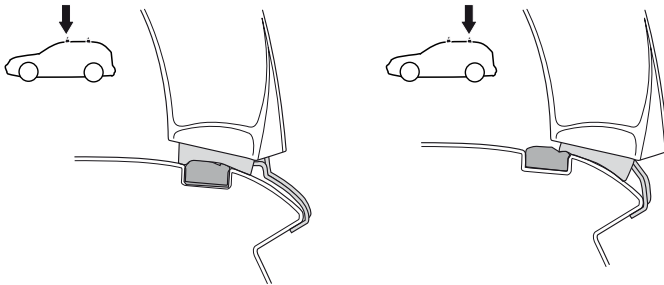
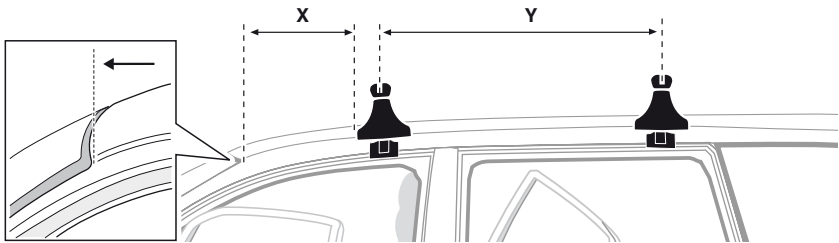

**GB/US** Tighten alternately

**D** Die Schrauben abwechselnd anziehen

**F** Serrer alternativement chaque côté

**NL** Afwisselend aan de linker- en de rechterkant aandraaien

**I** Alternare il serraggio delle viti

**E** Apertar alternativamente

**PT** Aperte alternadamente

**S** Dra åt växelvis

**FIN** Kierrä vuorotellen

**EST** Pinguldage vaheldumisi

**LAT** Pielvelciēt pamīšus

**LIT** Užsukinėkite pakaitomis

**PL** Śruby dokręcaj naprzemiennie

**RU** Затягивайте попеременно

**CZ** Pokręťta bagažníka dokręcaj dokręcaj naprzemiennie.

**SK** Doťahujte striedavo

**SLO** Privijajte izmenično.

**HR** Naizmjenično zategnite

**HU** Egymástól függetlenül szorítandó

**GR** Σφίγγετε εναλλάξ

**TR** Dönüşümlü sıkın

**中文** 交替拧紧

**한국어** 번갈아 가며 조이십시오.

**日本語** 交互に締め付けてください。

**ไทย** ชั้้นโน้แบบสลับ

6



480R/754



480

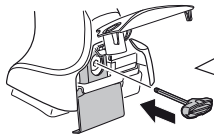

\*  
3 Nm



\*

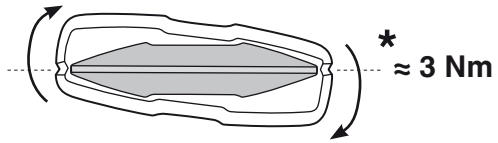

\*  
≈ 3 Nm

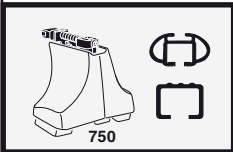
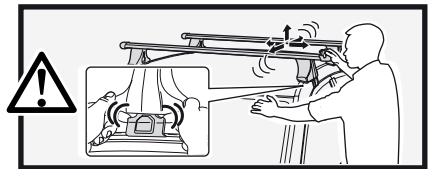

750

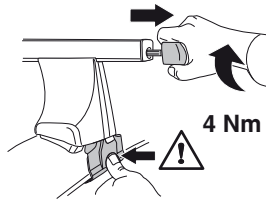

4 Nm

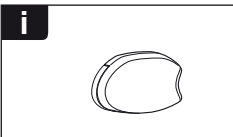
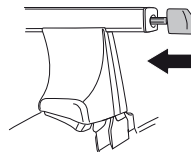

i

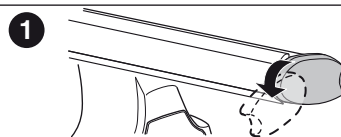

1

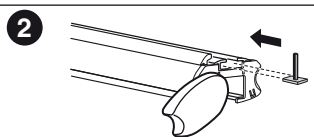

2

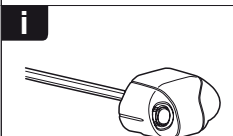

i

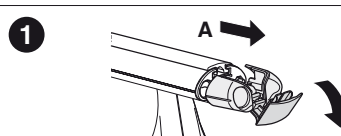

1

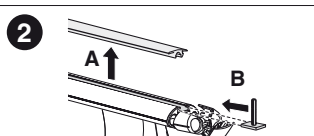

2

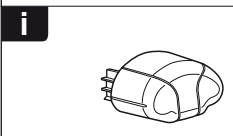

i

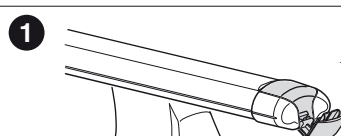

1

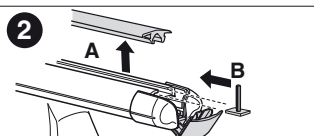

2



**THULE**  
SWEDEN  
**ONE  
KEY  
SYSTEM**



- 544 (x4)
- 596 (x6)
- 588 (x8)
- NA 510 (x10)
- EUR 452 (x12)
- ASIA



WW ▶ Thule Sweden AB, Box 69, 330 33 Hillerstorp, SWEDEN  
NA ▶ Thule Inc., 42 Silvermine Road, Seymour, Connecticut 06483, USA

info@thule.com  
customer.service@thule.com

www.thule.com