Fitting instructions

Make: Nissan

almera 3+5 doors (N16); 01-2000 ->

Type: 2667

Permanently





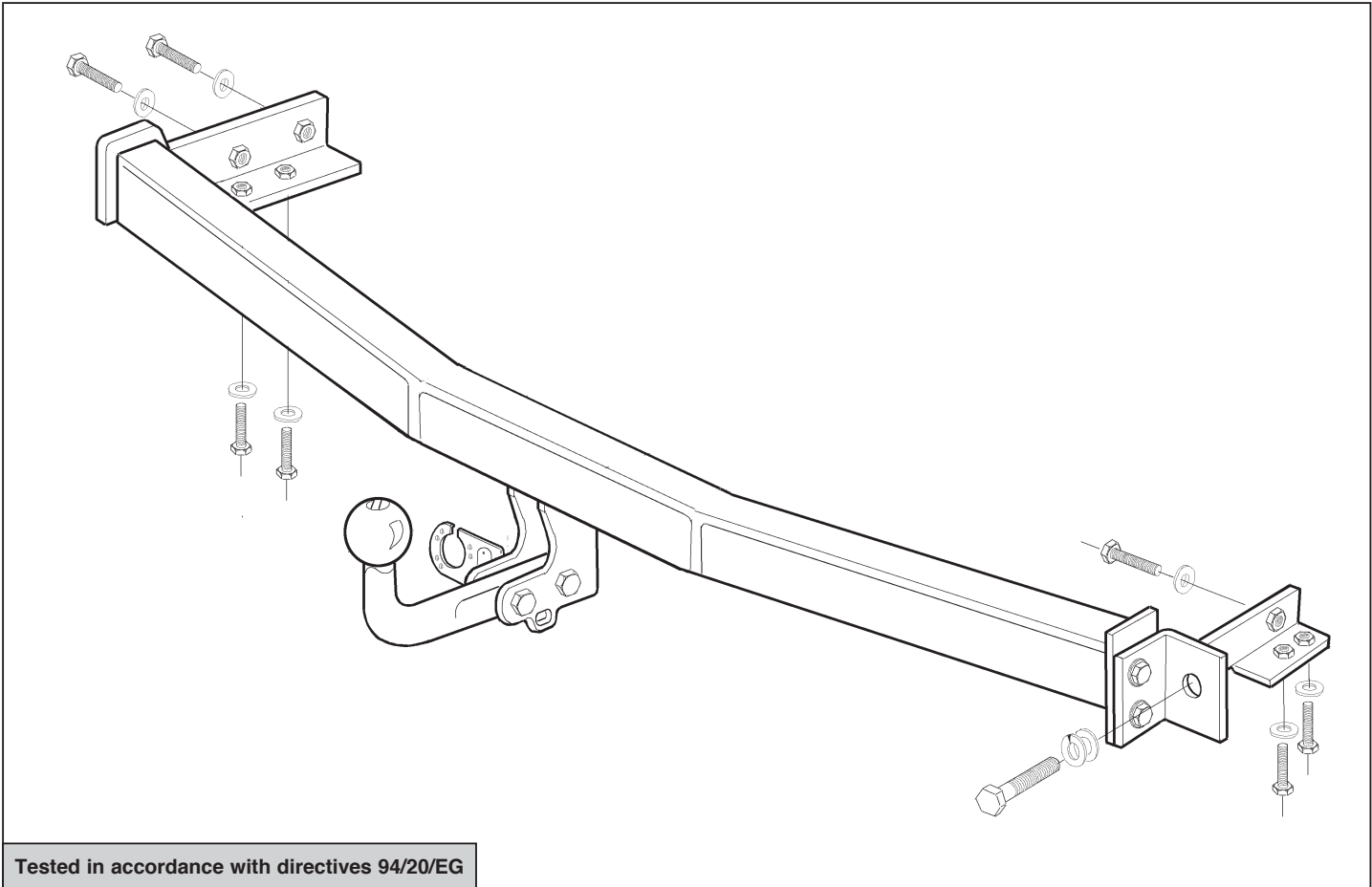







linked to

quality



Tested in accordance with directives 94/20/EG

© 2667/08-04-2004/1

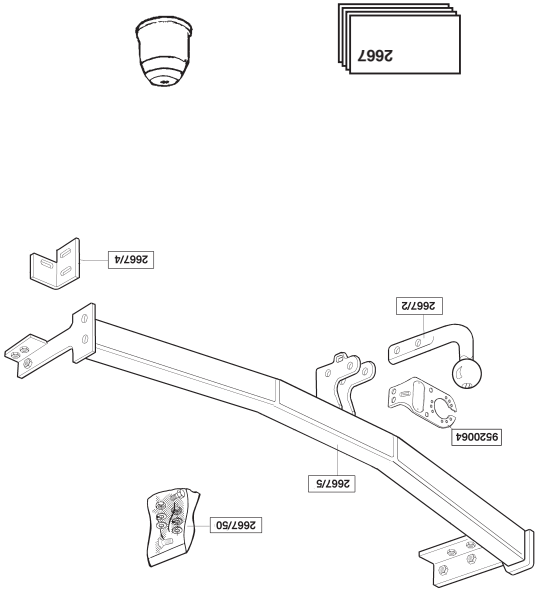
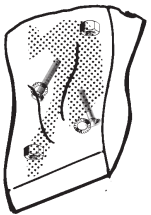
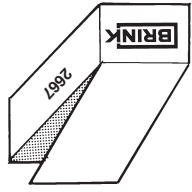
<p>selflocking (2x) M12 </p> <p>(2x) M12 </p> <p>M12x75/31.2 (1x) </p> <p>M12x70/26.2 (1x) </p>	<p>(1x) M10 </p> <p>(7x) $\varnothing 25 \times 10,5 \times 4$ </p> <p>(1x) M16 </p> <p>(2x) M10 </p> <p>(1x) M16 </p> <p>(9x) M10 </p> <p>(1x) M16x40 </p> <p>(9x) M10x30 </p>	
		

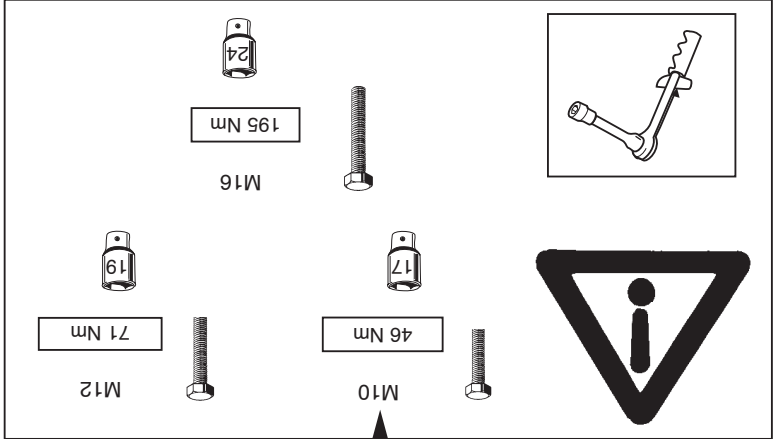

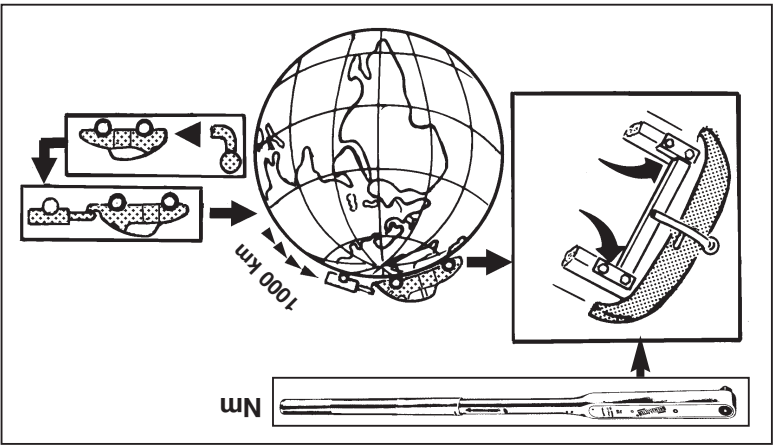

HINWEISE:

D

* Die für das Fahrzeug zugelassene Anhängelast ist den Fahrzeugunterlagen zu entnehmen. Bei Änderungen des Fahrzeuggewichtes muß die höchstzulässige Anhängelast gegebenenfalls aus dem D-Wert nachgerechnet werden.

* Auskunft hierüber kann Ihr Fachhändler oder der TÜV geben.

* Elektrische Anlage gemäß StVZO anbringen.

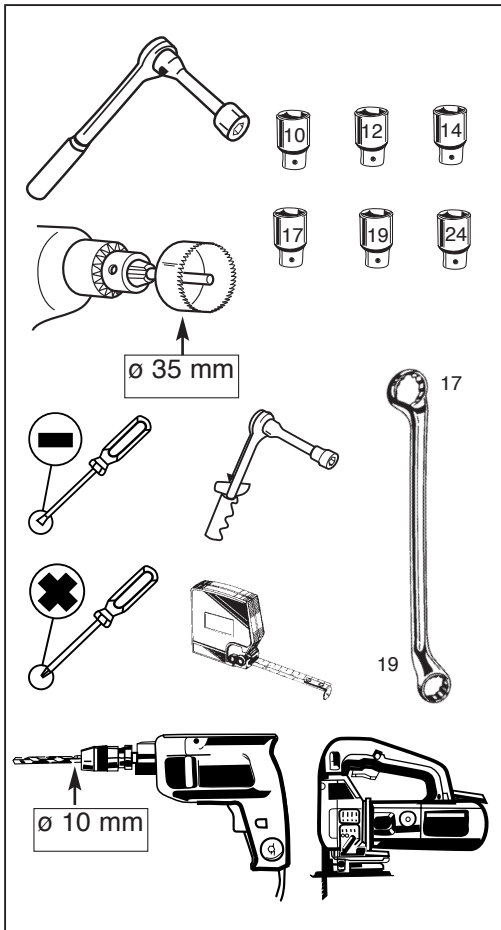

D-value

$$D = \frac{\text{K/G max} \times \text{K/G max}}{\text{K/G max} + \text{K/G max}} \times \frac{9.81}{1000} = 8.1 \text{ kN}$$

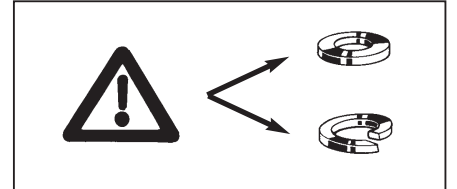
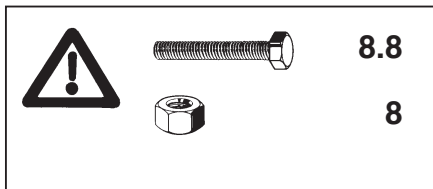
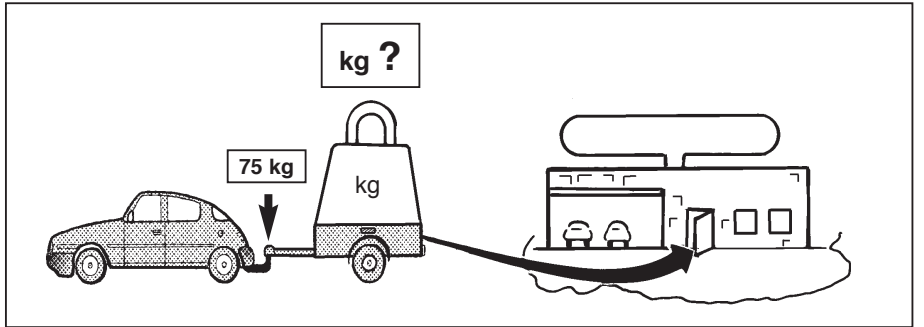

© 2667/08-04-2004/3

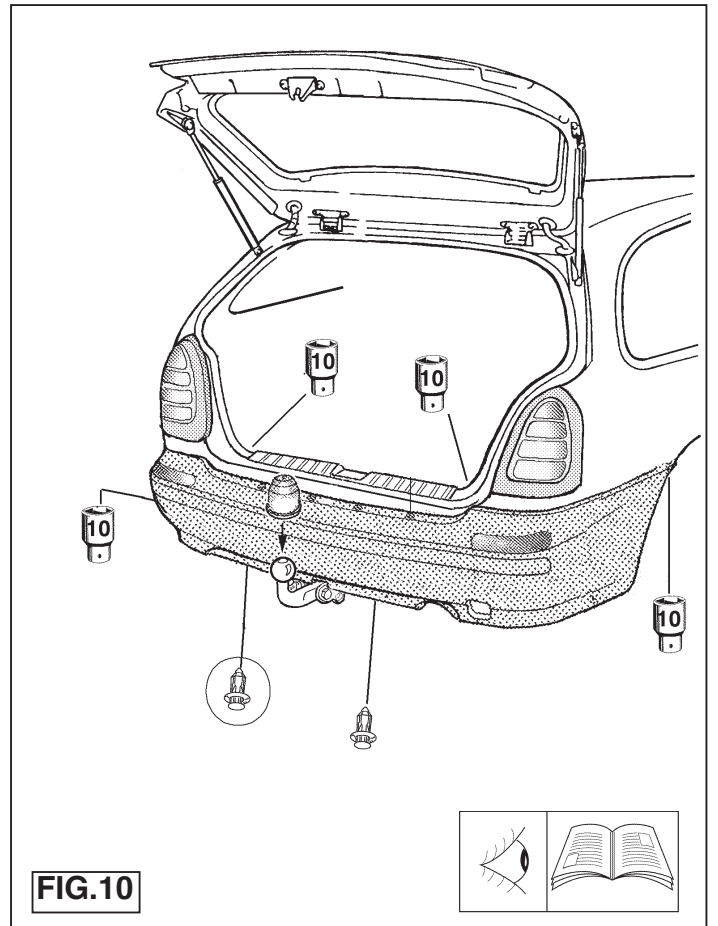
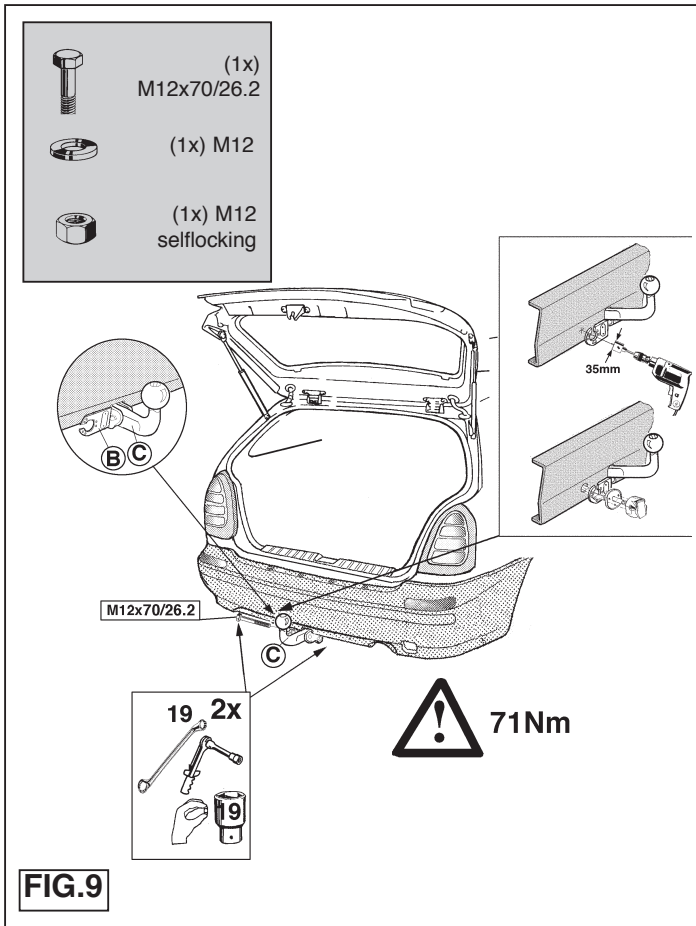

© 2667/08-04-2004/8

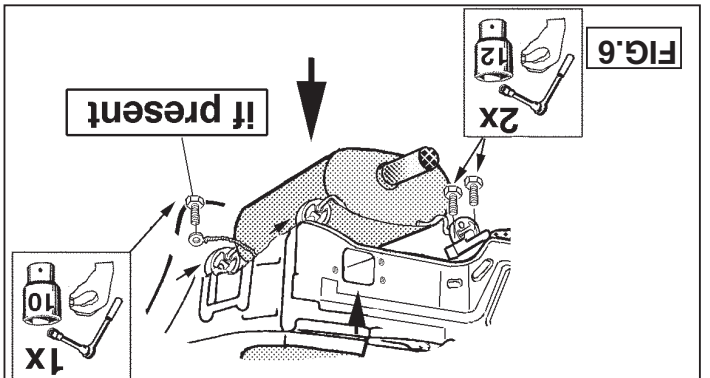
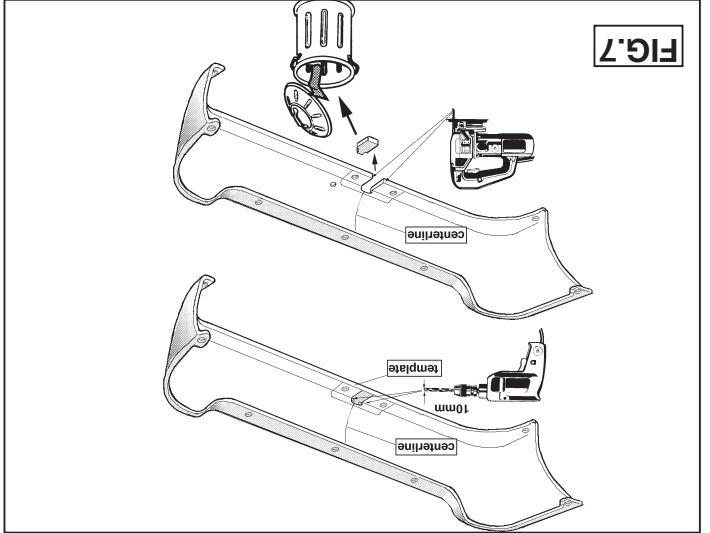
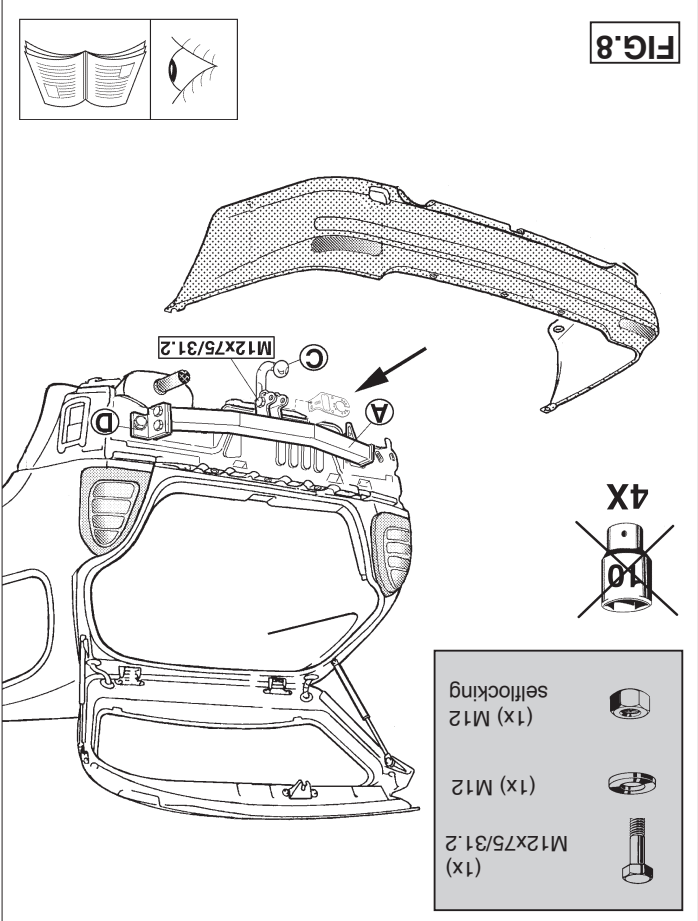
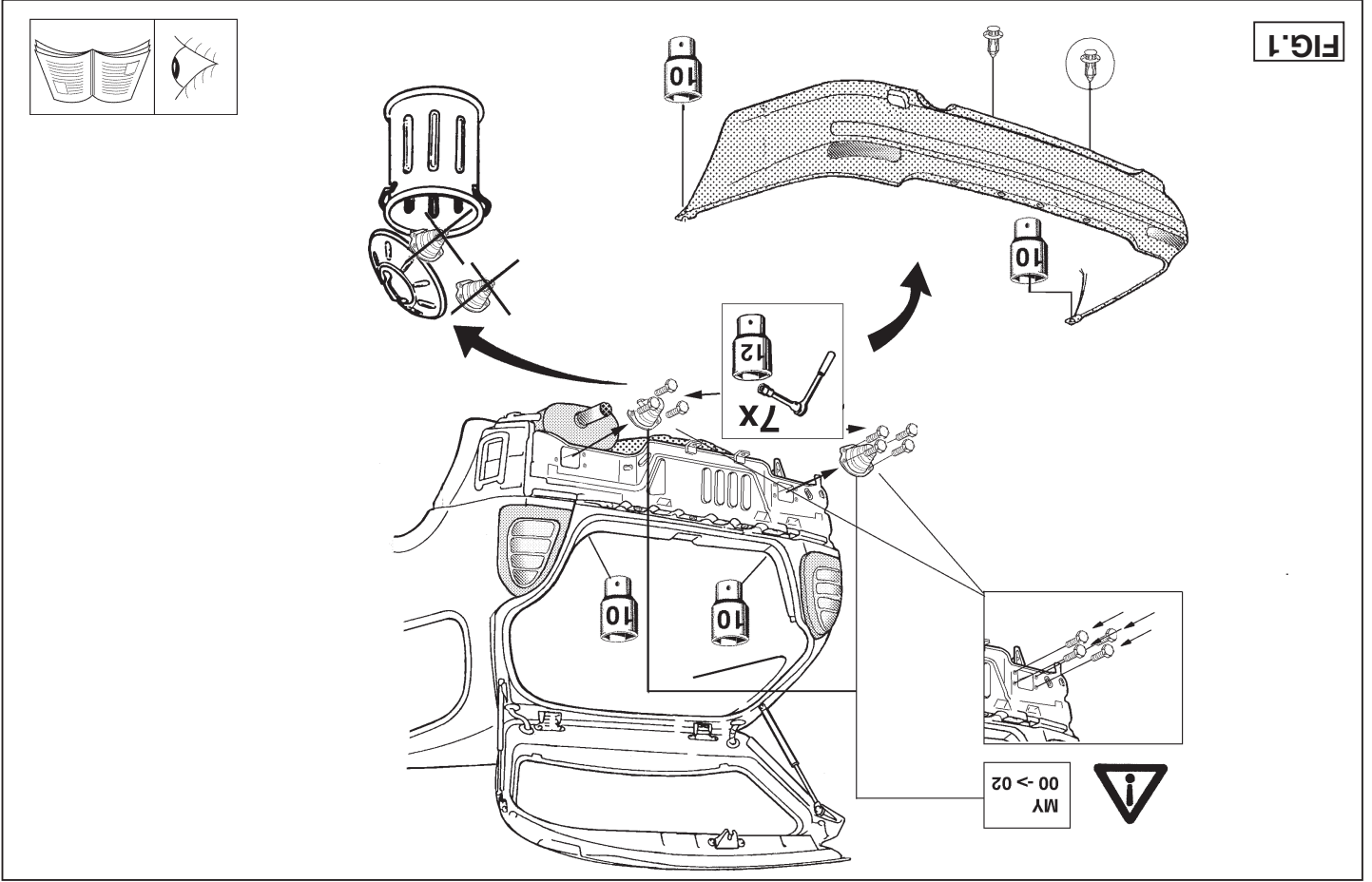

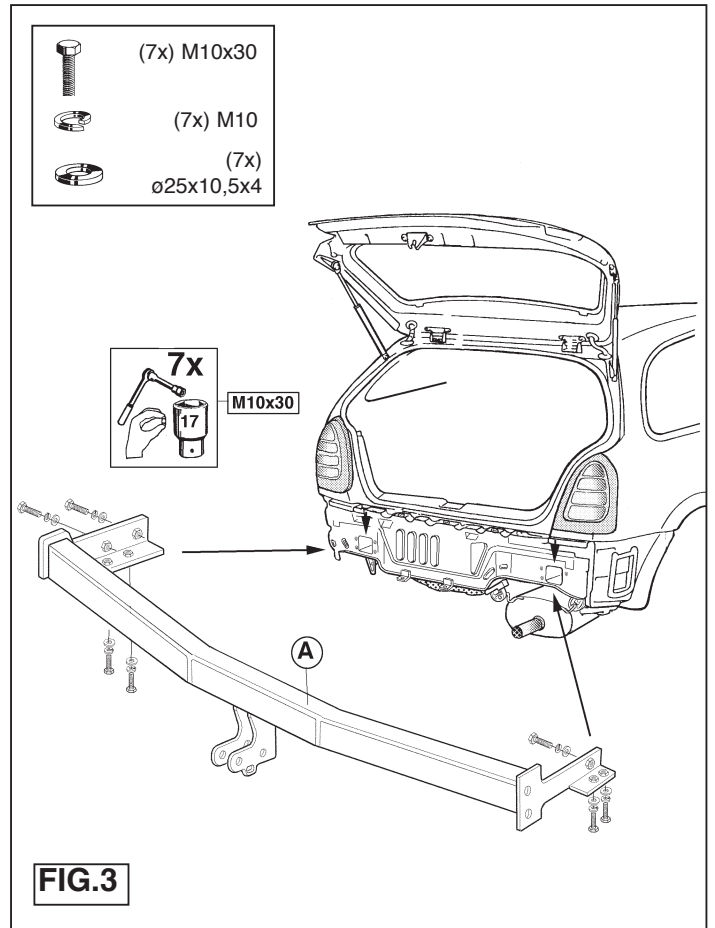
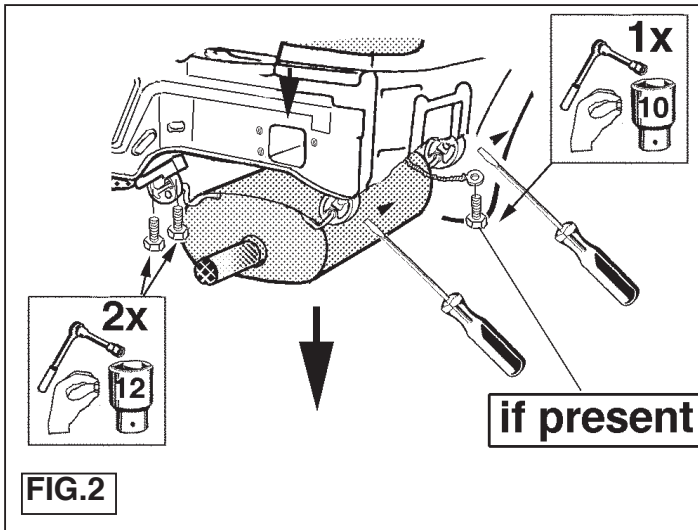

© 2667/08-04-2004/5

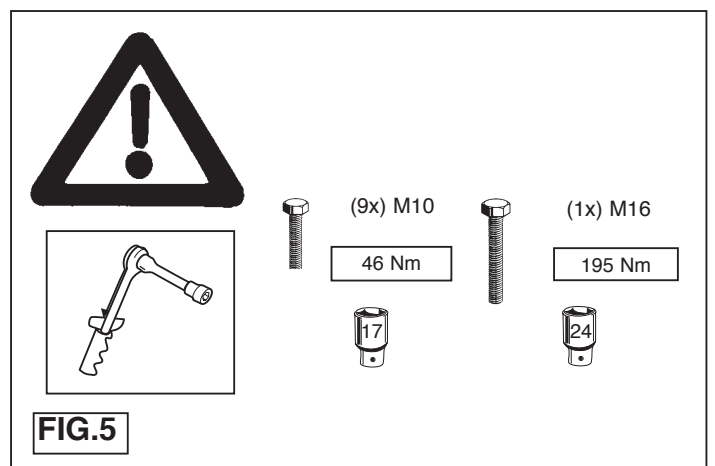
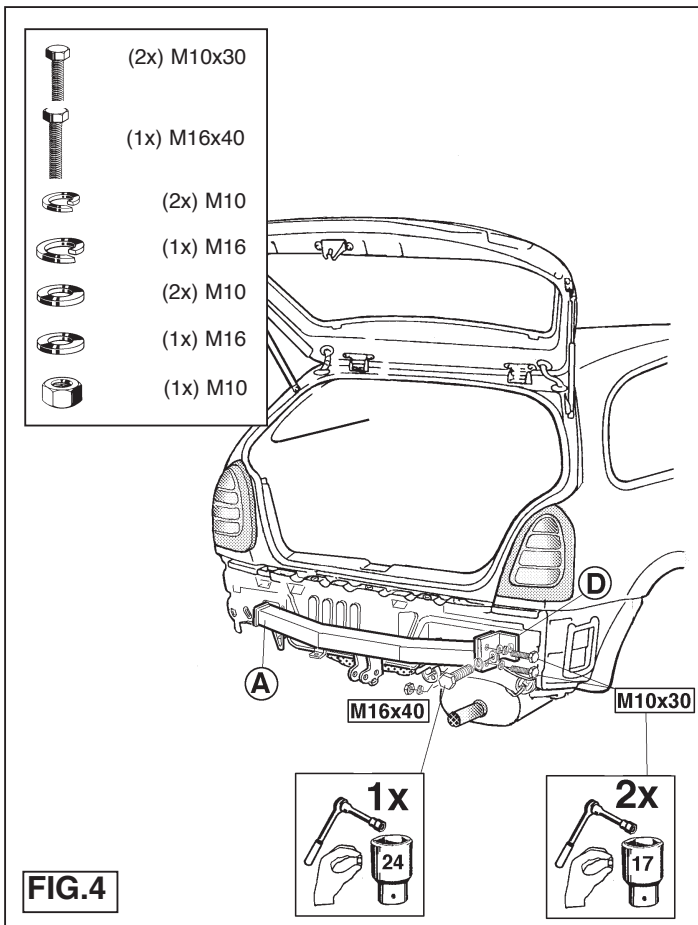

© 2667/08-04-2004/6

Bumper cutout fixed version model year '00
KE500-BM300

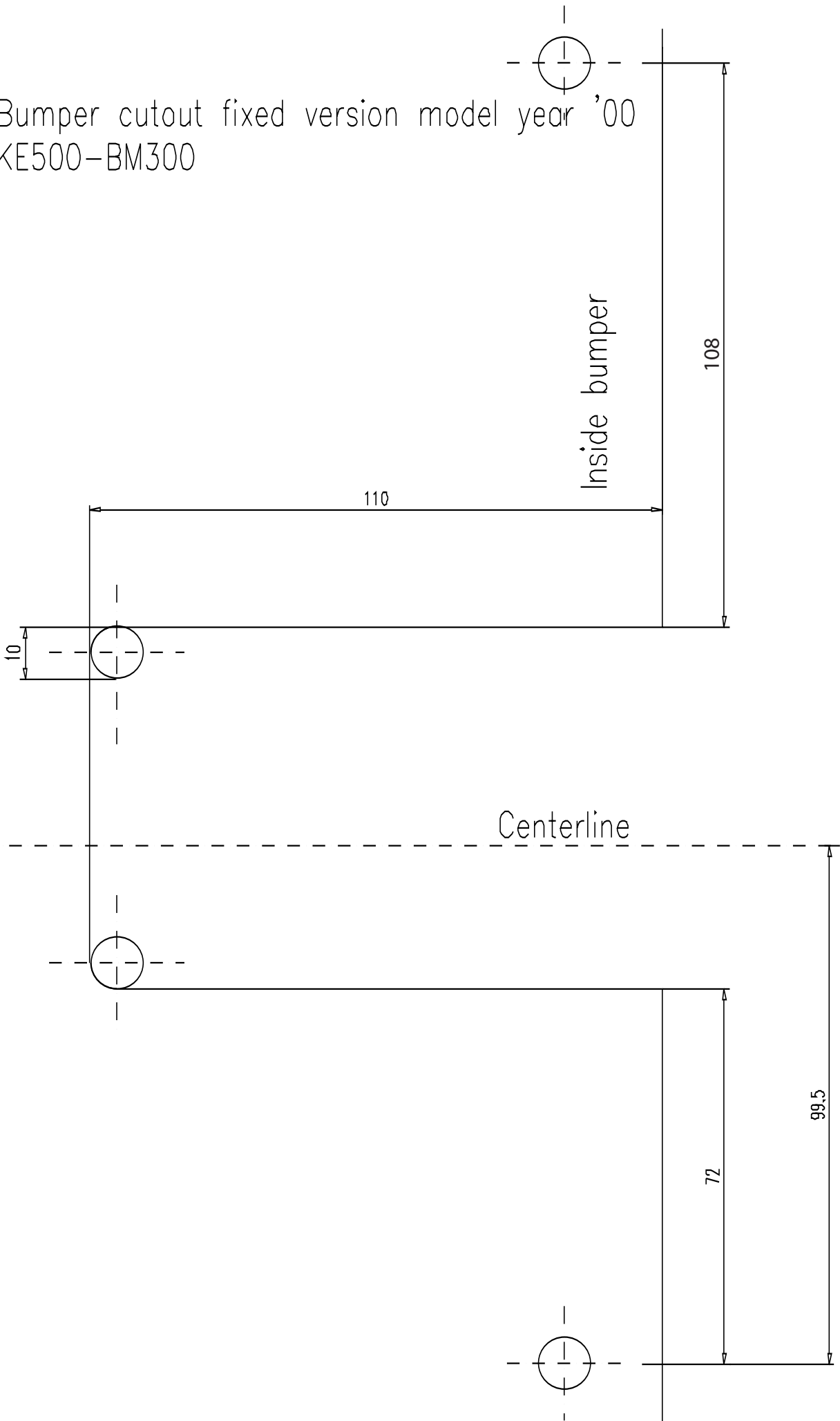

Bumper cutout fixed version model year 2003

KE500-BM300

