

# Kit 1370

VOLVO V70, 5-dr Estate, 04-07  
VOLVO V70, 5-dr Wagon, \*05-10

\*North America

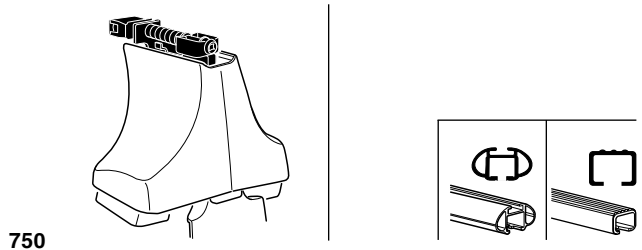
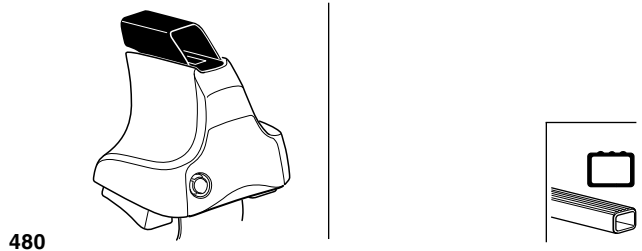
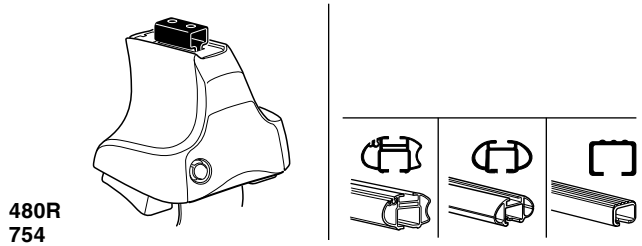

x2 x2 x2 x4	x2	x2 x2 x4 x4	x2 x2	x2	x2

← **696** x 2

← **698** x 2

← **188** x 4

x 1

**Kit**



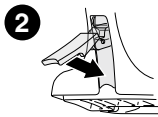
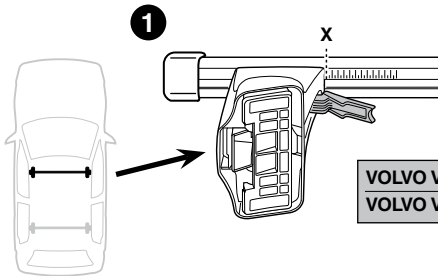
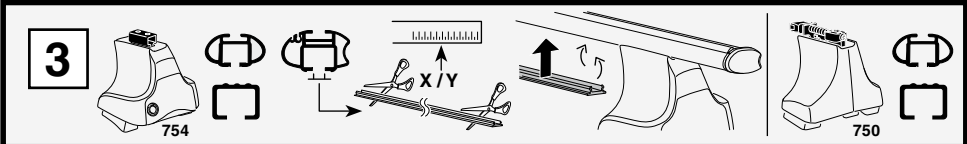

	X
VOLVO V70, 5-dr Estate, 04-07	38
VOLVO V70, 5-dr Wagon, *05-10	38

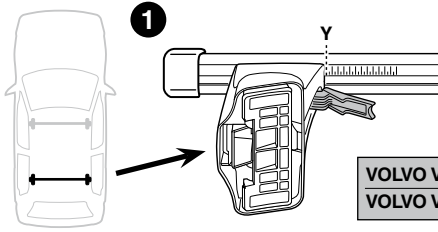

	Y
VOLVO V70, 5-dr Estate, 04-07	35.5
VOLVO V70, 5-dr Wagon, *05-10	35.5

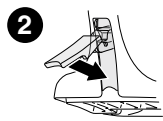
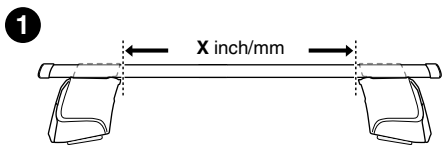
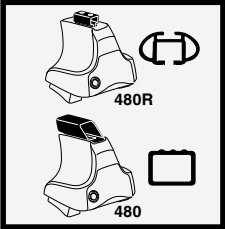

	X inch	X mm
VOLVO V70, 5-dr Estate, 04-07	40 <sup>5</sup> / <sub>8</sub> "	1031 mm
VOLVO V70, 5-dr Wagon, *05-10	40 <sup>5</sup> / <sub>8</sub> "	1031 mm

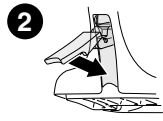
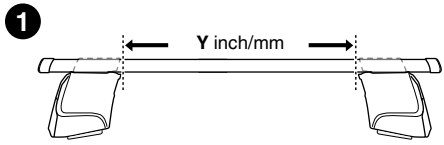
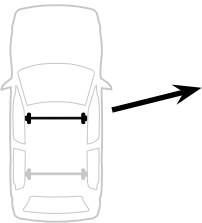

	Y inch	Y mm
VOLVO V70, 5-dr Estate, 04-07	39 <sup>5</sup> / <sub>8</sub> "	1006 mm
VOLVO V70, 5-dr Wagon, *05-10	39 <sup>5</sup> / <sub>8</sub> "	1006 mm

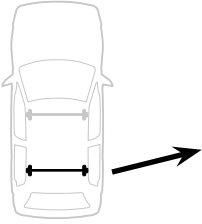

# 4

VOLVO V70, 5-dr Estate, 04-07  
VOLVO V70, 5-dr Wagon, \*05-10

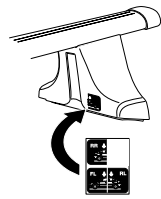
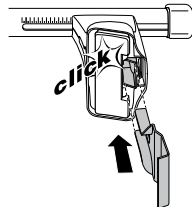
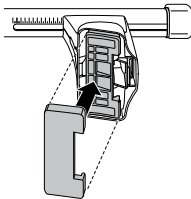
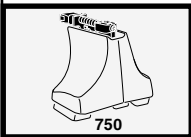
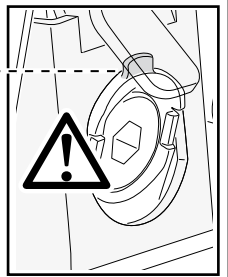
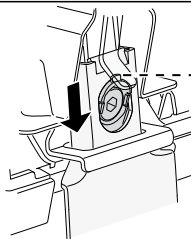
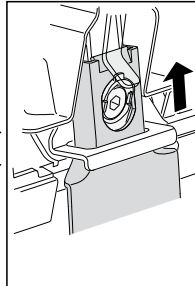
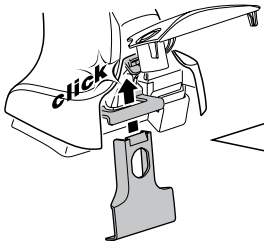
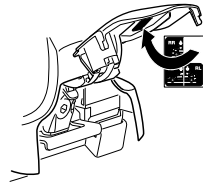
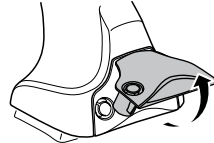
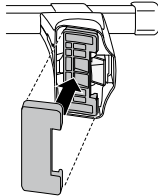
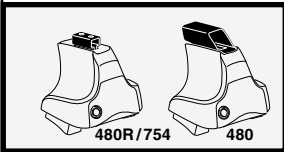
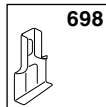
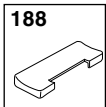
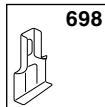
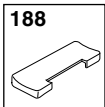
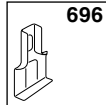
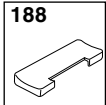
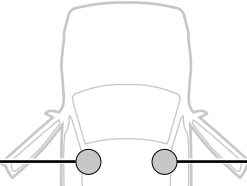
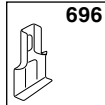
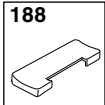

5



	X mm	Y mm	X inch	Y inch
<b>VOLVO V70, 5-dr Estate, 04-07</b>	<b>355 mm</b>	<b>810 mm</b>	<b>14 "</b>	<b>31 7/8 "</b>
<b>VOLVO V70, 5-dr Wagon, *05-10</b>	<b>355 mm</b>	<b>810 mm</b>	<b>14 "</b>	<b>31 7/8 "</b>

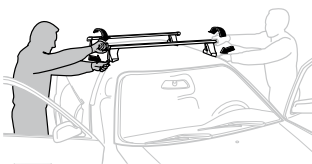
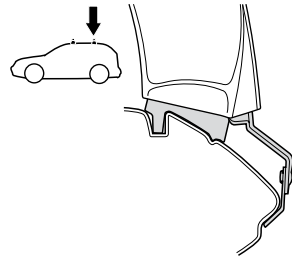
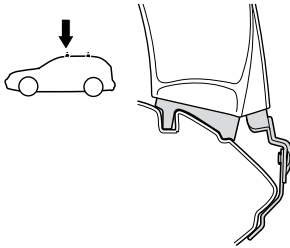
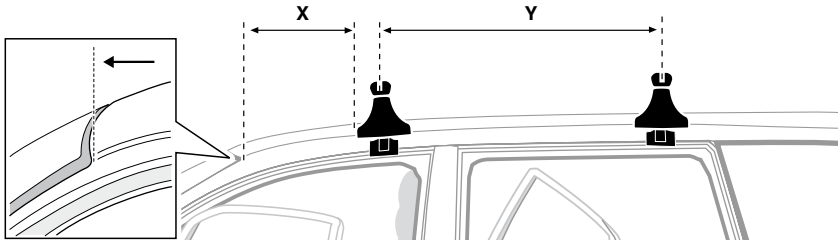

**GB/US** Tighten alternately  
**D** Die Schrauben abwechselnd anziehen  
**F** Serrer alternativement chaque côté  
**NL** Afwisselend aan de linker- en de rechterkant aandraaien  
**I** Alternare il serraggio delle viti  
**E** Apretar alternativamente  
**PT** Aperte alternadamente  
**S** Dra åt växelvis  
**FIN** Kierrä vuorotellen  
**EST** Pinguldage vaheldumisi  
**LAT** Pievelciēt pamišus  
**LIT** Užsukinėkite pakaitomis  
**PL** Śruby dokręcaj naprzemiennie  
**RU** Затягивайте попеременно

**CZ** Pokręťta багаžníka dokręcaj dokręcaj naprzemiennie.  
**SK** Doťahujte striedavo  
**SLO** Privijajte izmenično.  
**HR** Naizmjenično zategnite  
**HU** Egymástól függetlenül szorítandó  
**GR** Σφιγγετε εναλλάξ  
**TR** Dönüşümlü sıkın

**中文** 交替拧紧

**한국어** 번갈아 가며 조이십시오.

**日本語** 交互に締め付けてください。

**ไทย** ขั้ในแบบสลับ

6



480R/754



480

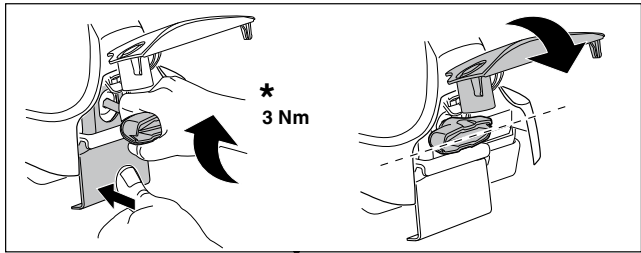

\*  
3 Nm



\*



\*  
≈ 3 Nm

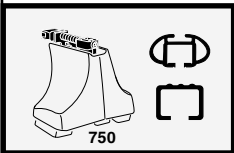

750

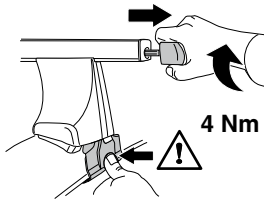

4 Nm

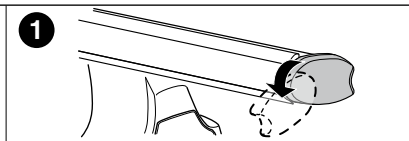
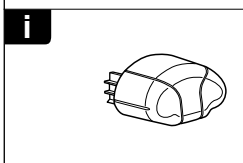
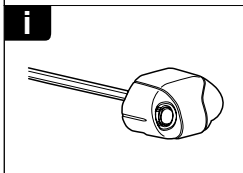
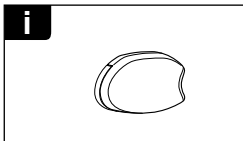
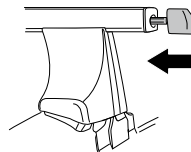

1

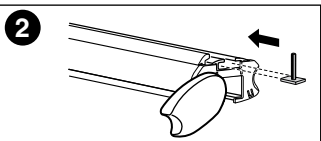

2

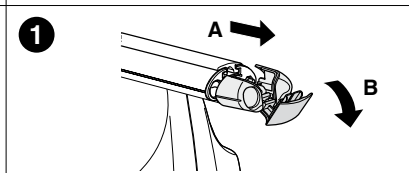

1

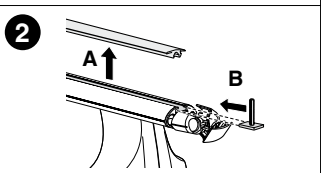

2

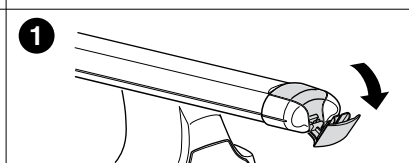

1

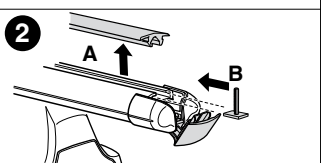

2

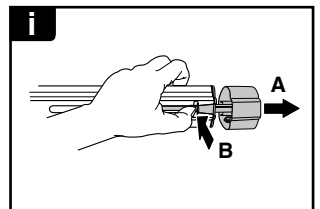
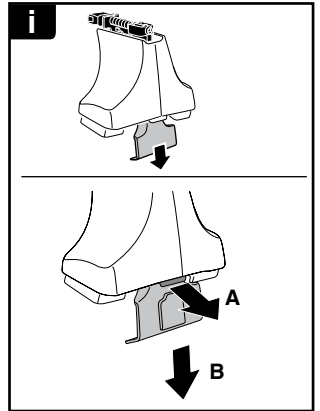

**THULE**  
SWEDEN  
**ONE  
KEY  
SYSTEM**

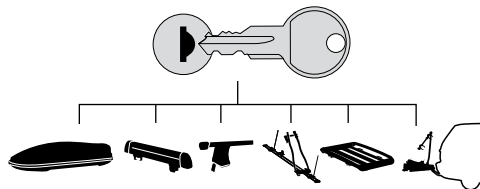

		(x4)
		(x6)
		(x8)
NA		(x10)
EUR		(x12)
ASIA		(x12)

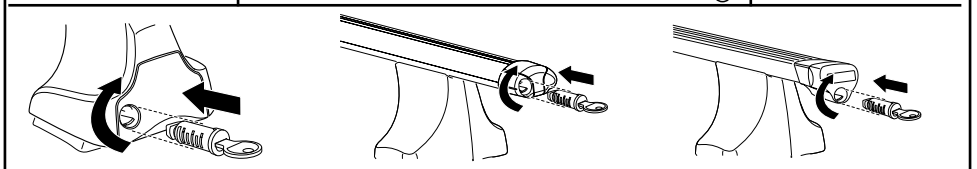

WW ▶ Thule Sweden AB, Box 69, 330 33 Hillerstorp, SWEDEN  
NA ▶ Thule Inc., 42 Silvermine Road, Seymour, Connecticut 06483, USA

info@thule.com  
customer.service@thule.com

www.thule.com