

1

Kit 145222

LAND ROVER Range Rover Evoque, 5-dr SUV, 19-

ISO 11154-E



1 KIT

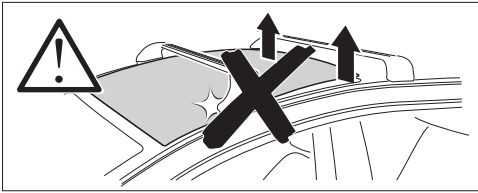
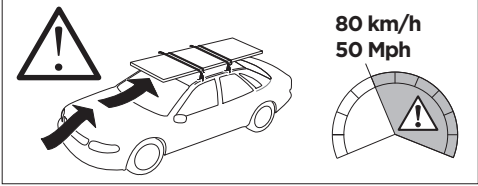
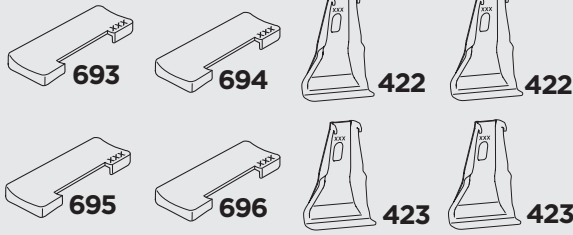
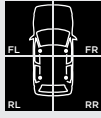

2 FOOT PACK

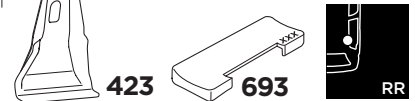
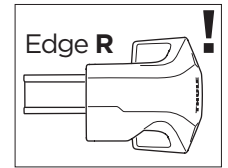
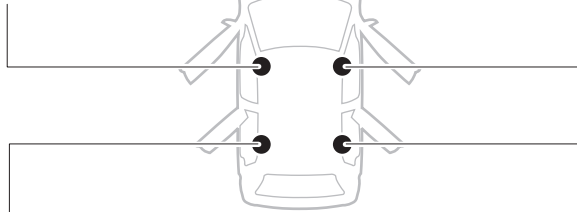
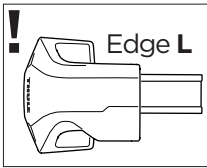
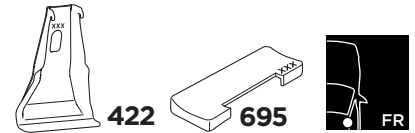

1



x4

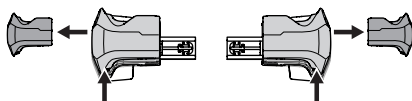

Evo

Edge

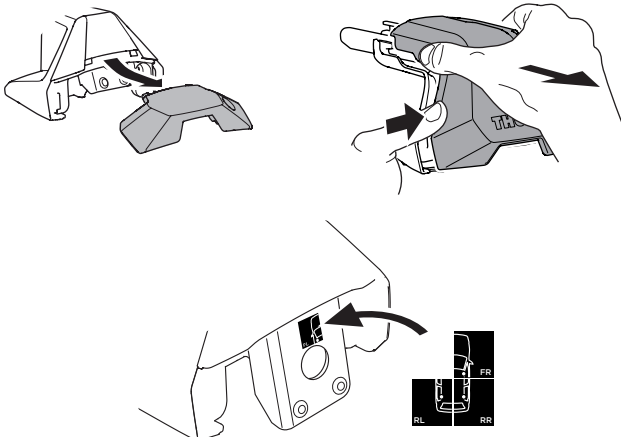

2

x4

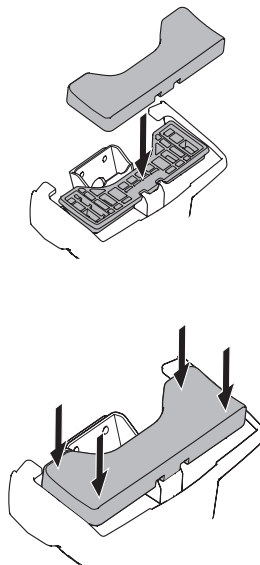

3

x4

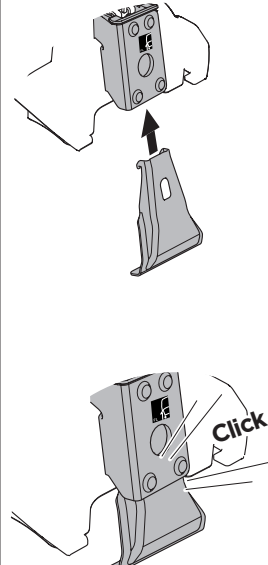



| | | | | | |
|---|--------------------|---------------|---------------------|--------------------------|-----------------------|
| THULE WingBar Evo | THULE WingBar Edge | THULE WingBar | THULE SquareBar Evo | Evo X (scale) | Edge X (scale) |
| LAND ROVER Range Rover Evoque, 5-dr SUV, 19- | | | | 46 | E |
| THULE ProBar Evo | THULE SlideBar Evo | | | | X (mm/inch) |
| LAND ROVER Range Rover Evoque, 5-dr SUV, 19- | | | | 1111 mm / 43 3/4" | |



| | | | | | |
|---|--------------------|---------------|---------------------|--------------------------|-----------------------|
| THULE WingBar Evo | THULE WingBar Edge | THULE WingBar | THULE SquareBar Evo | Evo Y (scale) | Edge Y (scale) |
| LAND ROVER Range Rover Evoque, 5-dr SUV, 19- | | | | 43,5 | J |
| THULE ProBar Evo | THULE SlideBar Evo | | | | Y (mm/inch) |
| LAND ROVER Range Rover Evoque, 5-dr SUV, 19- | | | | 1086 mm / 42 3/4" | |

| | | |
|---|---------------------|-------------------------|
| | W (mm/inch) | Z (mm/inch) |
| LAND ROVER Range Rover Evoque, 5-dr SUV, 19- | 710 mm / 28" | 310 mm / 12 1/4" |

