

# Kit 1465

**HONDA City**, 4-dr Sedan, 09–  
**HONDA Fit**, 5-dr Hatchback, 08– / \*09–  
**HONDA Jazz**, 5-dr Hatchback, 08–

\*North America

480R  
754

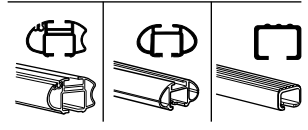
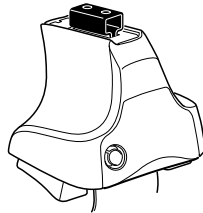

480

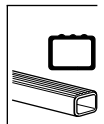
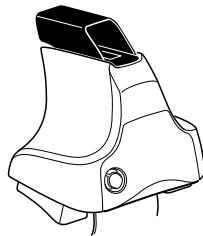

750

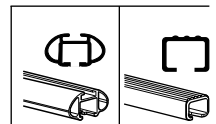
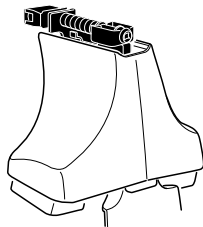

**Max.  
40 kg**  
**Max.  
88 lbs**

x2 x2 x2 x4	x2	x2 x2 x4 x4	x2 x2	x2

**1022** x 4

**06** x 2

**278** x 2

**x 1**

**Kit**



3

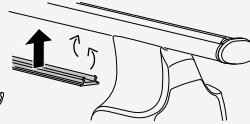
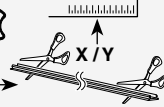

1

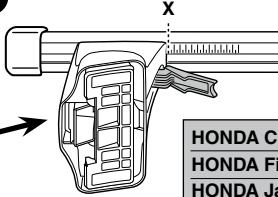
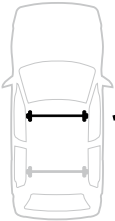

2

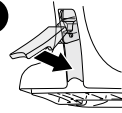

	X
HONDA City, 4-dr Sedan, 09–	33,5
HONDA Fit, 5-dr Hatchback, 08– / *09–	30
HONDA Jazz, 5-dr Hatchback, 08–	30

1

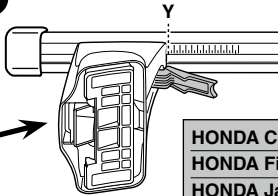

2

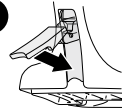

	Y
HONDA City, 4-dr Sedan, 09–	30,5
HONDA Fit, 5-dr Hatchback, 08– / *09–	25,5
HONDA Jazz, 5-dr Hatchback, 08–	25,5



480R



480

1

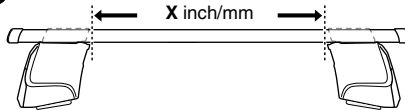

2

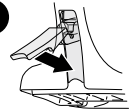

	X inch	X mm
HONDA City, 4-dr Sedan, 09–	38 <sup>7</sup> / <sub>8</sub> "	986 mm
HONDA Fit, 5-dr Hatchback, 08– / *09–	37 <sup>1</sup> / <sub>4</sub> "	951 mm
HONDA Jazz, 5-dr Hatchback, 08–	37 <sup>1</sup> / <sub>4</sub> "	951 mm

1

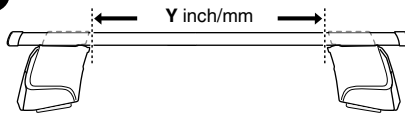

2

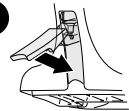

	Y inch	Y mm
HONDA City, 4-dr Sedan, 09–	37 <sup>5</sup> / <sub>8</sub> "	956 mm
HONDA Fit, 5-dr Hatchback, 08– / *09–	35 <sup>5</sup> / <sub>8</sub> "	906 mm
HONDA Jazz, 5-dr Hatchback, 08–	35 <sup>5</sup> / <sub>8</sub> "	906 mm

# 4

HONDA City, 4-dr Sedan, 09–  
HONDA Fit, 5-dr Hatchback, 08– / \*09–  
HONDA Jazz, 5-dr Hatchback, 08–

278



1022



278



1022



06



1022



06



1022

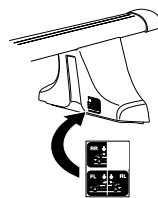
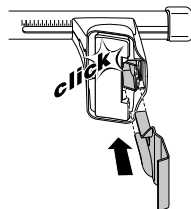
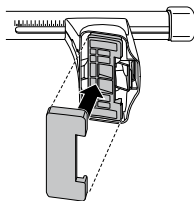
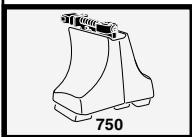
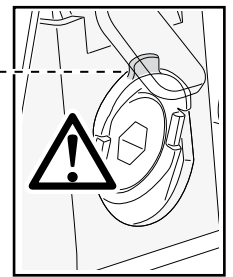
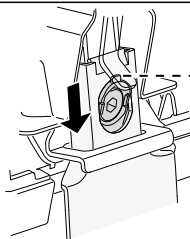
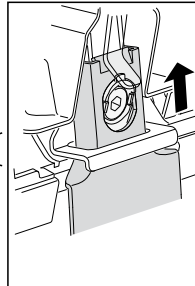
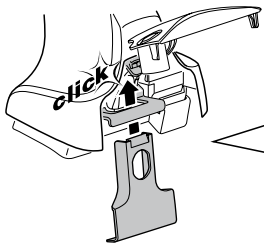
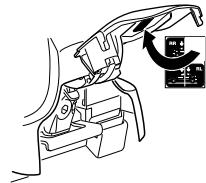
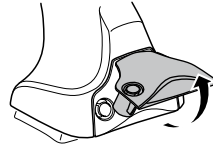
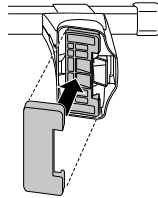
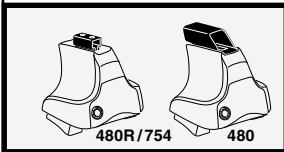

5



	X mm	Y mm	X inch	Y inch
HONDA City, 4-dr Sedan, 09-	180 mm	700 mm	7 1/8"	27 1/2"
HONDA Fit, 5-dr Hatchback, 08- / *09-	310 mm	750 mm	12 1/4"	29 1/4"
HONDA Jazz, 5-dr Hatchback, 08-	310 mm	750 mm	12 1/4"	29 1/4"

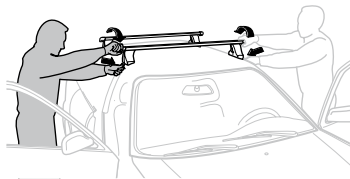
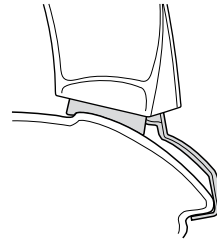
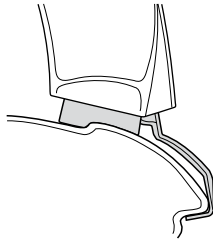
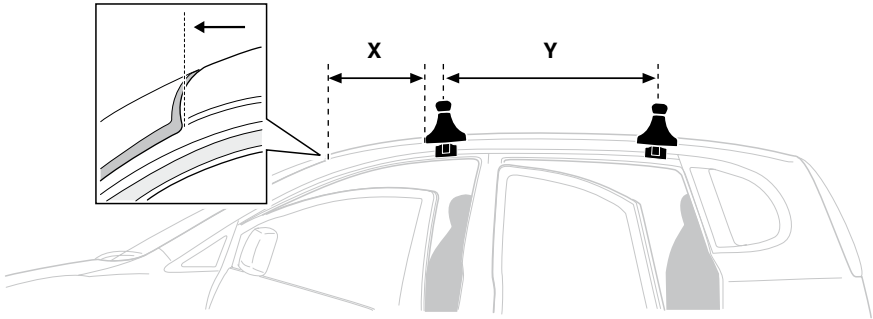

**GB/US** Tighten alternately

**D** Die Schrauben abwechselnd anziehen

**F** Serrer alternativement chaque côté

**NL** Afwisselend aan de linker- en de rechterkant aandraaien

**I** Alternare il serraggio delle viti

**E** Serrare alternativamente

**PT** Aperte alternadamente

**S** Dra åt växelvis

**FIN** Kierrä vuorotellen

**EST** Pinguldage vaheldumisi

**LAT** Pielieciet pamišus

**LIT** Užsukinėkite pakaitomis

**PL** Śruby dokręcaj naprzemiennie

**RU** Затягивайте попеременно

**CZ** Pokręťta bagażníka dokręcaj dokręcaj naprzemiennie.

**SK** Doťahujte striedavo

**SLO** Privijajte izmenično.

**HR** Naizmjenično zategnite

**HU** Egymástól függetlenül szorítandó

**GR** Σφιγγετε εναλλάξ

**TR** Dönüşümlü sıkın

**中文** 交替拧紧

**한국어** 번갈아 가며 조이십시오.

**日本語** 交互に締め付けてください。

**ไทย** ชั้้นในแบบสลับ

6



480R/754



480

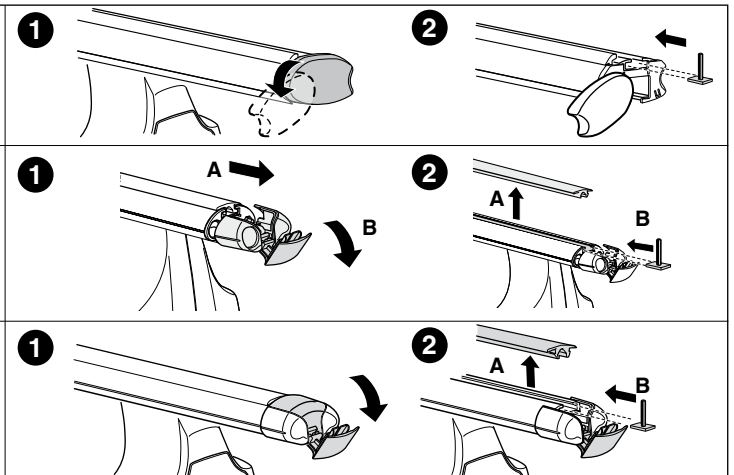
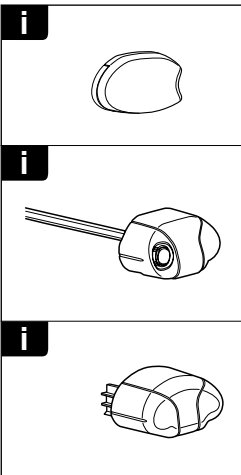
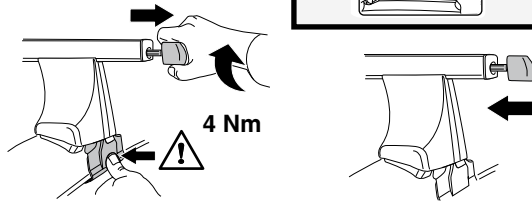
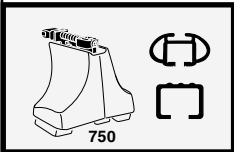
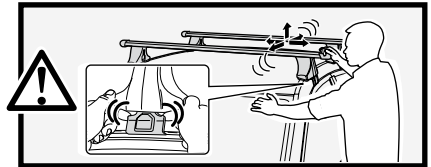
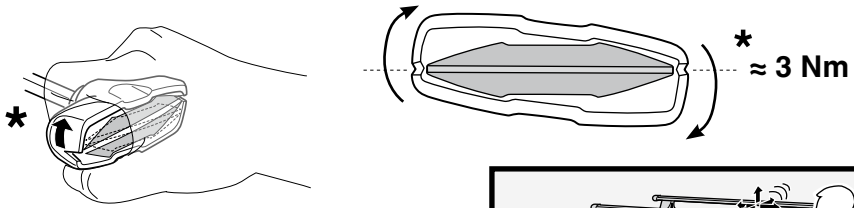
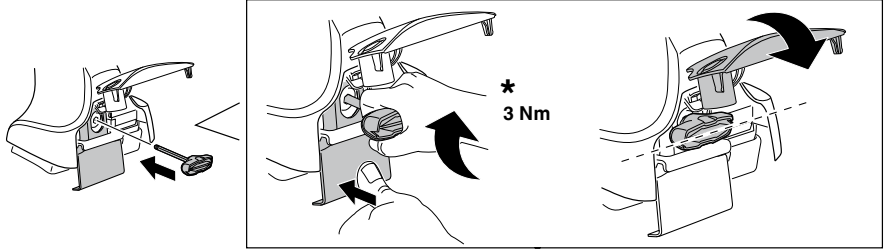



**THULE**  
SWEDEN  
**ONE  
KEY  
SYSTEM**



		<b>544</b>	(x4)
		<b>596</b>	(x6)
		<b>588</b>	(x8)
NA		<b>510</b>	(x10)
EUR		<b>452</b>	(x12)
ASIA			



WW ▶ Thule Sweden AB, Box 69, 330 33 Hillerstorp, SWEDEN  
NA ▶ Thule Inc., 42 Silvermine Road, Seymour, Connecticut 06483, USA

info@thule.com  
customer.service@thule.com

www.thule.com

503-1465-03