

Kit 1157

INFINITI i30, 4-dr Sedan, *00-01

INFINITI i35, 4-dr Sedan, *02-05

NISSAN Cefiro, 4-dr Sedan, 99-03

NISSAN Maxima, 4-dr Sedan, 00-03

*North America

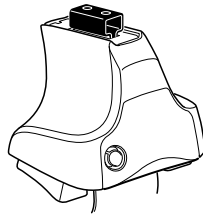

754 Rapid System
480R Rapid Traverse (North America)

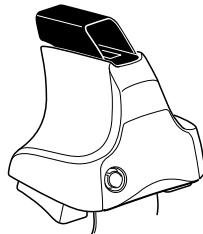
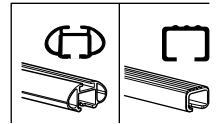

480 Traverse (North America)

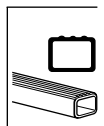

1

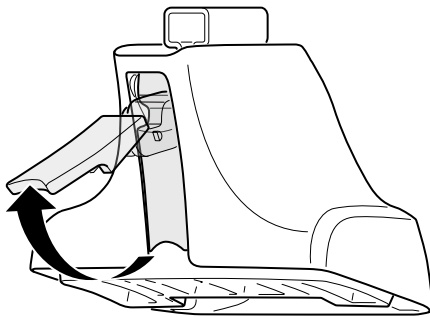

2



754 Rapid System
480R Rapid Traverse
(North America)

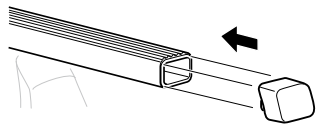
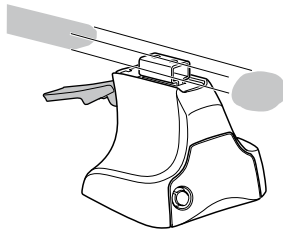

x4

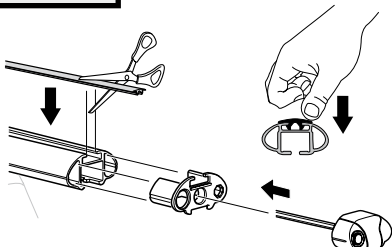
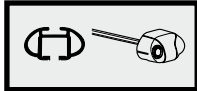

x4

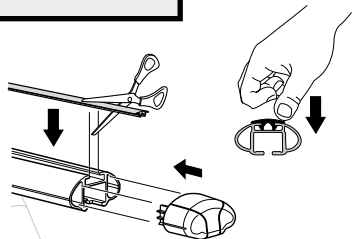
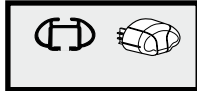

x4

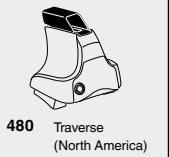

480 Traverse
(North America)

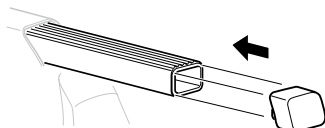
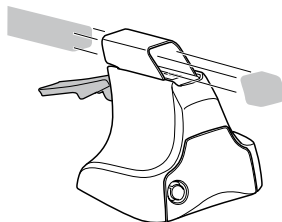

x4

3

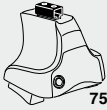

754 Rapid System

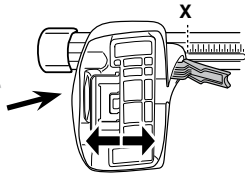

	X
INFINITI i30 , 4-dr Sedan, *00-01	32,5
INFINITI i35 , 4-dr Sedan, *02-05	32,5
NISSAN Cefiro , 4-dr Sedan, 99-03	32,5
NISSAN Maxima , 4-dr Sedan, 00-03	32,5

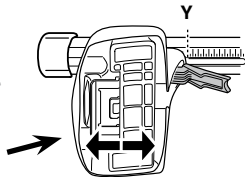

	Y
INFINITI i30 , 4-dr Sedan, *00-01	30,5
INFINITI i35 , 4-dr Sedan, *02-05	30,5
NISSAN Cefiro , 4-dr Sedan, 99-03	30,5
NISSAN Maxima , 4-dr Sedan, 00-03	30,5

3



480R Rapid Traverse



480 Traverse



(North America)

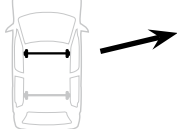

	X inch	X mm
INFINITI i30 , 4-dr Sedan, *00-01	38 ³/₈ "	976 mm
INFINITI i35 , 4-dr Sedan, *02-05	38 ³/₈ "	976 mm
NISSAN Cefiro , 4-dr Sedan, 99-03	38 ³/₈ "	976 mm
NISSAN Maxima , 4-dr Sedan, 00-03	38 ³/₈ "	976 mm

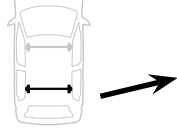

	Y inch	Y mm
INFINITI i30 , 4-dr Sedan, *00-01	37 ⁵/₈ "	956 mm
INFINITI i35 , 4-dr Sedan, *02-05	37 ⁵/₈ "	956 mm
NISSAN Cefiro , 4-dr Sedan, 99-03	37 ⁵/₈ "	956 mm
NISSAN Maxima , 4-dr Sedan, 00-03	37 ⁵/₈ "	956 mm

4

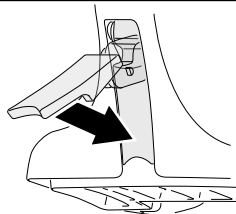

5

INFINITI i30, 4-dr Sedan, *00-01

INFINITI i35, 4-dr Sedan, *02-05

NISSAN Cefiro, 4-dr Sedan, 99-03

NISSAN Maxima, 4-dr Sedan, 00-03

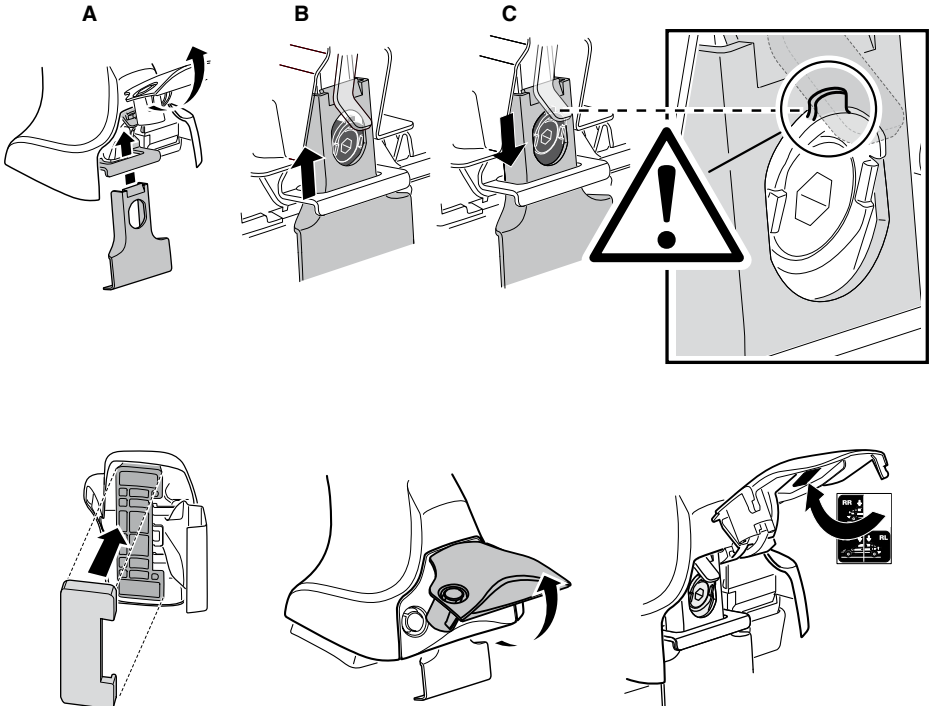
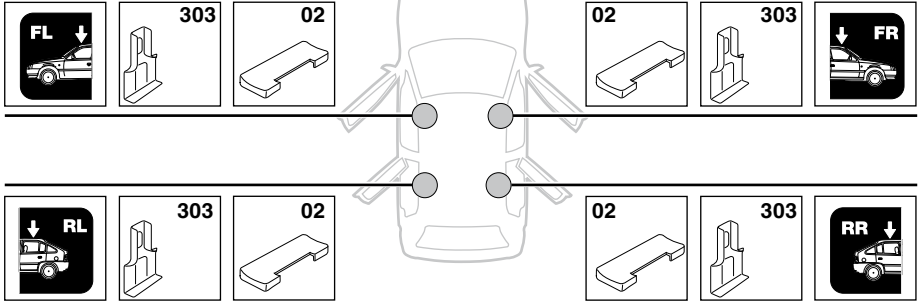

6

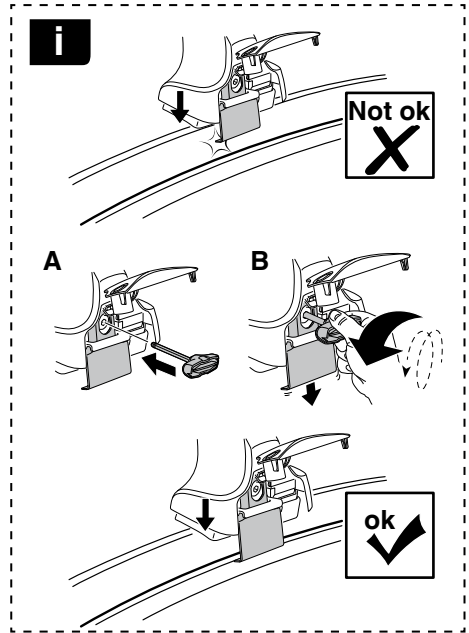
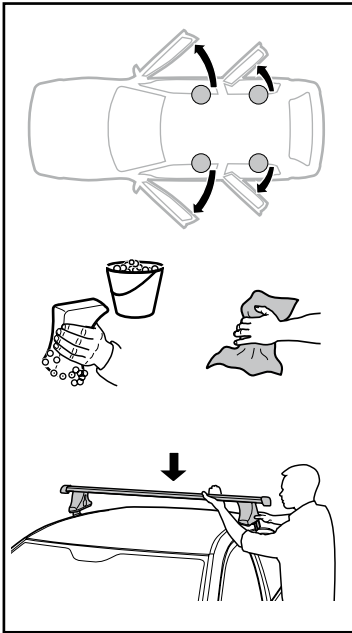

	X mm	Y mm	X inch	Y inch
INFINITI i30, 4-dr Sedan, *00-01	230 mm	650 mm	9"	25 5/8"
INFINITI i35, 4-dr Sedan, *02-05	230 mm	650 mm	9"	25 5/8"
NISSAN Cefiro, 4-dr Sedan, 99-03	230 mm	650 mm	9"	25 5/8"
NISSAN Maxima, 4-dr Sedan, 00-03	230 mm	650 mm	9"	25 5/8"

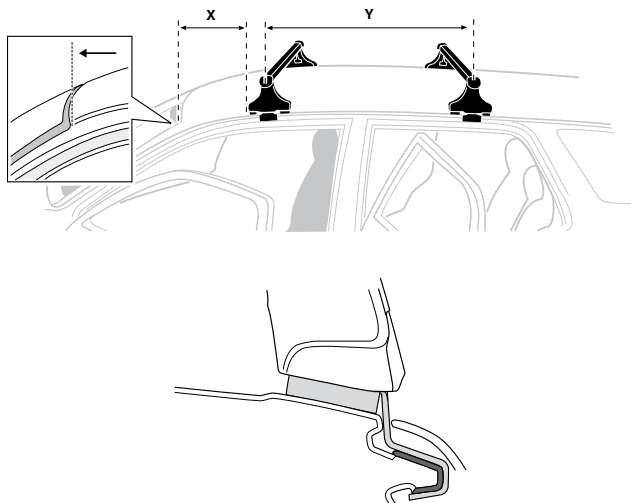

7

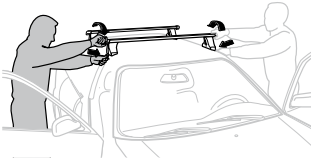

GB/US Tighten alternately
D Die Schrauben abwechselnd anziehen
F Serrer alternativement chaque côté
NL Afwisselend aan de linker- en de rechterkant aandraaien
I Alternare il serraggio delle viti
E Apertar alternativamente
PT Aperte alternadamente
S Dra åt växelvis
FIN Kierrä vuorotellen
EST Pinguldage vaheldumisi
LAT Pievelciēt pamišus
LIT Užsukinėkite pakaitomis
PL Śruby dokręcaj naprzemiennie
RU Затягивайте попеременно

CZ Pokrétla bagazníka dokręcaj dokręcaj naprzemiennie.
SK Doťahujte striedavo
SLO Privijajte izmenično.
HR Naizmjenično zategnite
HU Egymástól függetlenül szorítandó
GR Σφιγγεται εναλλάξ
TR Dönüşümlü sıkın

中文 交替拧紧

한국어 번갈아 가며 조이십시오.

日本語 交互に締め付けてください。

ไทย ชั้ในแบบสลับ

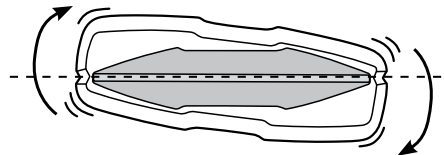
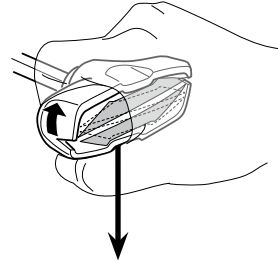
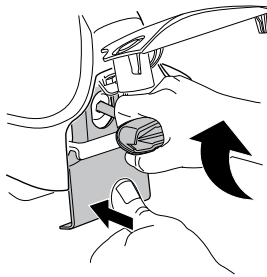
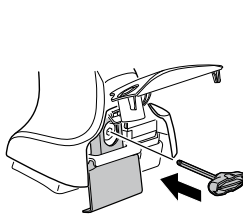

≈ 3 Nm

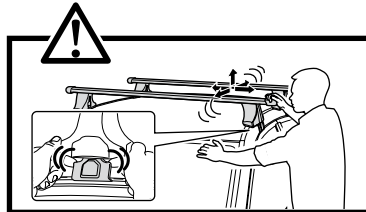
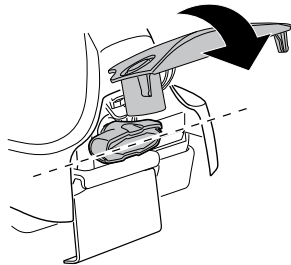

8





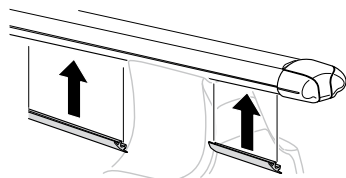

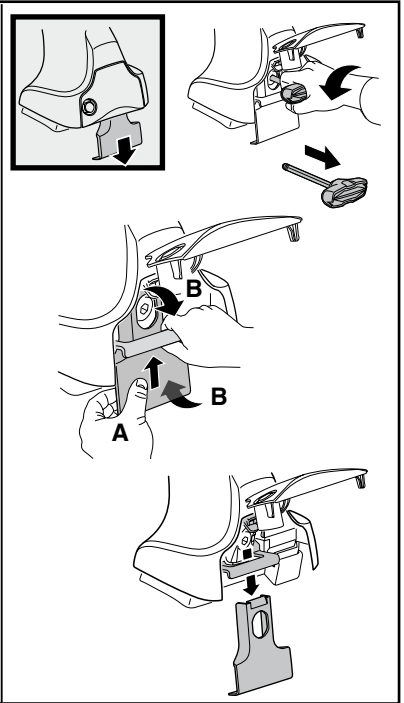
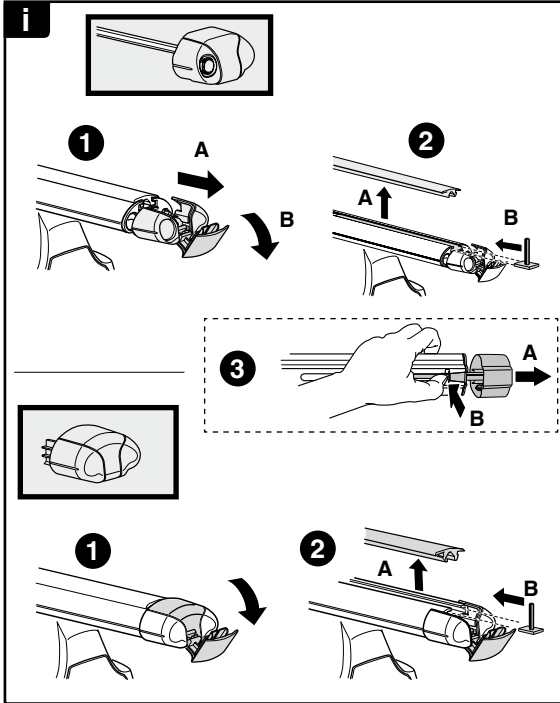
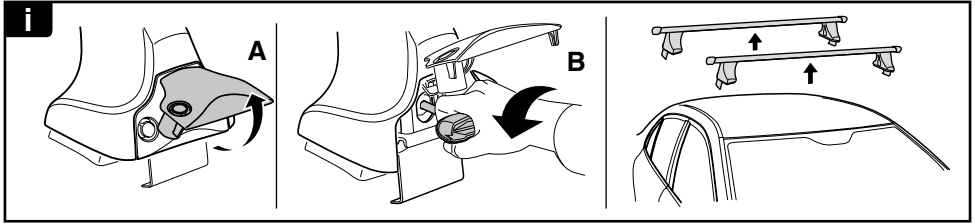
x1
17 mm



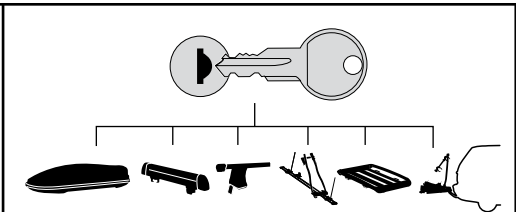

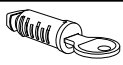
THULE
SWEDEN
**ONE
KEY
SYSTEM**



-  **544** (x4)
 -  **596** (x6)
 -  **588** (x8)
 -  **510** (x10)
 -  **452** (x12)
- NA
EUR
ASIA

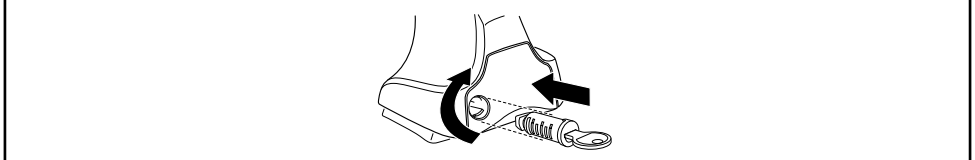

WW ▶ Thule Sweden AB, Box 69, 330 33 Hillerstorp, SWEDEN
NA ▶ Thule Inc., 42 Silvermine Road, Seymour, Connecticut 06483, USA

info@thule.com
customer.service@thule.com

 www.thule.com