

Kit 1313

CITROËN C8, 5-dr MPV, 03-
FIAT Ulysse, 5-dr MPV, 03-
LANCIA Phedra, 5-dr MPV, 03-
PEUGEOT 807, 5-dr MPV, 03-

480R
754

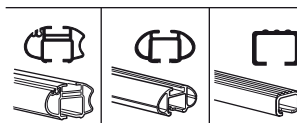
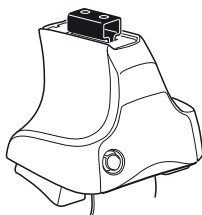

480

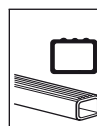
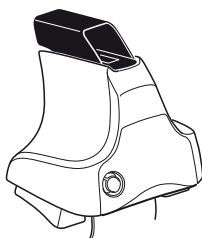

750

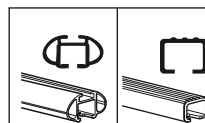
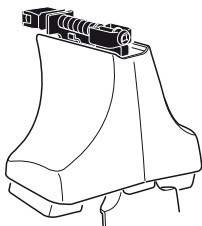

THULE[®]
SWEDEN

xx kg
 xx lbs + 7 kg
 15,4 lbs = **Max. 60kg**
Max. 132 lbs

80 km/h 130 km/h
 50 Mph 80 Mph
 40 km/h 25 Mph
km/h Mph

THULE + **Kit XXXX**

x1 x4 x4 x4

480R/754

x1 x4 x4 x4

480

x1 x4 x4

750

x2	x2	x2	x2	x2
x2	x2	x2	x2	x2
x2	x2	x4	x2	x2
x4		x4		

544 x 2

542 x 2

150 x 2

138 x 2

x 1

Kit



3



754

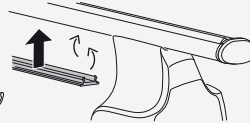
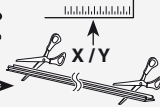

750

1

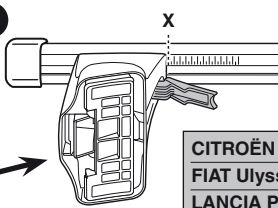
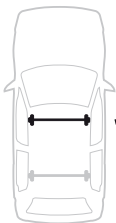

2

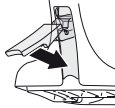

	X
CITROËN C8, 5-dr MPV, 03-	50
FIAT Ulysse, 5-dr MPV, 03-	50
LANCIA Phedra, 5-dr MPV, 03-	50
PEUGEOT 807, 5-dr MPV, 03-	50

1

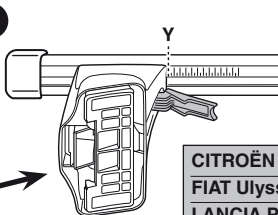

2



	Y
CITROËN C8, 5-dr MPV, 03-	39
FIAT Ulysse, 5-dr MPV, 03-	39
LANCIA Phedra, 5-dr MPV, 03-	39
PEUGEOT 807, 5-dr MPV, 03-	39



480R



480

1

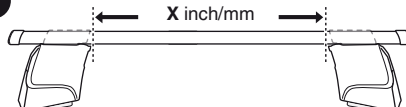

2



	X inch	X mm
CITROËN C8, 5-dr MPV, 03-	45 ³ / ₈ "	1151 mm
FIAT Ulysse, 5-dr MPV, 03-	45 ³ / ₈ "	1151 mm
LANCIA Phedra, 5-dr MPV, 03-	45 ³ / ₈ "	1151 mm
PEUGEOT 807, 5-dr MPV, 03-	45 ³ / ₈ "	1151 mm

1

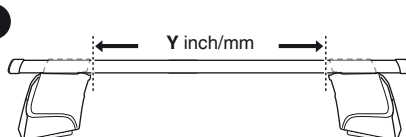

2



	Y inch	Y mm
CITROËN C8, 5-dr MPV, 03-	41 "	1041 mm
FIAT Ulysse, 5-dr MPV, 03-	41 "	1041 mm
LANCIA Phedra, 5-dr MPV, 03-	41 "	1041 mm
PEUGEOT 807, 5-dr MPV, 03-	41 "	1041 mm

4

CITROËN C8, 5-dr MPV, 03-
FIAT Ulysse, 5-dr MPV, 03-
LANCIA Phedra, 5-dr MPV, 03-
PEUGEOT 807, 5-dr MPV, 03-

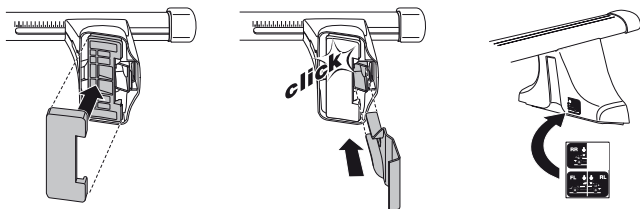
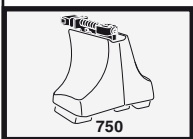
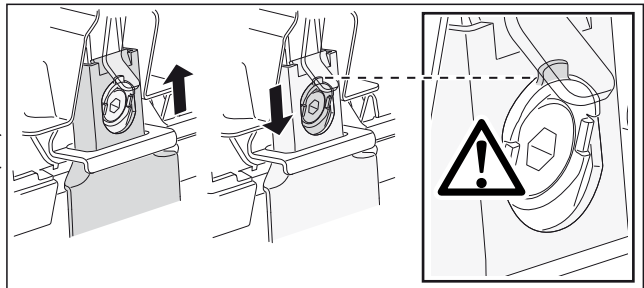
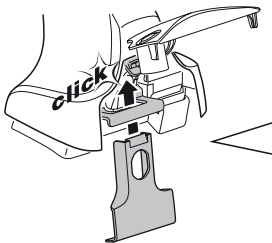
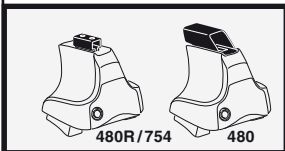
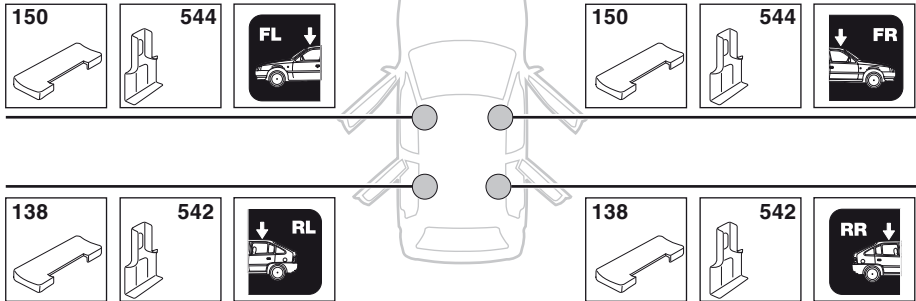

5

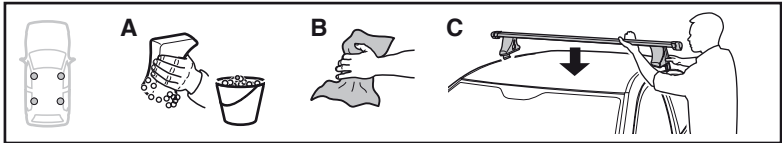

	X mm	Y mm	X inch	Y inch
CITROËN C8, 5-dr MPV, 03-	385 mm	750 mm	15 1/8"	29 1/2"
FIAT Ulysse, 5-dr MPV, 03-	385 mm	750 mm	15 1/8"	29 1/2"
LANCIA Phedra, 5-dr MPV, 03-	385 mm	750 mm	15 1/8"	29 1/2"
PEUGEOT 807, 5-dr MPV, 03-	385 mm	750 mm	15 1/8"	29 1/2"

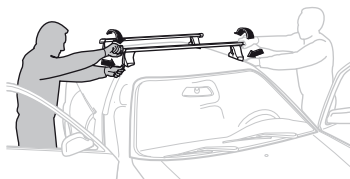
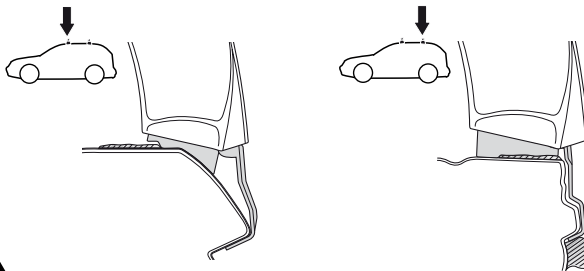
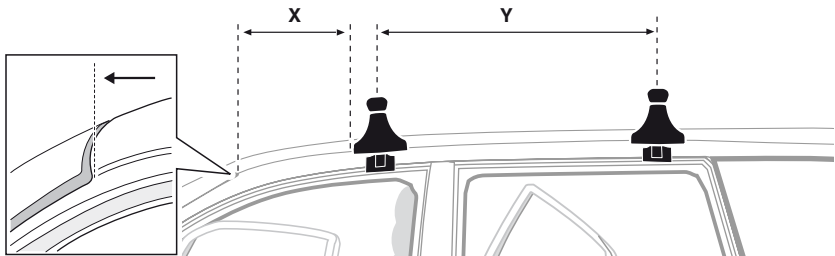

GB/US Tighten alternately

D Die Schrauben abwechselnd anziehen

F Serrer alternativement chaque côté

NL Afwisselend aan de linker- en de rechterkant aandraaien

I Alternare il serraggio delle viti

E Serrare alternativamente

PT Aperte alternadamente

S Dra åt växelvis

FIN Kierrä vuorotellen

EST Pinguldage vaheldumisi

LAT Pielieciet pamišus

LIT Užsukinėkite pakaitomis

PL Śruby dokręcaj naprzemiennie

RU Затягивайте попеременно

CZ Pokręťta багаžníka dokręcaj dokręcaj naprzemiennie.

SK Doťahujte striedavo

SLO Privijajte izmenično.

HR Naizmjenično zategnite

HU Egymástól függetlenül szorítandó

GR Σφιγγετε εναλλάξ

TR Dönüşümlü sıkın

中文 交替拧紧

한국어 번갈아 가며 조이십시오.

日本語 交互に締め付けてください。

ไทย ชันโนแบบสลับ

6



480R/754



480

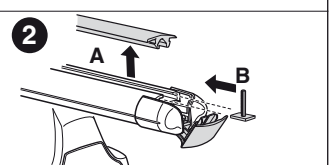
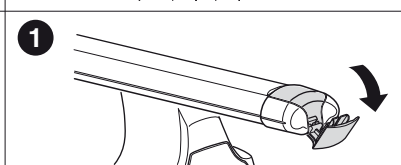
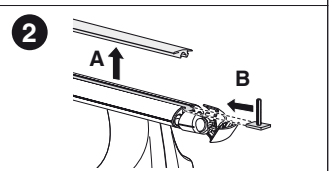
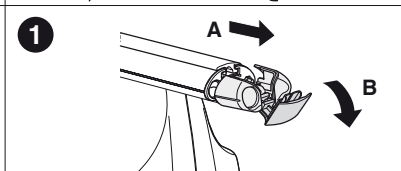
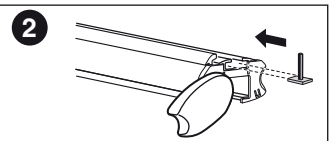
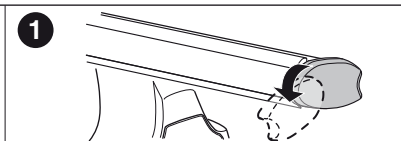
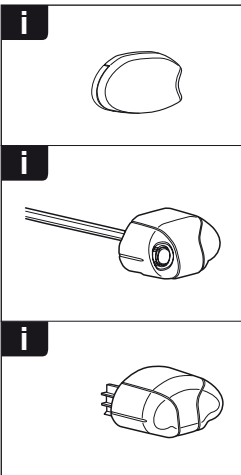
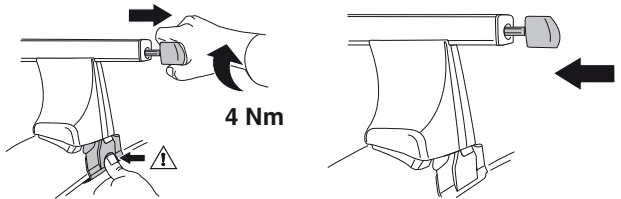
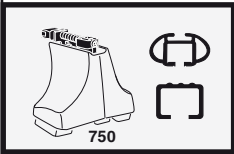

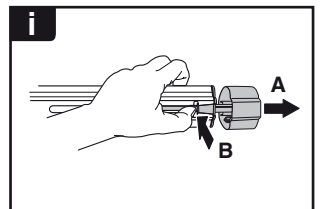
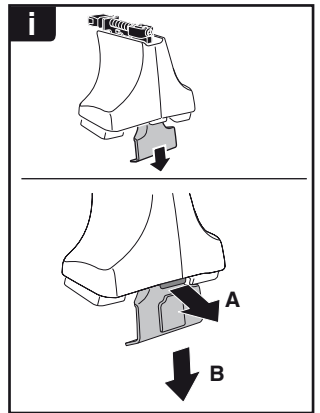
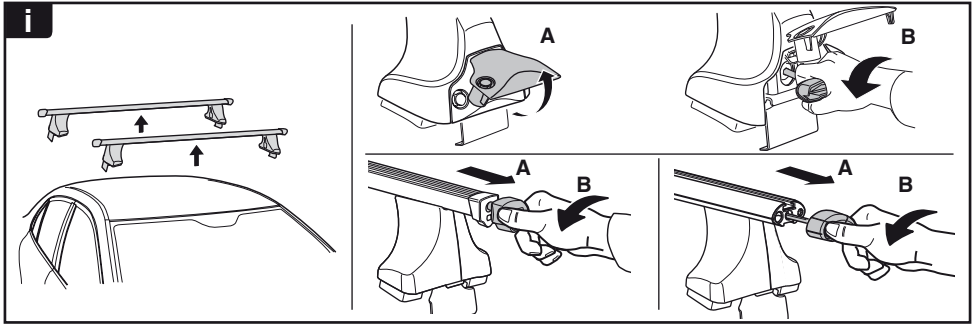

THULE
SWEDEN
**ONE
KEY
SYSTEM**



- 544 (x4)
- 596 (x6)
- 588 (x8)
- NA 510 (x10)
- EUR 452 (x12)
- ASIA



WW ▶ Thule Sweden AB, Box 69, 330 33 Hillerstorp, SWEDEN
 NA ▶ Thule Inc., 42 Silvermine Road, Seymour, Connecticut 06483, USA

info@thule.com
 customer.service@thule.com

www.thule.com